

**LEGEND**

- ROADS AND ROADWAY FEATURES**
- Primitive Road (Type A)
  - Unimproved Road (Type B)
  - Graded and Drained Road (Type C)
  - State Surface Road (Type D)
  - Gravel or Stone Road
  - Gravel or Drained (Type E-1)
  - Gravel or Stone Road With Stabilized Surface (Type E-2)
  - Bituminous Road-Low Type (Type F, G-1, H-1)
  - Paved Road (Type G-2, H-2, J, K, L)
  - Divided Highway
  - Highway With Full Control of Access
  - State Roads and Streets in Unincorporated Urban Compacts and Extensions of Local Roads Within Municipalities & Like Unincorporated Highway
  - Projected Road
- Road System Designation**
- Federal-Aid Interstate Highway System
  - Federal-Aid Primary Highway System
  - Federal-Aid Secondary Highway System
  - Federal-Aid Urban Highway System
  - Points Between Which Distances are Measured
  - Interstate Numbered Highway
  - U. S. Numbered Highway
  - State Highway System or State Numbered Highway
  - End of Designated System or Marked Route
- RAILROADS**
- Railroad (Any Number of Tracks Used by a Single Operating Company or by Trains of Another Carrier Under Trackage Rights)
  - Railroads in Jurisdiction Two or More Tracks of Separately Operated Companies on Abandoned Rights-of-Way
  - Abandoned Railroads (Track Retained)
  - Railroad Station
- Railroad Crossing**
- Grade Crossing
  - Railroad Above
  - Railroad Below
  - Railroad Bridge
- AIRWAYS AND AIRPORTS**
- Military Field (Some Facilities Available)
  - Airport Complete Facilities (Commercial or Municipal)
  - Airfield, Limited Facilities
  - Landing Area or Strip (Including Private Air Fields)
  - Airway Light Beacon, General
  - Airport, General
- NAVIGATION**
- Navigable Stream (No intermittent navigation)
- DRAINAGE**
- Intermittent Stream (Narrow)
  - Intermittent Stream (Wide)
  - Narrow Stream
  - Wide Stream
  - Drainage Ditch
  - Irrigation Ditch
  - Lake, Reservoir, or Pond With Dam
  - Dry Lake Subject to Flood
  - Marsh or Swamp Land
  - Overflow Land
- STRUCTURES**
- Highway Bridge, General (Total Span Greater Than 20 Feet)
  - Small Bridges Closely Spaced
- Bridges For Long River Crossings**
- Acin
  - Truss or Girder (w. wood & steel)
  - Cantilever Bridge
  - Highway Grade Separation
- Miscellaneous Structures**
- Levee Or Dam
  - Levee Or Dam With Road
  - Concrete Ford Or Dip
  - Ford Road Established
  - Cattle Guard
  - Gate Across Road (Any Type)
- CITY AND VILLAGE CENTERS**
- State Capital
  - County Seat
  - Other Cities and Villages
  - Incorporated City or Village
  - Boundary Lines Fixed for Special Taxing Areas and Other Unincorporated Urban Places Defined
- NATURAL FEATURES**
- Prominent Elevation—With Name (Numerals Indicate Elevation Above Sea Level)
  - Sea or Depression
- CONSERVATION AND RECREATION**
- Picnic Ground
  - Playground, Ball Field, Etc.
  - Bathing Beach or Swimming Pool
  - Dance Site
  - Camp Site, No Permanence (Tents or Trailer Parking)
  - Tourist Court or Motel (Figure Indicates Number of Permanent Cabins or Cottages)
  - Camp or Lodge (Permanent Site With Building)
  - Small Park (SP—State, CP—County, MP—Municipal, SR—Safety Rest Area)
  - Farm Tractory
  - Best Barquial
  - Dance Farm
  - Game Preserve
  - State Club
  - Golf Ground or Country Club
  - Hunting Academy
  - Fish Club
  - Amusement Park or Hall
  - Fair Ground, Race Course, Speedway
  - Drive-In Theatre
  - Mama
  - Rodeo Grounds
  - State House or Gate House (Add Letters N or S to Indicate National or State Park)
- FARM UNITS, DWELLINGS, ETC.**
- Farm Unit
  - Dwelling (Other Than Farm)
  - Roads or Groups of Dwellings Closely Spaced (Figure Denotes Number of Dwellings)
  - Combined Dwelling and Store
  - Dwelling and Post Office
  - Dwelling and Filling Station
  - Dwelling, Business, and Filling Station
  - Tractor House
  - Seasonal or Summer Colony Dwelling
  - House, Inn
  - Humanity Society Quarters
  - Church or Other Religious Institution
  - Church and School (Joint Use)
  - Cemetery
  - Church With Cemetery Adjacent
  - Fresh Air Farm or Rest Home
  - Hospital
  - State Port of Entry or Weight Station
  - Group of Mixed Cultural Features Closely Spaced (Figure above bar indicates number of dwellings included in the group; Figure over individual units show number of each indicated regardless of order)
- INDUSTRIAL**
- Store or Small Business Establishment
  - Business and Post Office
  - Business and Filling Station
  - Business, Filling Station, and Post Office
  - Factory or Industrial Plant
  - Meat Chute or Chute (Any Kind)
  - Oil or Gas Well
  - Oil or Gas Field
  - Storage Tank (Gas or Oil) Figure Denotes Number of Tanks
  - Filling Station (Not Connected With Other Business)
  - Pumping Station (Oil or Gas)
  - Claying or Pumping Station (General)
  - Wash House
  - Seasonal Industry (Cannery or Small Grain Mill)
  - Milk Depot, Creamery or Cheese Factory
  - Fruit or Nut Orchard
  - Fruit or Produce Picking House
  - Road Stand Farm Products Sales
  - Warehouse (General or Government Add State or U.S.)
  - Gran Elevator
  - Group of Grain Storage Bins
  - Greenhouse
  - Nunnery
  - Stock Yard/Loading Pen or Corral
  - Stock Pen at Railroad Siding (Small)
  - Cravel Pit
  - Quarry
  - Kind of Oven (Lime, Clay Products, Coke, Etc.)
  - Fuel Lot
  - Shopping Center
  - Seasonal Business
  - Sawmill (Stationary)
- EDUCATIONAL AND CORRECTIONAL INSTITUTIONS**
- Schoolhouse
  - Consolidated or Large School
  - Townhall, Grange, or Community Hall
  - Agricultural Experiment Station
  - Correctional Institution
  - Prison
  - Public Library
- PUBLIC SERVICE FACILITIES**
- Post Office
  - Highway Garage
  - Fire Engine House
  - Cabbage or Rubbish Dump
  - Sewerage Disposal Plant
  - Auto Salvage Yard
  - Transformer Station
  - Power Plant
  - Power Substation
  - Booster Station
  - Water Supply Stand Pipe or Tank
  - Radio Station (With Call Letters)
  - Radio Range Station
  - Water Treatment Plant
  - Juryyard
  - U. S. Corps of Engineers Office
- MISCELLANEOUS**
- Fort, Army Camp, Barracks, or Other Military Post
  - Navigation Station
  - Bench Mark (With Elevation)

**GENERAL HIGHWAY MAP  
BARTON COUNTY  
KANSAS**

PREPARED BY THE  
KANSAS DEPARTMENT OF TRANSPORTATION  
PLANNING AND DEVELOPMENT DEPARTMENT  
IN COOPERATION WITH THE  
U. S. DEPARTMENT OF TRANSPORTATION  
FEDERAL HIGHWAY ADMINISTRATION

SCALE 0 2 4 MILES

1980

POLYCONIC PROJECTION

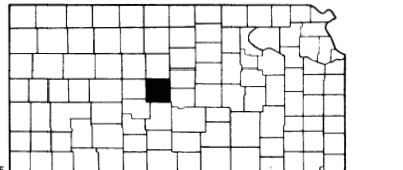

POPULATIONS—STATE BOARD OF AGRICULTURE  
INVENTORY COMPLETED BY THE  
U. S. AND STATE  
SYSTEMS REVISED TO 1980

KEY TO COUNTIES

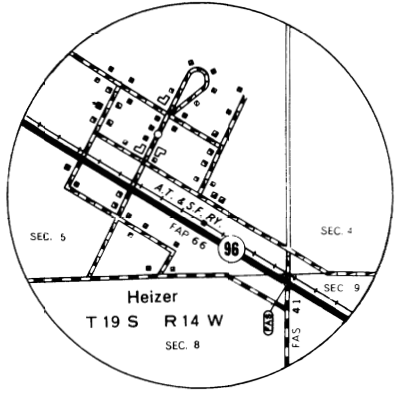
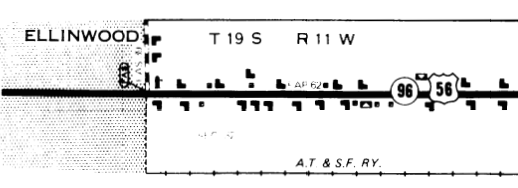
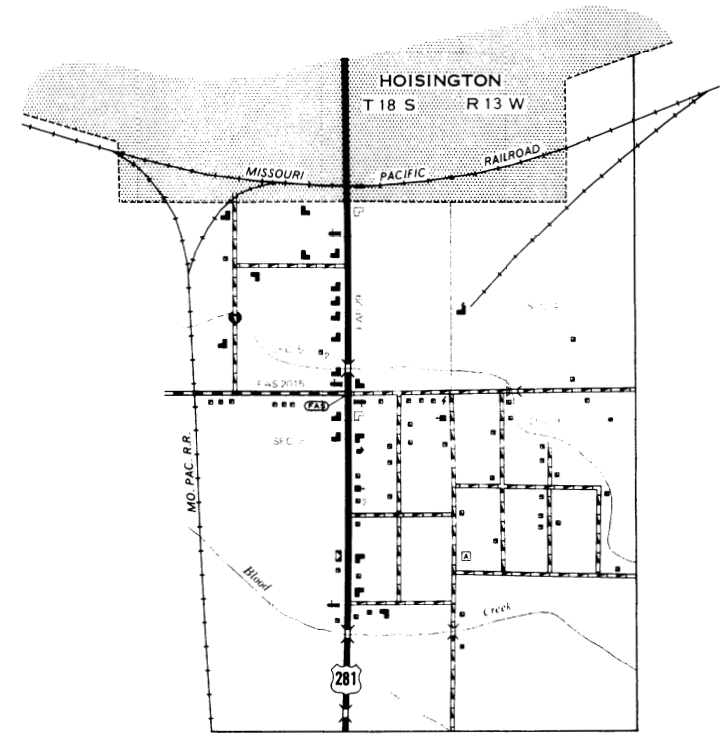
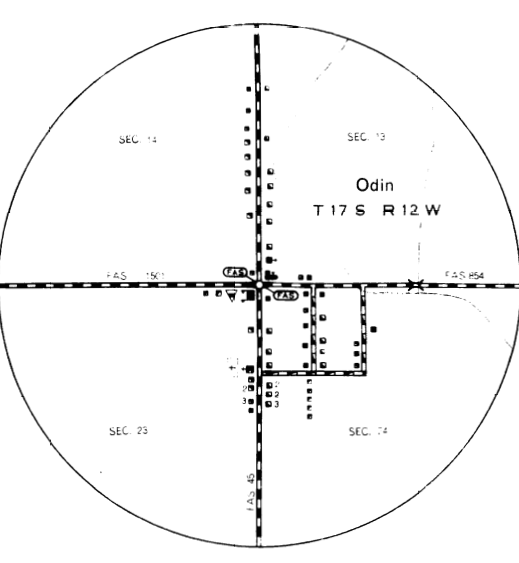
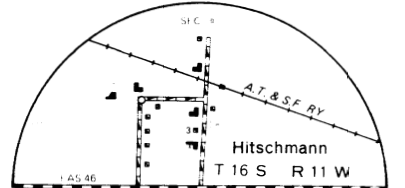
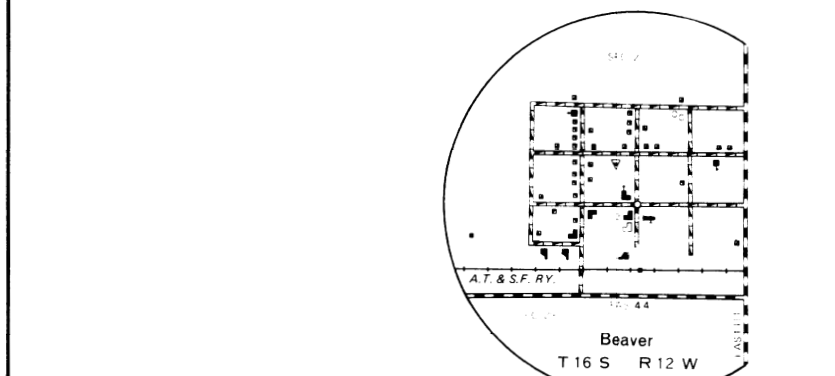

ENLARGEMENT SCALE 0 1 MILE