

LEGEND	
<b>ROADS AND ROADWAY FEATURES</b>	<b>CONSERVATION AND RECREATION</b>
Primitive Road (Type A)	Pine Ground
Unimproved Road (Type B)	Playground, Ball Field, Etc.
Gravel and Drained Road (Type C)	Bathing Beach or Swimming Pool
Salt Road (Type D)	State Site
Gravel or Stone Road	Camp Site, No Permanence (Tents or Trailer Parking)
Gravel or Stone Road	Thousand or More (Figure Indicates)
Gravel or Stone Road	Number of Permanent Cabins or Cottages
Gravel or Stone Road	Camp or Lodge (Permanent Site With Building)
Gravel and Drained (Type E-1)	Small Park (SP State, CP County)
Gravel or Stone Road With	Multi-Municipal, SR Safety Rest Area
Stabilized Surface (Type E-2)	Post-Industry Building
Shoulder Road-Like Type (Type F, G-1, H-1)	Game Farm
Paved Road (Type G-2, I, J, K, L)	Game Preserve
Divided Highway	Game Club
Highway With Full Control of Access	Golf Ground or Country Club
Side Roads and Streets in Unincorporated Urban Compacts and Extensions of Local Roads Within Municipalities	Riding Academy
4 Lane Undivided Highway	Yacht Club
Projected Road	Amusement Park or Hall
	Fair Ground, Race Course, Speedway
	Cine or Theatre
	Marina
	Guide House or Gate House (Add Letters N or S to Indicate National or State Park)
	<b>FARM UNITS, DWELLINGS, ETC.</b>
	Farm Unit
	Dwelling (Other Than Farm)
	Shed or Group of Dwellings Closely Spaced (Figure Denotes Number of Dwellings)
	Combined Dwelling and Store
	Dwelling and Post Office
	Dwelling and Filling Station
	Dwelling, Business, and Filling Station
	Tenant House
	Summer Colony Dwelling
	Home, Inn
	Nursing Society Quarters
	Church or Other Religious Institution
	Church and School Joint Use
	Cemetery
	Church With Cemetery Adjacent
	Fresh Air Farm or Rest Home
	Hospital
	Well
	Stock Pen or Paddock
	Group of Mixed Cultural Features Closely Spaced (Figure above line indicates number of dwellings included in the group. Figures over individual units show number of each included regardless of order)
	<b>INDUSTRIAL</b>
	Store or Small Business Establishment
	Business and Post Office
	Business, Filling Station, and Post Office
	Factory or Industrial Plant
	Mine Shaft or Drift (Any Kind)
	Oil or Gas Well
	Oil or Gas Field
	Storage Tank (Gas or Oil Figure Denotes Number of Tanks)
	Filling Station (Not Connected With Other Business)
	Pumping Station (Oil or Gas)
	Gauging or Pumping Station (General)
	Valve House
	Seasonal Industry (Cannery or Small Grain Mill)
	Milk Depot, Creamery or Cheese Factory
	Fruit or Nut Orchard
	Road Stand Farm Products Sales
	Warehouse-General (If Government Add State or U.S.)
	Grain Elevator
	Group of Grain Storage Bins
	Gasoline
	Nursery
	Stock Feed-Loading Pen or Corral
	Stock Pen at Railroad Station (Small)
	Grain Pen
	Quarry
	Open Pit (Lime, Clay, Products, Coke, Etc.)
	Feed Lot
	Shopping Center
	Seasonal Business
	General (Stationary)
	<b>EDUCATIONAL AND CORRECTIONAL INSTITUTIONS</b>
	Schoolhouse
	Consolidated or Large School
	Townhall, Grange, or Community Hall
	Agricultural Experiment Station
	Correctional Institution
	Museum-General
	Public Library
	<b>PUBLIC SERVICE FACILITIES</b>
	Post Office
	Highway Garage
	Fire Engine House
	Garbage or Rubbish Dump
	Sewage Disposal Plant
	Auto Salvage Yard
	Transfer Station
	Power Plant
	Power Substation
	Booster Station
	Water Supply Stand Pipe or Tank
	Radio Station (With Call Letters)
	Water Treatment Plant
	Radio Range Station
	Water Treatment Plant
	Jurymead
	U. S. Corps of Engineers Office
	<b>MISCELLANEOUS</b>
	Fort, Army Camp, Barracks, or Other Military Post
	Transit Station
	Bench Mark (With Elevation)

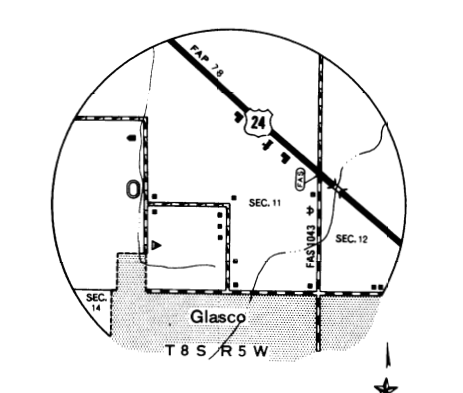

# GENERAL HIGHWAY MAP CLOUD COUNTY KANSAS

PREPARED BY THE  
KANSAS DEPARTMENT OF TRANSPORTATION  
PLANNING AND DEVELOPMENT DEPARTMENT  
IN COOPERATION WITH THE  
U. S. DEPARTMENT OF TRANSPORTATION  
FEDERAL HIGHWAY ADMINISTRATION

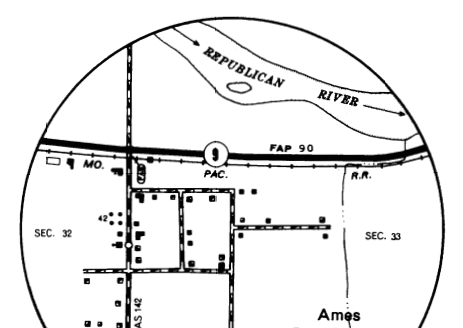
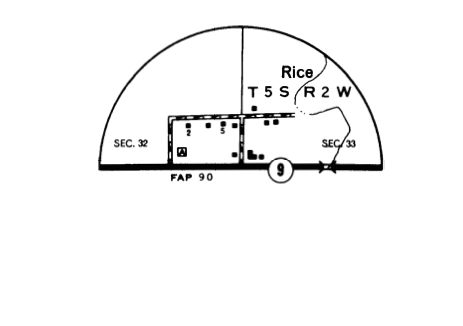
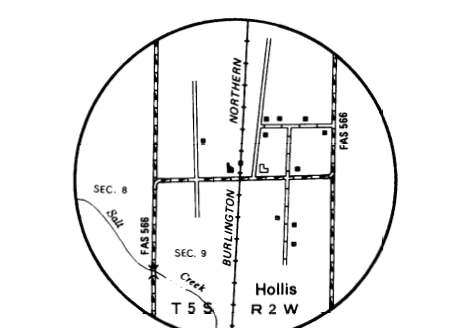
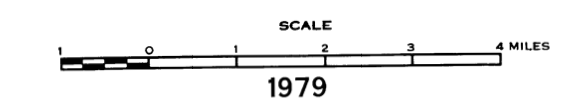

1979  
POLYCONIC PROJECTION

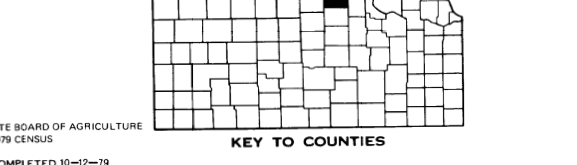

POPULATIONS—STATE BOARD OF AGRICULTURE  
1979 CENSUS  
REVENUE—COMPLETED 1978  
P. A. AND STATE  
SYSTEMS REVISED TO 1978