

LEGEND

ROADS AND ROADWAY FEATURES	CONSERVATION AND RECREATION
<ul style="list-style-type: none"> Paved Road (Type A) Unimproved Road (Type B) Graded and Drained Road (Type C) Soil Surface Road (Type D) Gravel or Stone Road — Graded and Drained (Type E-1) Gravel or Stone Road With Stabilized Surface (Type E-2) Blumston Road — Low Type (Type F, G, H, I) Paved Road (Type G-2, H-2, I, J, K, L) Divided Highway Highway With Full Control of Access Side Road and Groves in Unincorporated Urban Compacts and Extensions of Local Roads Within Municipalities 4 Lane Undivided Highway Proposed Road Road System Designation Federal-Aid Interstate Highway System Federal-Aid Primary Highway System Federal-Aid Secondary Highway System Federal-Aid Urban Highway System Points Between Which Distances are Measured Interstate Numbered Highway U.S. Numbered Highway State Highway System or State Numbered Highway End of Designated System or Marked Route 	<ul style="list-style-type: none"> Picnic Ground Playground, Ball Field, Etc. Bathing Beach or Swimming Pool Scenic Site Camp Site No. Permanence Terms or Trailer Parking Tourist Court or Motel (Figure Indicates Number of Permanent Cabins or Cottages) Camp or Lodge (Permanent Site with Building) Small Park (SP-State, CP-County) AP-Municipal, SN-Safety, Rest Area Fish Hatchery Game Farm Game Preserve Rifle Club Golf Ground or Country Club Hiding Academy Yacht Club Amusement Park or Hall Fair Ground, Race Course, Speedway Marina Public Grounds Guide House or Gate House (Add Letters "N" or "S" to Indicate National or State Park) FARM UNITS, DWELLING, ETC. Dwelling Multi-Dwelling and Store Dwelling and Post Office Dwelling and Filling Station Dwelling, Business and Filling Station Lawyer House Home, Inn Homeless Society Quarters Church or Other Religious Institution Church and School (Joint Use) Church With Community Adjacent Fresh Air Farm or Rest Home Hospital Watershed State Port or Entry or Weight Station Group or Mixed Cultural Features Closely Spaced (Figure above bar indicates number of dwellings included in the group. Figures over individual units show number of each, including regardless of order) INDUSTRIAL Store or Small Business Establishment Business and Filling Station Business, Filling Station, and Post Office Factory or Industrial Plant Mine Shaft or Oil Well (Any Kind) Oil or Gas Well Oil or Gas Field Storage Tank (See or Oil Field) Derrick Number of Tanks Filling Station (Not Connected With Other Business) Pumping Station (Oil or Gas) Geopipe or Pumping Station (General) Valve House Seasoned Industry (Caninery or Small Grain Mill) Milk Depot Creamery or Cheese Factory Fruit or Produce Packing House Road Street Farm Products Sales Manufactures — General (If Government Add State or U.S.) Grain Elevator Group of Grain Storage Bins Greenhouse Nursery Stock Feed-Loading Pen or Canal Stock Pen at Railroad Siding (Small) Stock-Crowling Pen Rock Quarry Kiln or Oven (Lime, Clay Products, Cokes, Etc.) Feed Lot Seasonal Business Sawmill (Stationary) Public Library PUBLIC SERVICE FACILITIES Post Office Highway Garage Fire Engine House Garbage or Rubbish Dump Sanitary Disposal Plant Auto Service Station Transformer Station Power Plant Booster Station Water Supply Stand Pipe or Tank Radio Station (With Call Letters) Radio Range Station Water Treatment Plant Junkyard U.S. Corps of Engineers Office Fort, Army Camp, Barracks or Other Military Post Navigation Station

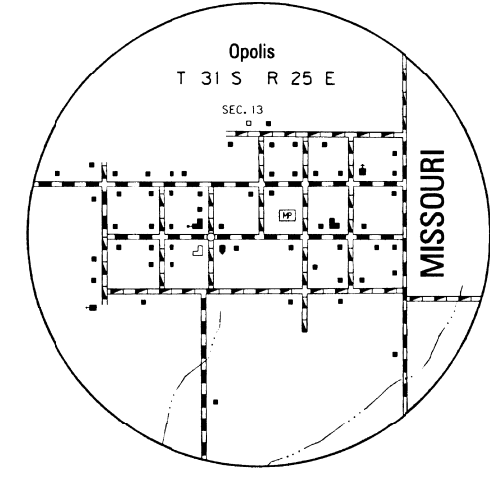
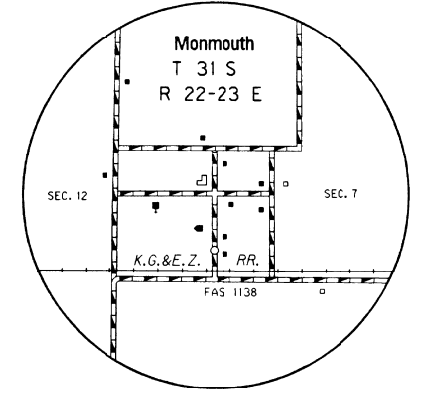
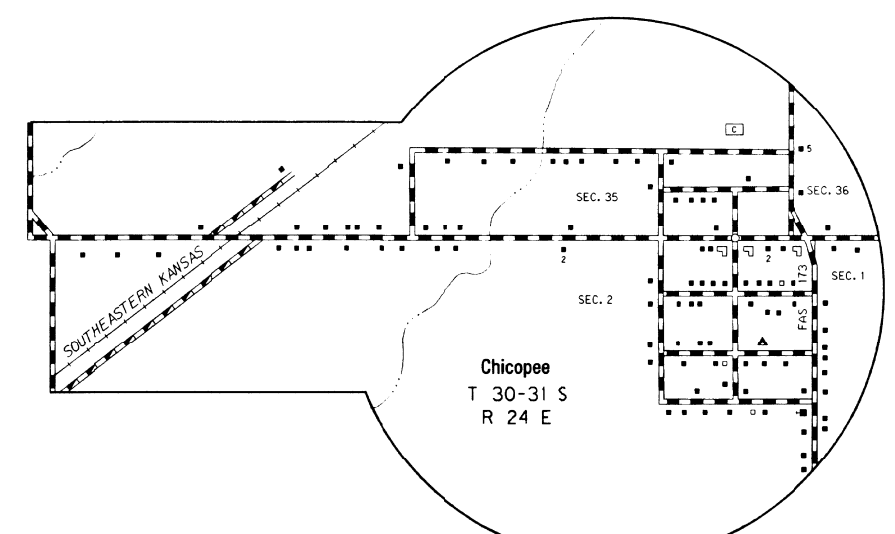
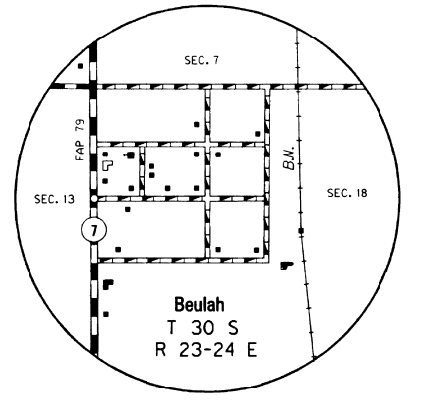
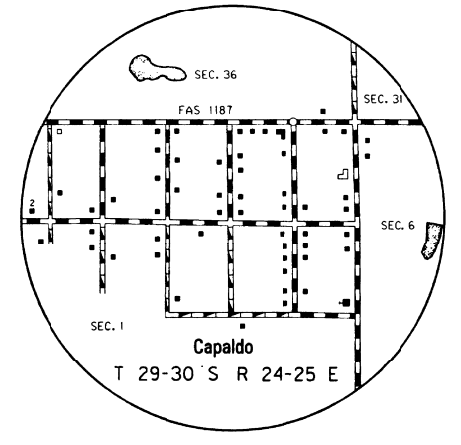
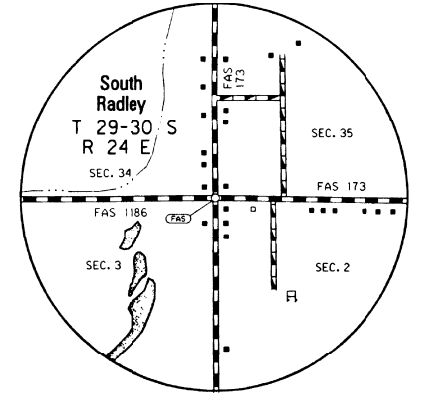
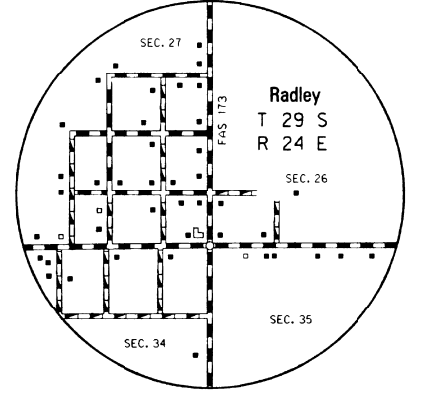
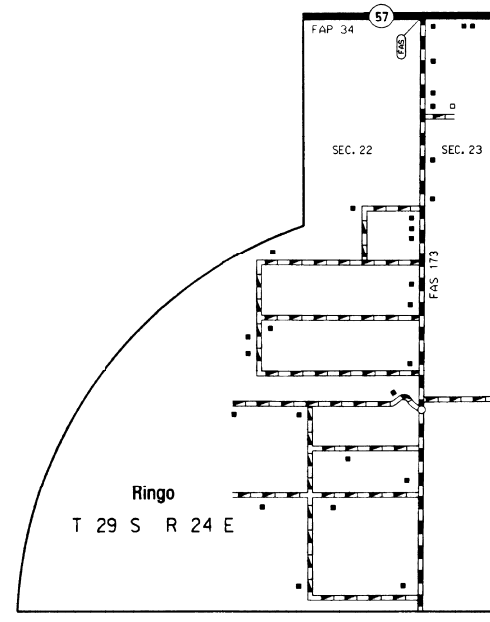
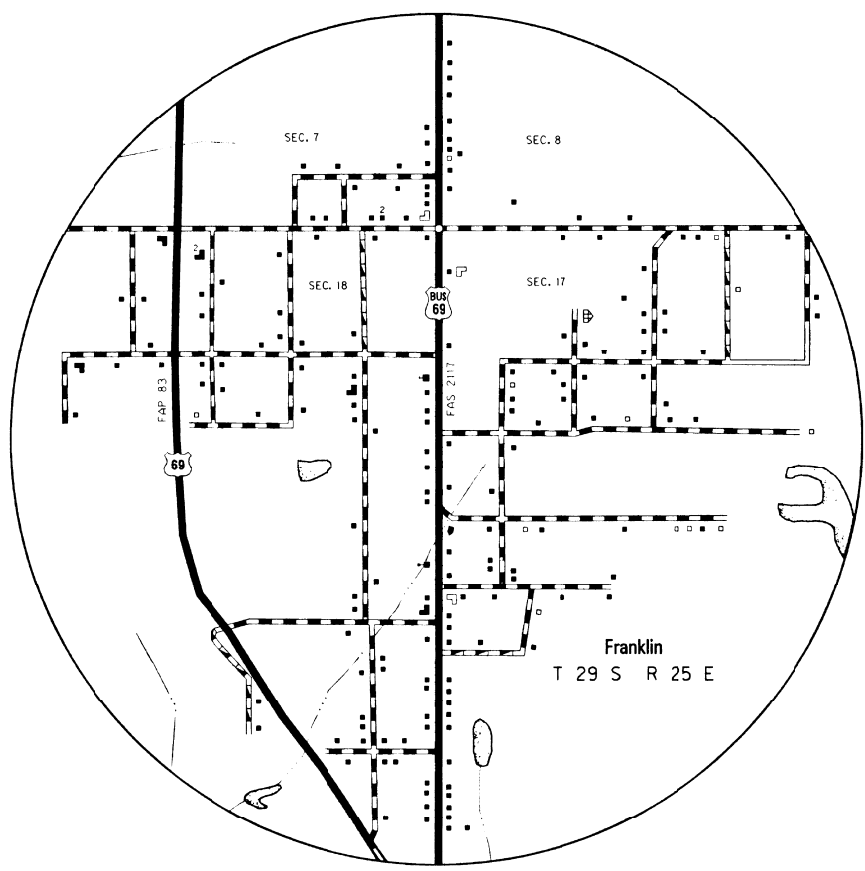
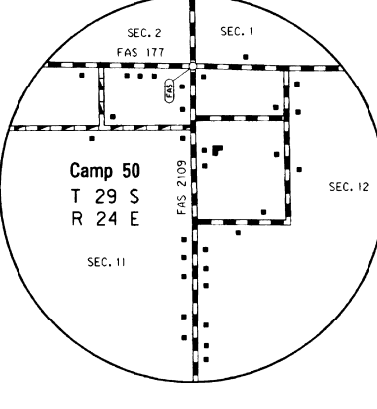
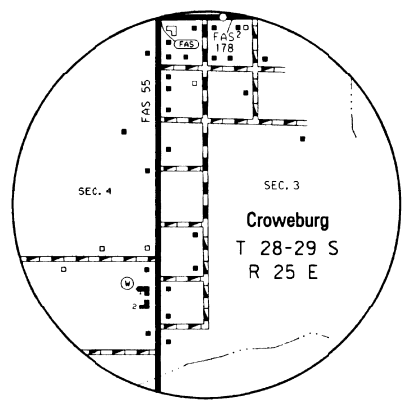
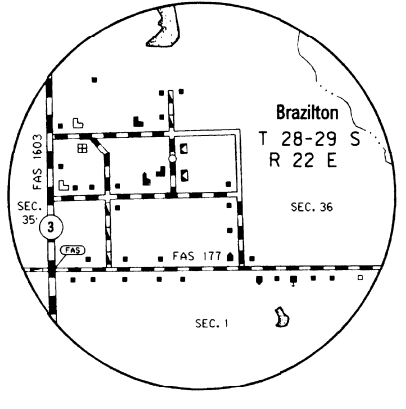
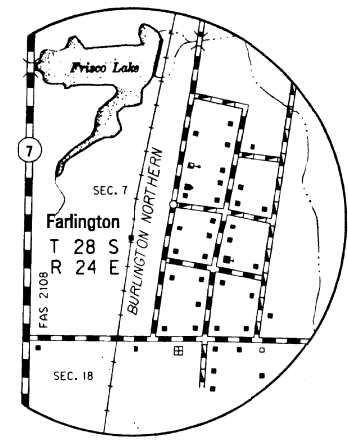
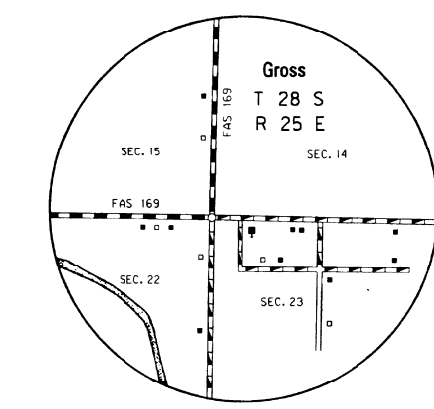

GENERAL HIGHWAY MAP CRAWFORD COUNTY KANSAS

PREPARED BY THE
KANSAS DEPARTMENT OF TRANSPORTATION
BUREAU OF TRANSPORTATION PLANNING
IN COOPERATION WITH THE
U.S. DEPARTMENT OF TRANSPORTATION
FEDERAL HIGHWAY ADMINISTRATION

SCALE IN MILES
0 1 2 3 4 MILES

SCALE IN KILOMETERS
0 1 2 3 4 5 6 7 8 9 10 KILOMETERS

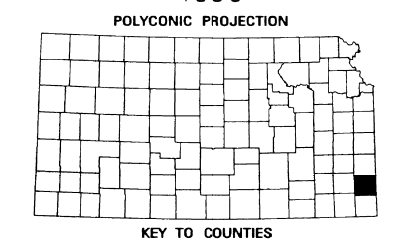

POPULATION - 1990 U.S. CENSUS
POPULATION COMPLETED 9-30-93
F.A. AND STATE PRINTING DESIGNED TO 1-5-92