

Sparks
T 2 S R 20 E

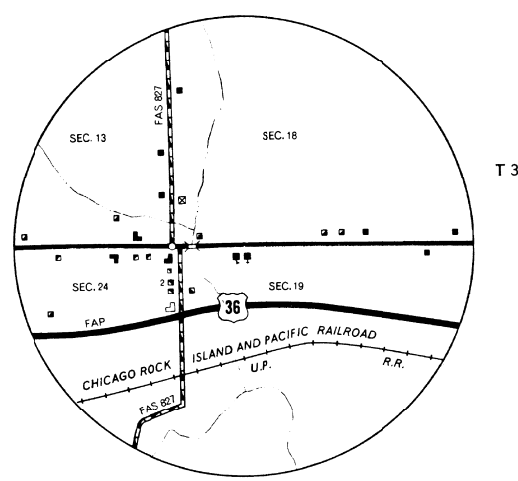

Blair
T 3 S R 22 E

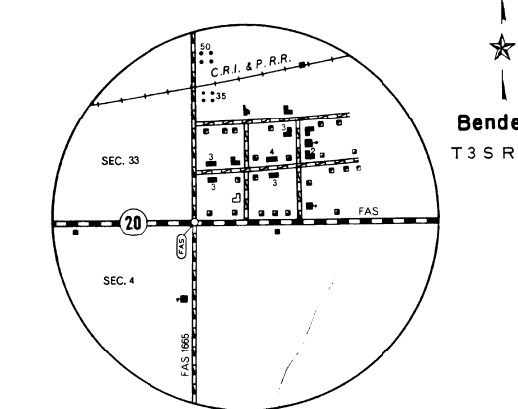

Bendena
T 3 S R 20 E

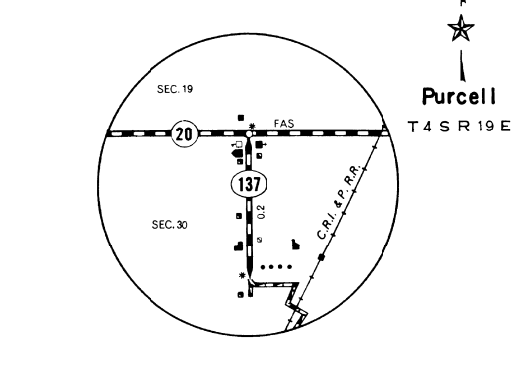

Purcell
T 4 S R 19 E

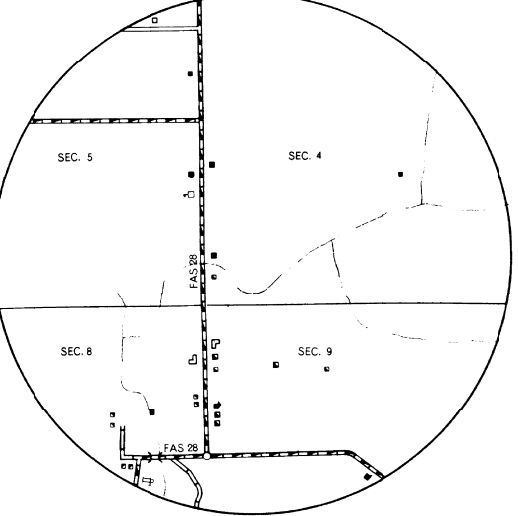

Doniphan
T 5 S R 21 E

ENLARGEMENT SCALE 1 MILE

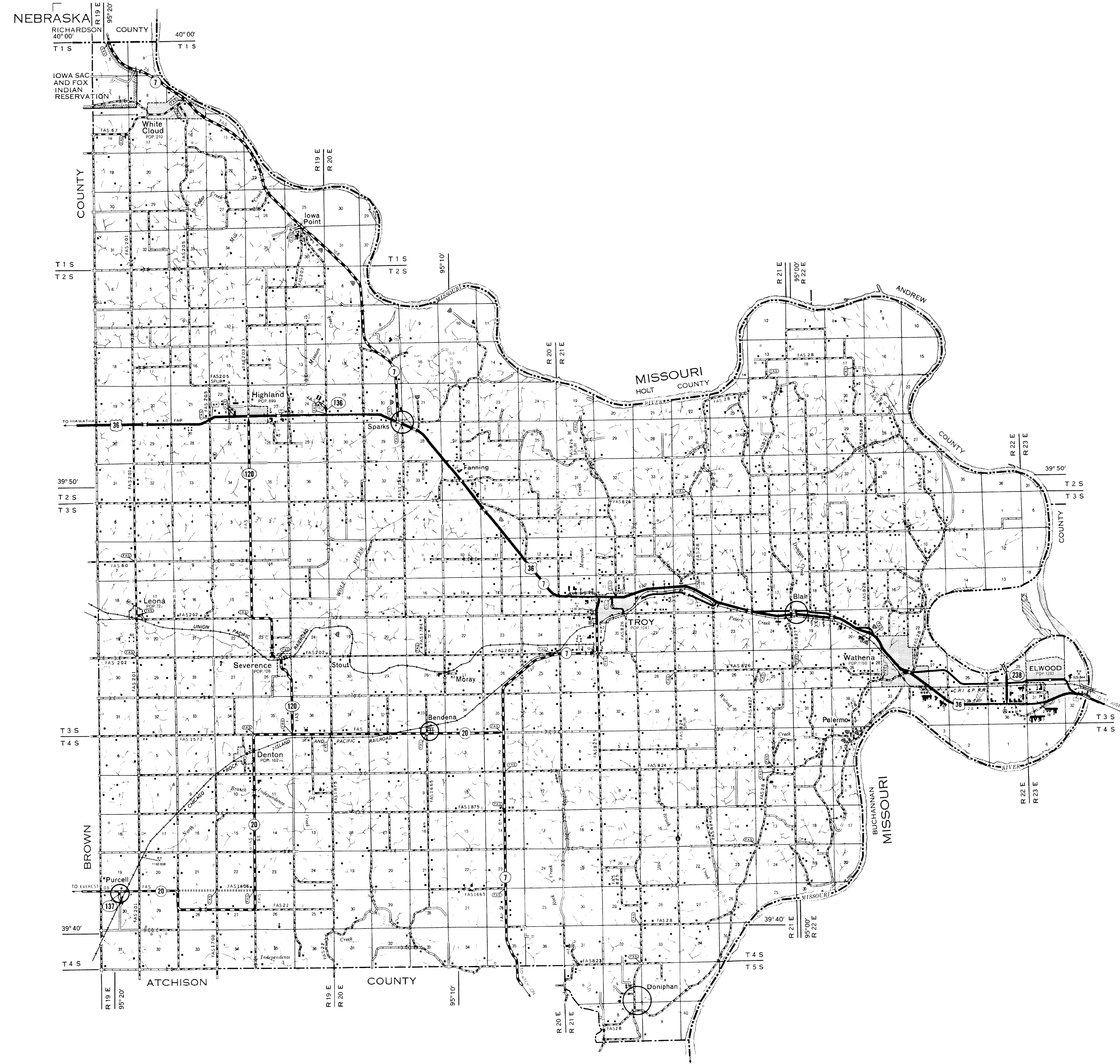

LEGEND

ROADS AND ROADWAY FEATURES		CONSERVATION AND RECREATION	
PRIMITIVE ROAD TYPE A1	PICNIC GROUND
UNIMPROVED ROAD TYPE B1	PLAYGROUND, BALL FIELD, ETC.
GRADED AND DRAINED ROAD TYPE C1	BATHING BEACH OR SWIMMING POOL
SOIL SURFACED ROAD TYPE D1	SCENIC SITE
GRAVEL OR STONE ROAD - NOT GRADED OR DRAINED TYPE E1	CAMP SITE - NO PERMANENCE TRIPS OR TRAILER PARKING
GRAVEL OR STONE ROAD - GRADED AND DRAINED TYPE E2	TOURIST COURT OR MOTEL
GRAVEL OR STONE ROAD WITH STABILIZED SURFACE TYPE F1	CAMP OR LODGE - PERMANENT SITE WITH BUILDINGS
BITUMINOUS ROAD - LOW TYPE TYPE F2	SMALL PARK
DIVIDED HIGHWAY	FISH HATCHERY
HIGHWAY WITH FULL CONTROL OF ACCESS	BIRD SANCTUARY
SIDE ROADS AND STREETS IN UNINCORPORATED URBAN CONCENTRATIONS OF LOCAL ROADS WITHIN MUNICIPALITIES	GAME FARM
4 LANE UNDIVIDED HIGHWAY	GAME PRESERVE
PRIVATE ROAD	RIFLE CLUB
PROJECTED ROAD	GOLF GROUND OR COUNTRY CLUB
		POLO GROUNDS
		RIDING ACADEMY
		YACHT CLUB
		AMUSEMENT PARK OR HALL
		FAIR GROUND, RACE COURSE, SPEEDWAY
		DRIVE-IN THEATRE
ROAD SYSTEM DESIGNATION		FARM UNITS, DWELLINGS, ETC.	
FEDERAL-AID INTERSTATE HIGHWAY SYSTEM	FARM UNIT
FEDERAL-AID PRIMARY HIGHWAY SYSTEM	DWELLING - OTHER THAN FARM
FEDERAL-AID SECONDARY HIGHWAY SYSTEM	ROWS OR GROUPS OF DWELLINGS CLOSELY SPACED
INTERSTATE NUMBERED HIGHWAY	COMBINED DWELLING AND STORE
U. S. NUMBERED HIGHWAY	DWELLING AND POST OFFICE
STATE HIGHWAY SYSTEM OR STATE NUMBERED HIGHWAY	DWELLING AND FILLING STATION
END OF DESIGNATED SYSTEM OR MARKED ROUTE	TENANT HOUSE
		SEASONAL OR SUMMER COLONY DWELLING
		HOTEL, INN
		CHURCH OR OTHER RELIGIOUS INSTITUTION
		CHURCH AND SCHOOL
		CEMETERY
		CHURCH WITH CEMETERY ADJACENT
		FRESH AIR FARM OR REST HOME
		HOSPITAL
		WELL
		STATE PORT OF ENTRY OR WEIGHT STATION
		GROUP OF MIXED CULTURAL FEATURES CLOSELY SPACED
		HOUSE MADE BY INDIVIDUALS OR DWELLINGS FROM REMAINS OF SPECIFIC CULTURE
RAILROADS		INDUSTRIAL	
RAILROAD - TRACK NUMBER OF MILES LIES BY A	STORE OR SMALL BUSINESS ESTABLISHMENT
RAILROADS IN JUNCTURE POSITION	BUSINESS AND POST OFFICE
NARROW GAUGE RAILROAD	BUSINESS, FILLING STATION, AND POST OFFICE
ELECTRIC INTERURBAN OR SUBURBAN RAILROAD	FACTORY OR INDUSTRIAL PLANT
ABANDONED RAILROAD - TRACK REMAINS	MINE-SHAFT OR DRIFT (ANY KIND)
RAILROAD STATION	OIL OR GAS WELL
		OIL OR GAS FIELD
		OIL TANK
		GAS TANK
		GROUP OF STORAGE TANKS (OIL OR GAS)
		FILLING STATION - NOT CONNECTED WITH OTHER BUSINESS
		PUMPING STATION
		GAUGING OR PUMPING STATION - GENERAL
		VALVE HOUSE
		SEASONAL INDUSTRY - CANNERY OR SMALL GRAIN MILL
		MILK DEPOT - CREAMERY OR CHEESE FACTORY
		FRUIT OR NUT ORCHARD
		FRUIT OR PRODUCE PACKING HOUSE
		ROAD BY AND FARM PRODUCTS SALES
		WAREHOUSE - GENERAL (IF GOVERNMENT AND STATE OR U.S. GRAIN ELEVATOR)
		GROUP OF GRAIN STORAGE BINS
		GREENHOUSE
		NURSERY
		STOCK YARD - LOADING PEN OR CORRAL
		STOCK PEN AT RAILROAD STATION - CLOSELY SPACED
		GRAVEL PIT
		QUARRY
		KILN OR OVEN - LIME, CLAY PRODUCTS, ETC.
AIRWAYS AND AIRPORTS		EDUCATIONAL AND CORRECTIONAL INSTITUTIONS	
AIR ROUTE	SCHOOLHOUSE
AIRPORT - COMPLETE FACILITIES (COMMERCIAL OR MUNICIPAL)	TOWNSHIP OR LARGE SCHOOL
AIRFIELD - LIMITED FACILITIES	COVERED BRIDGE
LANDING AREA OR STRIP - INCLUDING PRIVATE AIR FIELD	HIGHWAY GRADE SEPARATION
AIRWAY LIGHT BEACON - GENERAL		
AIRPORT - GENERAL	MISCELLANEOUS STRUCTURES	
		DAM WITH ROAD
		LEVEE OR DIKE
		LEVEE OR DIKE WITH ROAD
		CONCRETE FORD OR DIP
		FORD-ROAD ESTABLISHED
		CATTLE GUARD
		GATE ACROSS ROAD (ANY TYPE)
RAILROAD CROSSINGS		BOUNDARIES	
GRADE CROSSING	COUNTY
RAILROAD ABOVE	CORPORATE LINES
RAILROAD BELOW	BOUNDARY LINES - ESTABLISHED FOR DELIMITED URBAN PLACES
RAILROAD BRIDGE	SECTION LINE
		MATCH LINE BETWEEN ADJOINING SHEETS OF SAME COUNTY
		BOUNDARY TO MARK ENLARGEMENT INSET
		PARKS AND OTHER RESERVATIONS NATIONAL, STATE, COUNTY OR MUNICIPAL PARK
		INDIAN RESERVATION NATIONAL MONUMENT
		FEDERAL DEVELOPMENT PROJECT
		MONUMENT - SMALL - HISTORIC SITE
CITY AND VILLAGE CENTERS		PUBLIC SERVICE FACILITIES	
STATE CAPITAL	POST OFFICE
COUNTY SEAT	HIGHWAY GARAGE
OTHER CITIES AND VILLAGES	FIRE ENGINE HOUSE
INCORPORATED CITY OR VILLAGE	GARBAGE OR RUBBISH DUMP
BOUNDARY LIMITS FIXED FOR SPECIAL TAXING AREAS AND OTHER UNINCORPORATED URBAN PLACES DELIMITED	SEWAGE DISPOSAL PLANT
		AUTO SALVAGE YARD
		TRANSFORMER STATION
		POWER SUBSTATION
		BOOSTER STATION
		WATER SUPPLY, STAND PIPE, OR TANK
		RADIO STATION - WITH CALL LETTERS
		RADIO RANGE STATION
		MISCELLANEOUS	
		FORT, ARMY CAMP, BARRACKS, OR OTHER MILITARY POST
		TRIANGULATION STATION
		BENCH MARK - WITH ELEVATION
		NATURAL FEATURES	
		PROMINENT ELEVATION - WITH NAME
		SINK OR DEPRESSION

GENERAL HIGHWAY MAP
DONIPHAN COUNTY
KANSAS

PREPARED BY THE
STATE HIGHWAY COMMISSION OF KANSAS
DEPARTMENT OF PLANNING AND DEVELOPMENT
IN COOPERATION WITH THE
U. S. DEPARTMENT OF TRANSPORTATION
FEDERAL HIGHWAY ADMINISTRATION

SCALE 0 1 2 3 4 MILES

1971

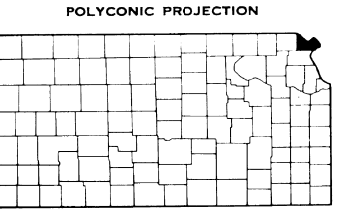

KEY TO COUNTIES

INVENTORY COMPLETED 1-13-70
P. A. AND STATE SYSTEMS REVISED TO 1-13-70