

LEGEND

ROADS AND ROADWAY FEATURES	CONSERVATION AND RECREATION
PRIMITIVE ROAD (TYPE 1)	PICNIC GROUND
UNIMPROVED ROAD (TYPE 2)	PLAYGROUND, BALL FIELD, ETC.
GRADED AND DRAINED ROAD (TYPE 3)	BATHING BEACH OR SWIMMING POOL
SOIL SURFACED ROAD (TYPE 4)	SCENIC SITE
GRAVEL OR STONE ROAD - NOT GRADED OR DRAINED (TYPE 5.1)	CAMP SITE - NO PERMANENCE (TYPE 6)
GRAVEL OR STONE ROAD - GRADED AND DRAINED (TYPE 5.2)	TOURIST SWIMMING POOL
GRAVEL OR STONE ROAD WITH STABILIZED SURFACE (TYPE 6.1)	CAMP OR LODGE
PAVED ROAD (TYPE 6.2)	SMALL PARK
BITUMINOUS ROAD - LOW TYPE (TYPE 6.3)	FISH HATCHERY
BITUMINOUS ROAD - HIGH TYPE (TYPE 6.4)	BIRD SANCTUARY
DIVIDED HIGHWAY	GAME FARM
SIDE ROADS	GAME PRESERVE
PORTED URBAN COMPACTS AND EXTENSIONS OF LOCAL ROADS WITHIN MUNICIPALITIES	RIFLE CLUB
4 LANE UNDIVIDED HIGHWAY	GOLF GROUND OR COUNTRY CLUB
PRIVATE ROAD	POLO GROUNDS
PROJECTED ROAD	RIDING ACADEMY
	YACHT CLUB
	AMUSEMENT PARK OR HALL
	FAIR GROUND RACE COURSE
	GREENWAY
	DRIVE-IN THEATRE
ROAD SYSTEM DESIGNATION	FARM UNITS, DWELLINGS, ETC.
FEDERAL AID PRIMARY HIGHWAY SYSTEM	FARM UNIT - OTHER THAN FARM
FEDERAL AID SECONDARY HIGHWAY SYSTEM	DWELLING (OTHER THAN FARM)
STATE AID ROAD	ROWS OF GROUPS OF DWELLINGS CLOSELY SPACED (NUMBER NUMBER OF DWELLINGS)
POINTS BETWEEN WHICH DISTANCES ARE MEASURED INDICATED TRUS	COMBINED DWELLING AND STORE
TRAFFIC CIRCLE	DWELLING AND FILLING STATION
U. S. NUMBERED HIGHWAY	STATE FARM
STATE HIGHWAY SYSTEM OR STATE NUMBERED HIGHWAY	TENANT HOUSE
END OF DESIGNATED SYSTEM OR MARKED ROUTE	SEASONAL OR SUMMER COLONY DWELLING
	HOTEL, INN
RAILROADS	CHURCH OR OTHER RELIGIOUS INSTITUTION
RAILROAD (TYPE 1) - TRACKS AND ROAD	CHURCH AND SCHOOL (JOINT USE)
RAILROADS IN JUNCTURE POSITION (TYPE 2) - TRACKS AND ROAD	CHURCH WITH CEMETERY ADJACENT
NARROW GAUGE RAILROAD	FRESH AIR FARM OR REST HOME
ELECTRIC INTERURBAN OR SUBURBAN RAILROAD	HOSPITAL
ABANDONED RAILROAD (TRACK REMOVED)	WELL
ABANDONED ELECTRIC LINE (TRACK REMOVED)	STATE POINT OF ENTRY OR WEIGHT STATION
RAILROAD STATION	GROUP OF MIXED CULTURAL FEATURES CLOSELY SPACED
RAILROAD CROSSINGS	INDUSTRIAL
RAILROAD CROSSING	STORE OR SMALL BUSINESS ESTABLISHMENT
RAILROAD ABOVE	BUSINESS AND FILING STATION
RAILROAD BELOW	BUSINESS - FILING STATION, AND POST OFFICE
RAILROAD BRIDGE	FACTORY OR INDUSTRIAL PLANT
RAILROADS ON STREETS OR ROADS	MINE-SHAFT OR DRIFT (GENERAL OR MUNICIPAL)
STANDARD GAUGE RAILROAD	OIL OR GAS WELL
ELECTRIC RAILROAD	OIL OR GAS FIELD
	OIL TANK
AIRWAYS AND AIRPORTS	GAS TANK
AIR ROUTE	GROUP OF STORAGE TANKS (AS PER MARK)
MILITARY FIELD (TYPE 1) - FACILITIES AVAILABLE	FILLING STATION (NOT CONNECTED WITH OTHER BUSINESS)
AIRPORT - COMPLETE FACILITIES (GENERAL OR MUNICIPAL)	RUMPING STATION (OIL OR GAS)
AIRFIELD - LIMITED FACILITIES	Gauging or Pumping Station
LANDING AREA OR STRIP (GENERAL OR MUNICIPAL)	VALVE HOUSE
AIRWAY LIGHT BEACON - GENERAL	SEASONAL INDUSTRY (GENERAL OR SMALL SCALE)
AIRPORT - GENERAL	MILK DEPOT, CREAMERY OR CHEESE FACTORY
	FRUIT OR NUT ORCHARD
NAVIGATION	ROAD STAND FARM PRODUCTS SALES
NAVIGABLE STREAM (NOT CONNECTED WITH OTHER BUSINESS)	WAREHOUSE - GENERAL (IF GOVERNMENT AND STATE OR A. L.)
INTERMITTENT STREAM	GRAIN ELEVATOR
INTERMITTENT STREAM	C. C. STORAGE BINS
NARROW STREAM	GREENHOUSE
WIDE STREAM	NURSERY
DRAINAGE DITCH	STOCK YARD - LOADING PEN OR CORRAL
IRRIGATION DITCH	STOCK PEN AT RAILROAD SIDING
LAKE, RESERVOIR, OR POND	QUARRY
LAKE, RESERVOIR, OR POND WITH DAM	MILK OR OVEN (MILK OVEN PRODUCES GHEE)
DRY LAKE SUBJECT TO FLOOD	
MARSH OR SWAMP LAND	
OVERFLOW LAND	
	EDUCATIONAL AND CORRECTIONAL INSTITUTIONS
STRUCTURES	SCHOOLHOUSE
HIGHWAY BRIDGE - GENERAL	CONSOLIDATED OR LARGE SCHOOL
SMALL BRIDGES CLOSELY SPACED	TOWNHALL, GRANGE, OR COMMUNITY HALL
BRIDGES FOR LONG RIVER CROSSINGS	AGRICULTURAL EXPERIMENT STATION
GENERAL	CORRECTIONAL INSTITUTION
ARCH	
TRUSS OR GIRDER (WOOD OR STEEL)	PUBLIC SERVICE FACILITIES
CANTILEVER BRIDGE	POST OFFICE
COVERED BRIDGE	HIGHWAY GARAGE
HIGHWAY GRADE SEPARATION	PIPE ENGINE HOUSE
MISCELLANEOUS STRUCTURES	GARAGE OR RUBBER DUMP
DAM WITH ROAD	SEWAGE DISPOSAL PLANT
LEVEE OR DIKE WITH ROAD	WATER SUPPLY, STAND PIPE, OR TANK
CONCRETE FORD OR DIP	PIPE LINE, GAS
FORD-ROAD ESTABLISHED	PIPE LINE, OIL
CATTLE GUARD	PIPE LINE, PRODUCTS
GATE ACROSS ROAD	TRANSMISSION LINE, WITH TRANSFORMER BRIDGE
	POWER PLANT
BOUNDARIES	POWER SUBSTATION
STATE	BOOSTER STATION
COUNTY	UNDERGROUND TELEPHONE OR RADIO CABLE
DELIMITED URBAN PLACES	RADIO STATION (WITH CALL LETTERS)
SECTION LINE	RADIO STATION
MATCH LINE BETWEEN ADJOINING SHEETS OF SAME COUNTY	
BOUNDARY TO MARK ENLARGEMENT INSET	MISCELLANEOUS
PARKS AND OTHER RESERVATIONS NATIONAL, STATE, COUNTY, OR MUNICIPAL PARK	FORT, ARMY CAMP, BARRACKS, OR OTHER
INDIAN RESERVATION - NATIONAL MONUMENT, FEDERAL DEVELOPMENT PROJECT	MILITARY POST
MONUMENT - SMALL HISTORIC SITE	TRIANGULATION STATION
	BENCH MARK (WITH ELEVATION)
CITY AND VILLAGE CENTERS	
STATE CAPITAL	NATURAL FEATURES
COUNTY SEAT	PROMINENT ELEVATION, WITH NAME
OTHER CITIES AND VILLAGES	SINK OR DEPRESSION
INCORPORATED CITY OR VILLAGE	
BOUNDARY LIMITS FIXED FOR SPECIAL TAXING	
AREAS AND OTHER UNINCORPORATED URBAN PLACES DELIMITED	

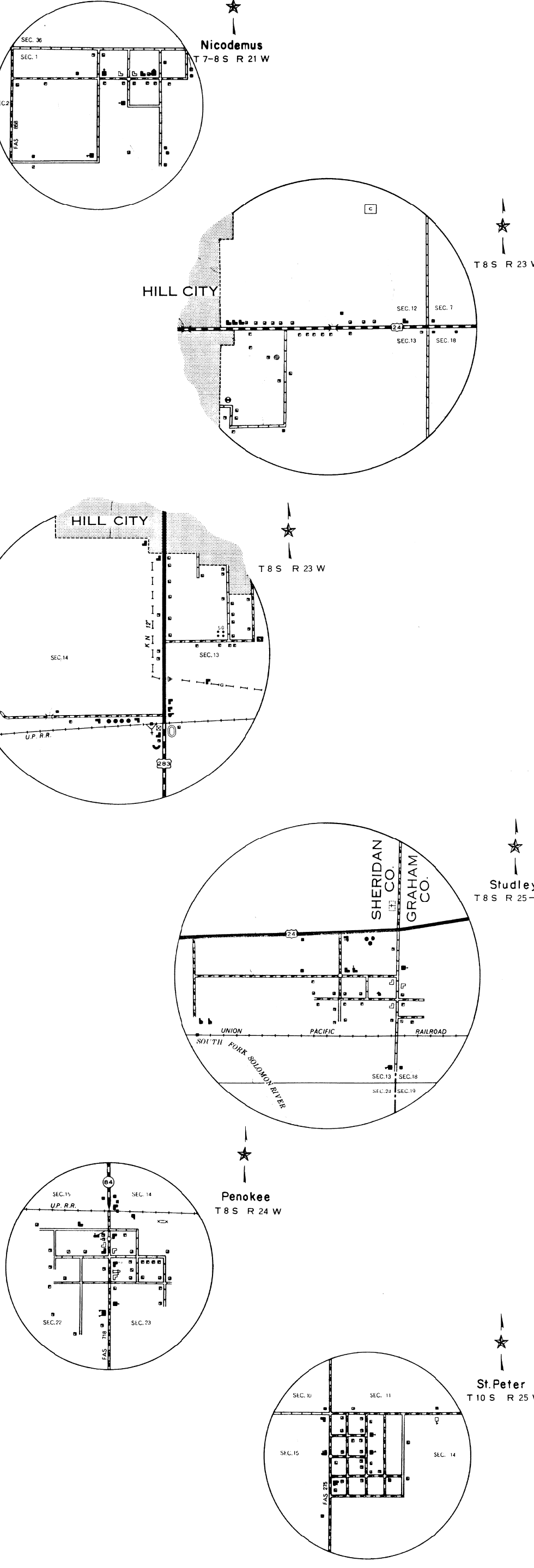
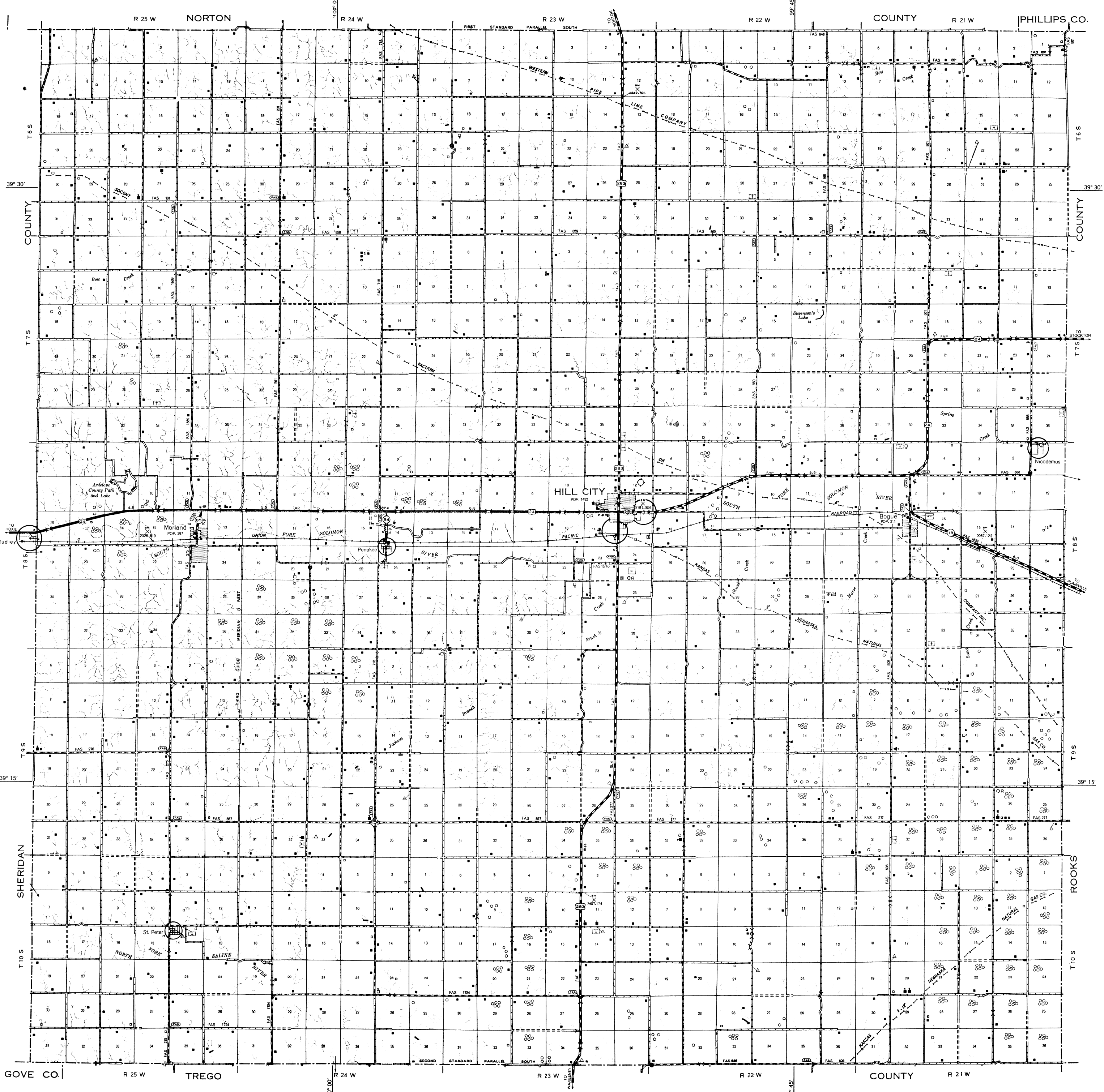

GENERAL HIGHWAY MAP
GRAHAM COUNTY
 KANSAS

PREPARED BY THE
 STATE HIGHWAY COMMISSION OF KANSAS
 HIGHWAY PLANNING DEPARTMENT
 IN COOPERATION WITH THE
 U. S. DEPARTMENT OF COMMERCE
 BUREAU OF PUBLIC ROADS

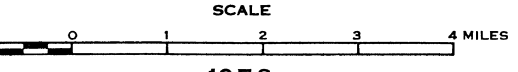

1956
 POLYCONIC PROJECTION

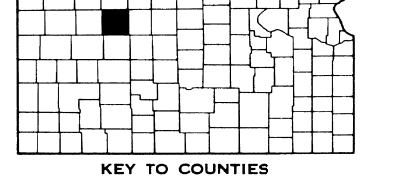

KEY TO COUNTIES