

LEGEND

<p>ROADS AND ROADWAY FEATURES</p> <ul style="list-style-type: none"> Primitive Road (Type A) Unimproved Road (Type B) Gravel and Drained Road (Type C) Soil Surface Road (Type D) Gravel or Stone Road—Not Gravel or Drained (Type E-1) Gravel or Stone Road—Gravel or Drained (Type E-2) Stabilized Surface Road (Type E-3) Bituminous Road—Low Type (Type F, G, H, I) Road Road Type G-2, H-2, L, K, L Divided Highway Highway With Full Control of Access Side Roads and Streets in Unincorporated Urban Compact and Extensions of Local Roads Within Municipalities 4 Lane Undivided Highway Projected Road <p>Road System Designation</p> <ul style="list-style-type: none"> Federal-Aid Interstate Highway System Federal-Aid Primary Highway System Federal-Aid Secondary Highway System Federal-Aid Urban Highway System <p>Points Between Which Distances are Measured</p> <ul style="list-style-type: none"> Interstate Numbered Highway State Numbered Highway rd of Designated System or Marked Route <p>RAILROADS</p> <ul style="list-style-type: none"> Railroad (Any Number of Tracks Used by a Single Operating Company or by Trains of Another Carrier Under Trackage Rights) Railroad in Jurisdiction (Two or More Tracks of Separately Operated Companies on Adjacent Rights-of-Way) Abandoned Railroad (Track Retained) Railroad Station <p>Grade Crossing</p> <ul style="list-style-type: none"> Railroad Above Railroad Below Railroad Bridge <p>AIRWAYS AND AIRPORTS</p> <ul style="list-style-type: none"> Military Field (Some Facilities Available) Airport Complete Facilities (Commercial or Municipal) Adapted Limited Facilities Landing Area or Strip (Including Private Air Fields) Airway Light Station, General Airport, General <p>NAVIGATION</p> <ul style="list-style-type: none"> Navigable Stream (Non-perennial navigation) <p>DRAINAGE</p> <ul style="list-style-type: none"> Intermittent Stream (Narrow) Intermittent Stream (Wide) Narrow Stream Wide Stream Drainage Ditch Irrigation Ditch Lake, Reservoir, or Pond Lake, Reservoir, or Pond With Dam Dry, Lake Subject to Flood Marsh or Swamp Land Overflow Land <p>STRUCTURES</p> <ul style="list-style-type: none"> Highway Bridge, General Total Span Greater Than 20 Feet Small Bridges Closely Spaced <p>Bridges for Long River Crossings</p> <ul style="list-style-type: none"> General Arch Truss or Gable (w/ wood + steel) Chain-link Bridge Highway Grade Separation <p>Miscellaneous Structures</p> <ul style="list-style-type: none"> Levee Or Dike Levee Or Dike With Road Concrete Ford Or Dike Ford Road Established Cattle Guard Gate Across Road (Any Type) <p>BOUNDARIES</p> <ul style="list-style-type: none"> State County Corporate Lines Boundary Lines Established For Limited Urban Places Section Line Boundary To Mark Entanglement Inset Park and Other Reservations National, State, County or Municipal Park, Indian Reservation, National Monument, Federal Development Project Monument—Small, Historic Site <p>CITY AND VILLAGE CENTERS</p> <ul style="list-style-type: none"> State Capital County Seat Other Cities and Villages Incorporated City or Village Boundary Lines Fixed for Special Taxing Areas and Other Unincorporated Urban Places Defined <p>NATURAL FEATURES</p> <ul style="list-style-type: none"> Prominent Elevation—With Name Humulus Indicate Elevation Above Sea Level Sink or Depression 	<p>CONSERVATION AND RECREATION</p> <ul style="list-style-type: none"> Picnic Ground Playground, Ball Field, Etc. Bathing Beach or Swimming Pool Scenic Site Camp Site, No Permanence (Tents or Trailer Parking) Tourist Court or Motel (Figure Indicates Number of Permanent Cabins or Cottages) Camp or Lodge (Permanent Site With Building) Small Park (SP State, CP County) Fish Hatchery Municipal, SR Safety Rest Area Game Sanctuary Game Farm Game Preserve Rifle Club Golf Ground or Country Club Riding Academy Yacht Club Amusement Park or Hall Fair Ground, Race Course, Speedway Drive-In Theatre Marine Rodeo Grounds Guide House or Gate House (Add Letters N or S to Indicate National or State Park) <p>FARM UNITS, DWELLINGS, ETC.</p> <ul style="list-style-type: none"> Farm Unit Dwelling (Other Than Farm) Rows or Groups of Dwellings Closely Spaced (Figure Denotes Number of Dwellings) Combined Dwelling and Store Dwelling and Post Office Dwelling and Filing Station Dwelling, Business, and Filing Station Tenant House Seasonal or Summer Colony Dwelling Hotel Humane Society Quarters Church or Other Religious Institution Church and School (Joint Use) Cemetery Church With Cemetery Adjacent Fresh Air Farm or Rest Home Hospital Well State Port of Entry or Weight Station Group of Mead Cultural Features Closely Spaced (Figure Above Bar Indicates Number of Dwellings Included in the Group. Figures Over Individual Units Show Number of Each Included Regardless of Order) <p>INDUSTRIAL</p> <ul style="list-style-type: none"> Store or Small Business Establishment Business and Filing Station Business, Filing Station, and Post Office Factory or Industrial Plant Mine Shaft or Drift (Any Kind) Oil or Gas Well Oil or Gas Field Storage Tank (Gas or Oil Figure Denotes Number of Tanks) Filing Station (Not Connected With Other Business) Pumping Station (Oil or Gas) Gauging or Pumping Station (General) Yard House Seasonal Industry (Cannery or Small Grain Mill) Milk Depot, Creamery or Cheese Factory Fruit or Nut Orchard Fruit or Produce Picking House Road Stand Farm Products Sales Warehouse—General (If Government Add State or U.S.) Gran Elevator Group of Gran Storage Bins Greenhouse Nursery Stock Yard/Leading Pen or Corral Stock Pen at Railroad Siding (Small) Gravel Pit Quarry Kiln or Oven (Lime, Clay Products, Coke, Etc.) Feed Lot Shipping Center Seasonal Business Sawmill (Stationary) <p>EDUCATIONAL AND CORRECTIONAL INSTITUTIONS</p> <ul style="list-style-type: none"> Schoolhouse Consolidated or Large School Township, Grade or Community Hall Agricultural Experiment Station Correctional Institution Museum—General Public Library <p>PUBLIC SERVICE FACILITIES</p> <ul style="list-style-type: none"> Post Office Highway Garage Fire Engine House Garbage or Rubbish Dump Sewage Disposal Plant Auto Salvage Yard Transformer Station Power Plant Power Substation Boiler Station Water Supply, Stand Pipe, or Tank Radio Station (With Call Letters) Radio Range Station Water Treatment Plant Jury Box U. S. Corps of Engineers Office <p>MISCELLANEOUS</p> <ul style="list-style-type: none"> Fort, Army Camp, Barracks, or Other Military Post Transpiration Station Bench Mark (With Elevation)
---	--

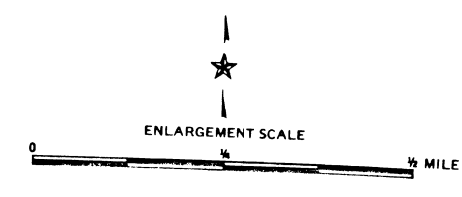
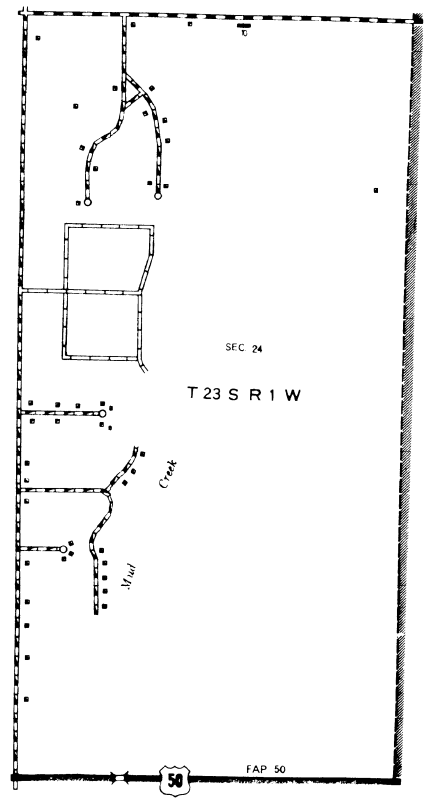
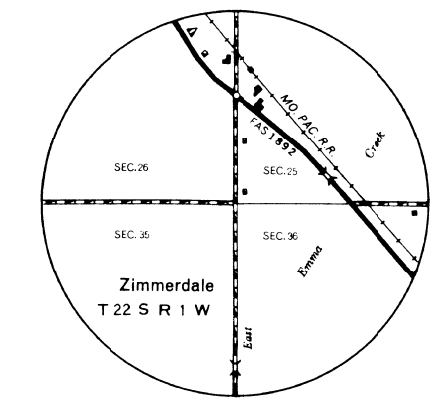
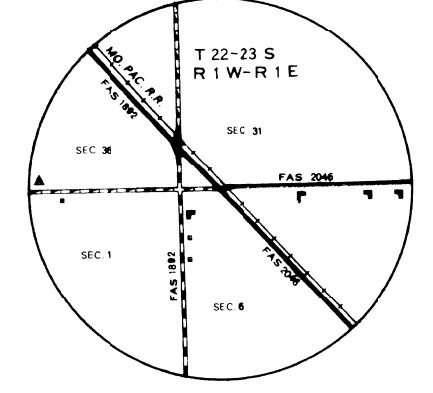
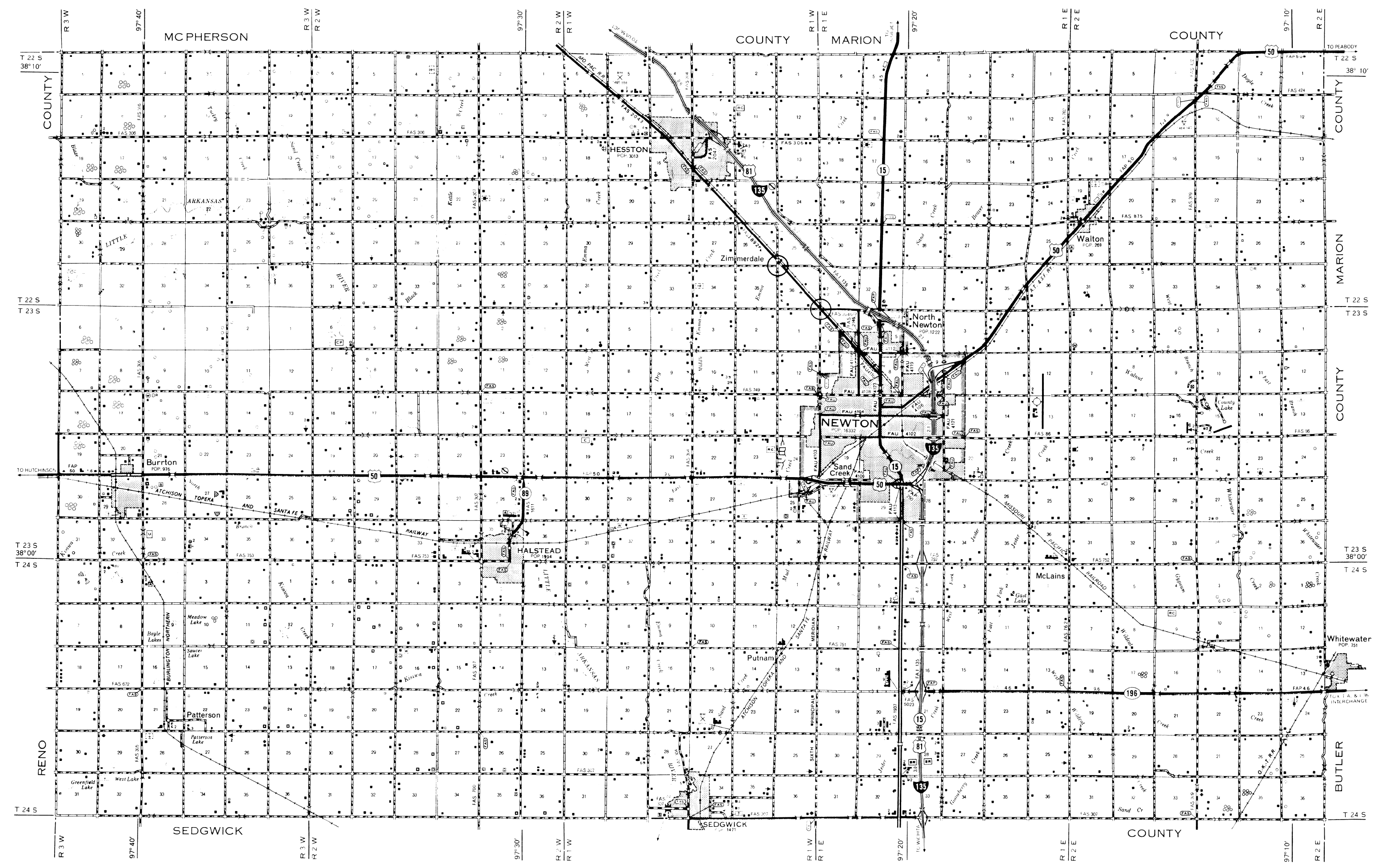

**GENERAL HIGHWAY MAP
HARVEY COUNTY
KANSAS**

PREPARED BY THE
KANSAS DEPARTMENT OF TRANSPORTATION
BUREAU OF TRANSPORTATION PLANNING
IN COOPERATION WITH THE
U. S. DEPARTMENT OF TRANSPORTATION
FEDERAL HIGHWAY ADMINISTRATION

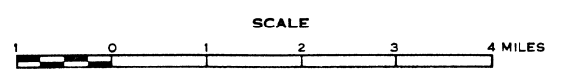

1982
POLYCONIC PROJECTION

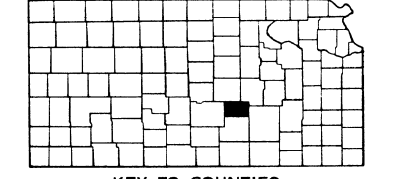

BOUNDARY COMPLETED BY
F. A. AND STATE
SYSTEMS REVISED TO

HIGHWAY CONTROL MARKED BY
U. S. HIGHWAY DEPARTMENT