

ROADS AND ROADWAY FEATURES		CONSERVATION AND RECREATION	
PRIMITIVE ROAD	PICNIC GROUND
UNIMPROVED ROAD	PLAYGROUND, BALL FIELD, ETC.
GRADED AND DRAINED ROAD	BATHING BEACH OR SWIMMING POOL
SOIL SURFACED ROAD	SCENIC SITE
GRAVEL OR STONE ROAD	CAMP SITE, NO PERMANENCE (TRAILS OR TRAILER PARKS)
NOT GRADED OR DRAINED	CAMP OR LODGE (WITH OR WITHOUT PERMANENCE)
GRAVEL OR STONE ROAD	SMALL PARK
GRADED AND DRAINED	FISH HATCHERY
GRAVEL OR STONE ROAD WITH STABILIZED SURFACE	HIDE SANCTUARY
BITUMINOUS ROAD-LOW TYPE	GAME PRESERVE
DIVIDED HIGHWAY	GAME FARM
SIDE ROADS AND STREETS IN URBAN	RIFLE CLUB
PORTED URBAN COMPACTS AND EXTENSIONS OF LOCAL ROADS WITHIN MUNICIPALITIES	GOLF GROUND OR COUNTRY CLUB
PRIVATE ROAD	FOLD GROUNDS
PROJECTED ROAD	YACHT CLUB
ROAD SYSTEM DESIGNATION		AMUSEMENT PARK OR HALL	
FEDERAL-AID PRIMARY HIGHWAY SYSTEM	FAIR GROUND, RACE COURSE, SPEEDWAY
FEDERAL-AID SECONDARY HIGHWAY SYSTEM	DRIVE-IN THEATRE
FEDERAL-AID URBAN HIGHWAY SYSTEM	FARM UNITS, DWELLINGS, ETC.	
STATE-AID ROAD	FARM UNIT
POINTS BETWEEN WHICH DISTANCES ARE MEASURED INDICATED THUS		DWELLING OTHER THAN FARM
TRAFFIC CIRCLE	POWERS OR GROUPS OF DWELLINGS CLOSELY SPACED
CLOVER LEAF	COMBINED DWELLING AND STORE
U.S. NUMBERED HIGHWAY	DWELLING AND POST OFFICE
STATE HIGHWAY SYSTEM OR STATE NUMBERED HIGHWAY	DWELLING BUSINESS AND FILLING STATION
END OF DESIGNATED SYSTEM OR MARKED ROUTE	TENANT HOUSE
RAILROADS		SEASONAL OR SUMMER COLONY DWELLING
RAILROAD IN JUNCTION	HOTEL, INN
RAILROAD IN JUNCTION (WITH BRIDGE)	CHURCH OR OTHER RELIGIOUS INSTITUTION
NARROW GAUGE RAILROAD	CHURCH AND SCHOOL
ELECTRIC INTERURBAN OR SUBURBAN RAILROAD	CEMETERY
ABANDONED RAILROAD	CHURCH WITH CEMETERY ADJACENT
ABANDONED ELECTRIC LINE	HOSPITAL
RAILROAD STATION	STATE PORT OF ENTRY OR WEIGHT STATION
RAILROAD CROSSINGS		GROUP OF MIXED CULTURAL FEATURES CLOSELY SPACED
RAILROAD ABOVE	INDUSTRIAL
RAILROAD BELOW	STORE OR SMALL BUSINESS ESTABLISHMENT
RAILROAD BRIDGE	BUSINESS AND POST OFFICE
RAILROADS ON STREETS OR ROADS		BUSINESS FILING STATION
STANDARD GAUGE RAILROAD	FACTORY OR INDUSTRIAL PLANT
ELECTRIC RAILROAD	MINE-SHAFT OR DRIFT
AIRWAYS AND AIRPORTS		OIL OR GAS WELL
AIR ROUTE	OIL OR GAS FIELD
MILITARY FIELD	OIL TANK
AIRPORT, COMPLETE FACILITIES (COMMERCIAL OR MILITARY)	GAS TANK
AIRPORT, LIMITED FACILITIES	GROUP OF STORAGE TANKS
LANDING AREA OR STRIP (INCLUDING PRIVATE AIR FIELDS)	FILLING STATION (WITH CONNECTION TO OTHER SERVICES)
AIRWAY LIGHT BEACON, GENERAL	PUMPING STATION (OIL OR GAS)
AIRPORT-GENERAL	GAUGING OR PUMPING STATION (GENERAL)
NAVIGATION		SEASONAL INDUSTRY (CANNERY OR SMALL MEAT HULL)
NAVIGABLE STREAM	MILK DEPOT, CREAMERY OR CHEESE FACTORY
DRAINAGE		FRUIT OR NUT ORCHARD
INTERMITTENT STREAM	ROAD STAND FARM PRODUCTS SALES
INTERMITTENT STREAM	WAREHOUSE-GENERAL (IF EXHIBITED WITH SIGN)
NARROW STREAM	GRAIN ELEVATOR
WIDE STREAM	GREENHOUSE
DRAINAGE DITCH	NURSERY
IRRIGATION DITCH	STOCK YARD-LOADING PEN OR CORRAL
LAKE, RESERVOIR, OR POND	STOCK PEN AT RAILROAD SIDING
LAKE, RESERVOIR, OR POND WITH DAM	GRAVEL PIT
DRY LAKE SUBJECT TO FLOOD	QUARRY
MARSH OR SWAMP LAND	KILN OR OVEN (LIME, CLAY, BRICKS, ETC.)
OVERFLOW LAND	EDUCATIONAL AND CORRECTIONAL INSTITUTIONS	
STRUCTURES		SCHOOLHOUSE
HIGHWAY BRIDGE-PENNS.	CONSOLIDATED OR LARGE SCHOOL
SMALL BRIDGES CLOSELY SPACED	TOWNHALL, GRANGE, OR COMMUNITY HALL
GENERAL	AGRICULTURAL EXPERIMENT STATION
ARCH	COUNTY FARM
TRUSS OR GIRDER	CORRECTIONAL INSTITUTION
CANTILEVER BRIDGE	PUBLIC SERVICE FACILITIES	
COVERED BRIDGE	POST OFFICE
HIGHWAY GRADE SEPARATION	HIGHWAY GARAGE
MISCELLANEOUS STRUCTURES		FIRE ENGINE HOUSE
DAM WITH DIKE	GARBAGE OR RUBBISH DUMP
LEVEE OR DIKE WITH ROAD	SEWAGE DISPOSAL PLANT
CONCRETE FORD OR FORD-ROAD ESTABLISHED	WATER SUPPLY, STAND PIPE, OR TANK
CATTLE GUARD	PIPE LINE-GAS
GATE ACROSS ROAD	PIPE LINE-OIL
BOUNDARIES		PIPE LINE-PRODUCTS
STATE	TRANSMISSION LINE, WITH TRANSFORMER STATION
COUNTY	POWER PLANT
CORPORATE LINES	POWER SUBSTATION
BOUNDARY LINES ESTABLISHED FOR DELIMITED URBAN PLACES	BOOSTER STATION
SECTION LINE	UNDERGROUND TELEPHONE OR RADIO CABLE
MATCH LINE BETWEEN ADJOINING SHEETS OF SAME COUNTY	RADIO STATION (WITH CALL LETTERS)
BOUNDARY LINE BETWEEN ADJOINING COUNTIES	RADIO RANGE STATION
INDIAN RESERVATION, NATIONAL MONUMENT, FEDERAL DEVELOPMENT PROJECT	MISCELLANEOUS	
CITY AND VILLAGE CENTERS		FORT, ARMY CAMP, BARRACKS, OR OTHER MILITARY POST
STATE CAPITAL	TRANSMISSION STATION
COUNTY SEAT	BENCH MARK (WITH ELEVATION)
OTHER CITIES AND VILLAGES	NATURAL FEATURES	
INCORPORATED CITY OR VILLAGE	PROMINENT ELEVATION WITH NAME
BOUNDARY LIMITS FIXED FOR SPECIAL TAXING AREAS AND OTHER UNINCORPORATED URBAN PLACES DELIMITED	SINK OR DEPRESSION

GENERAL HIGHWAY MAP JEFFERSON COUNTY KANSAS

PREPARED BY THE
STATE HIGHWAY COMMISSION OF KANSAS
HIGHWAY PLANNING DEPARTMENT
IN COOPERATION WITH THE
U. S. DEPARTMENT OF COMMERCE
BUREAU OF PUBLIC ROADS

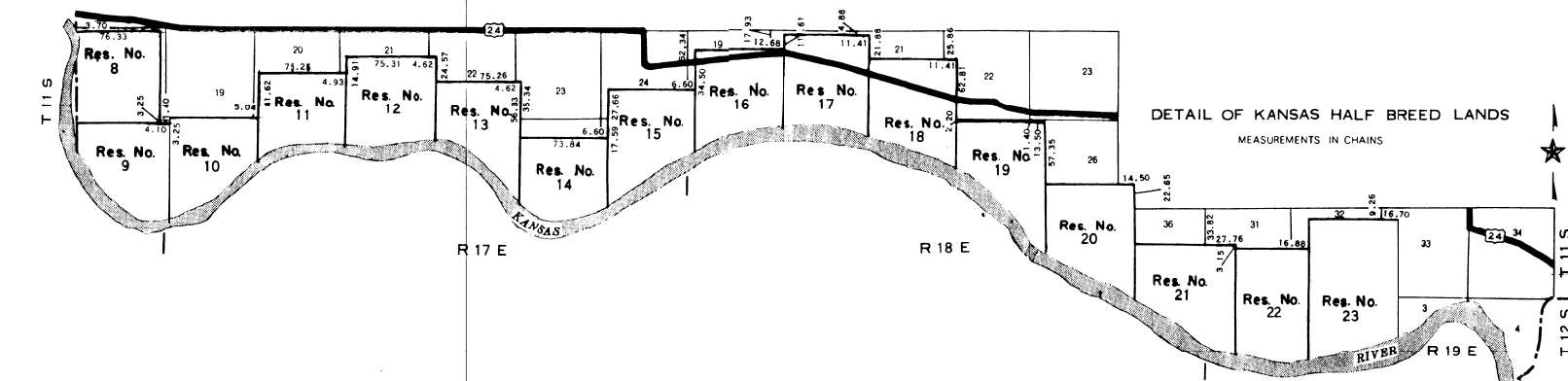
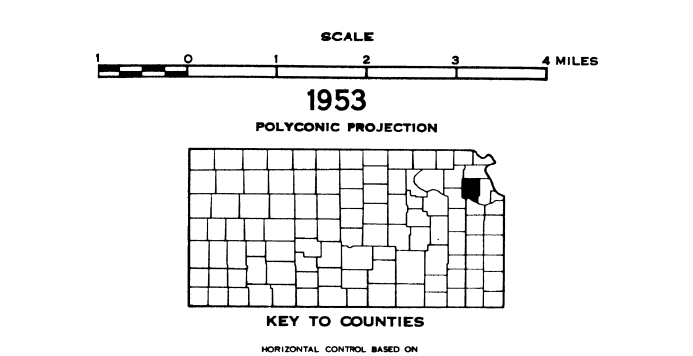

Dunavant
T 9 S R 19 E

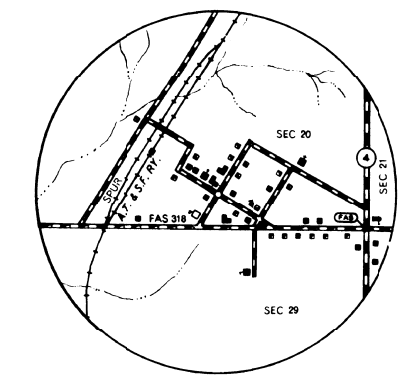

Rock Creek
T 9 S R 17 W

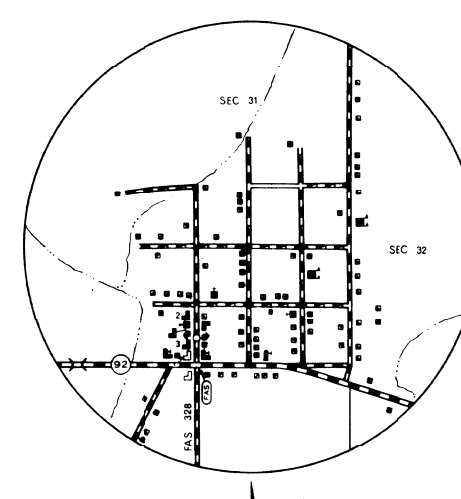

Ozawie
T 9 S R 18 E

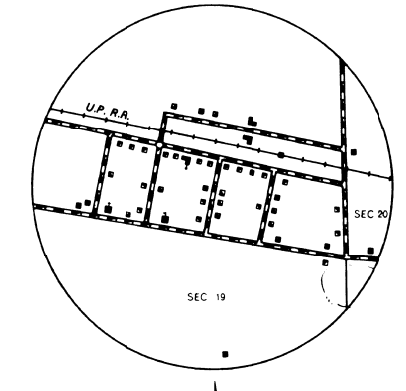

Grantville
T 11 S R 11 E

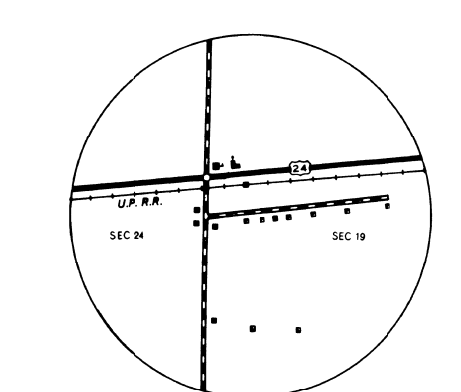

Newman
T 11 S R 18 E

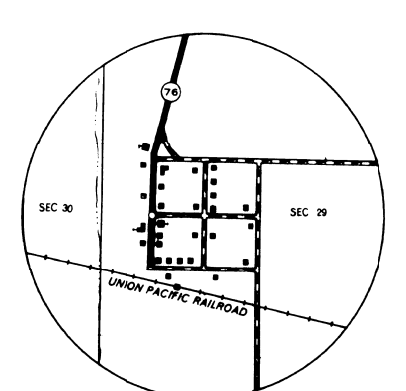

Williamstown
T 11 S R 19 E

ENLARGEMENT SCALE
1 MILE

REPRODUCED FROM THE ORIGINAL MAP BY THE BUREAU OF PUBLIC ROADS, U. S. DEPARTMENT OF COMMERCE