

Wilder
T 11-12 S R 23 E

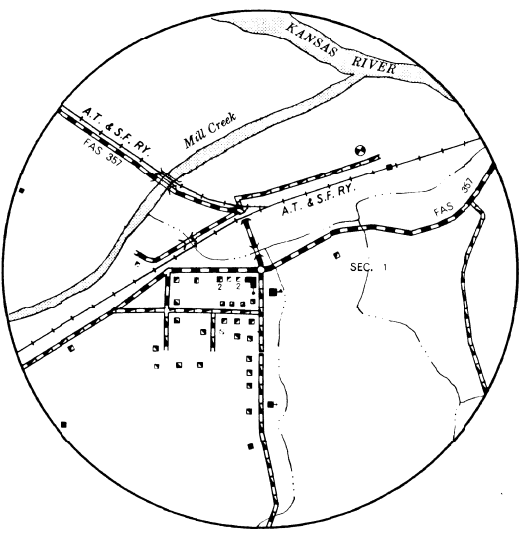

Holliday
T 12 S R 23 E

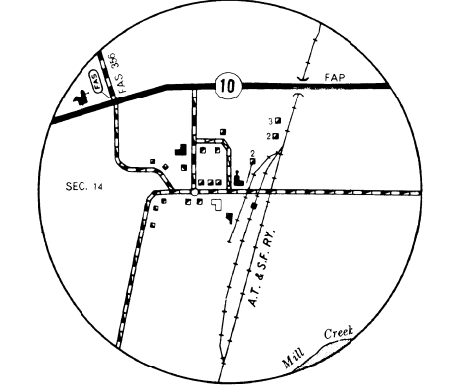

Zarah
T 12 S R 23 E

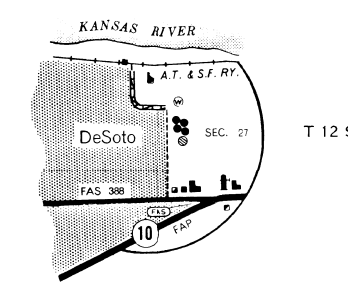

DeSoto
T 12 S R 22 E

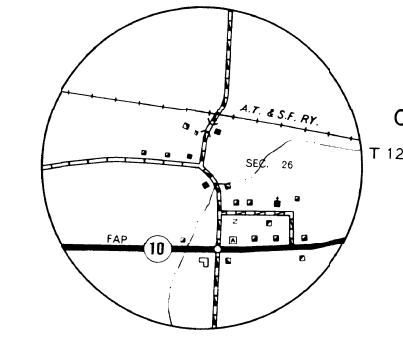

Cedar
T 12 S R 22 E

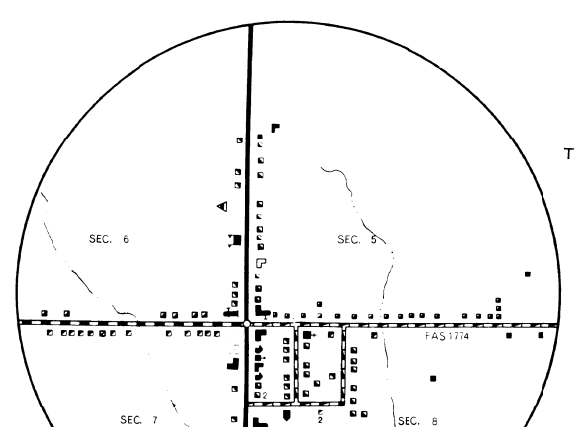

Stanley
T 14 S R 25 E

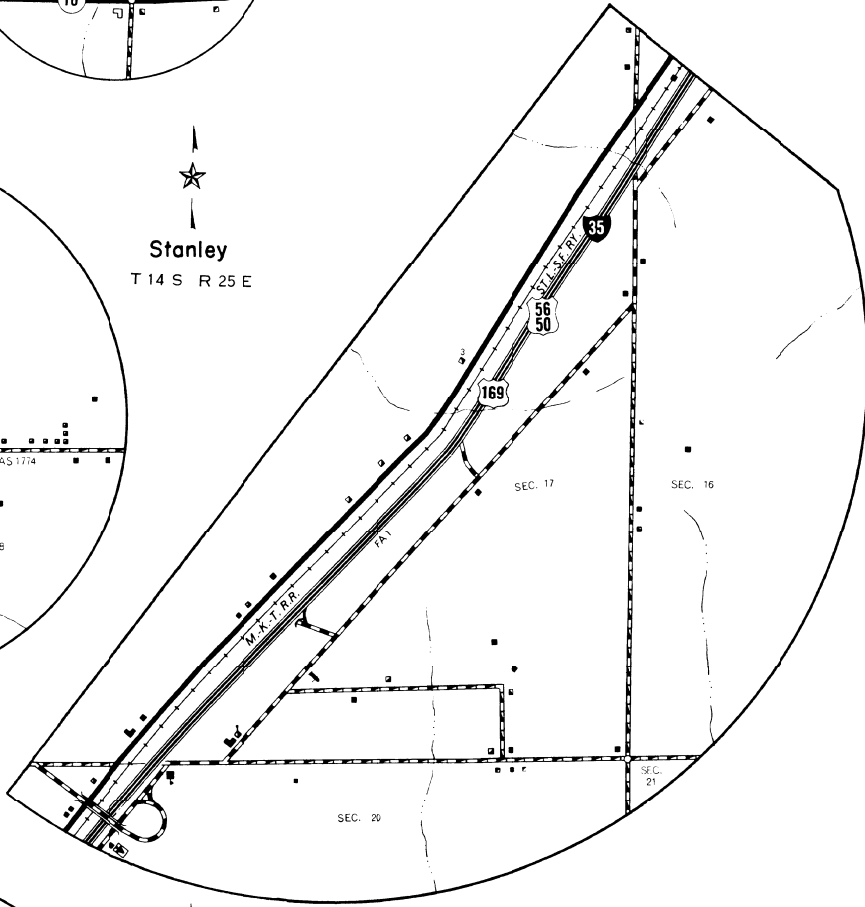

Lackmans
T 13 S R 24 E

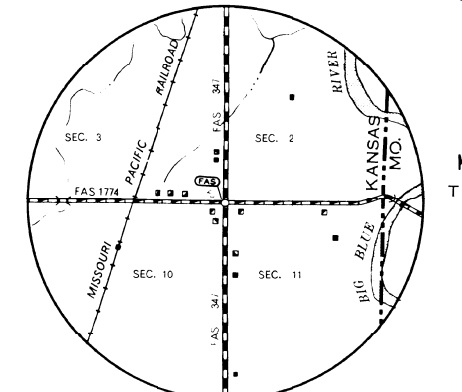

Kenneth
T 14 S R 25 E

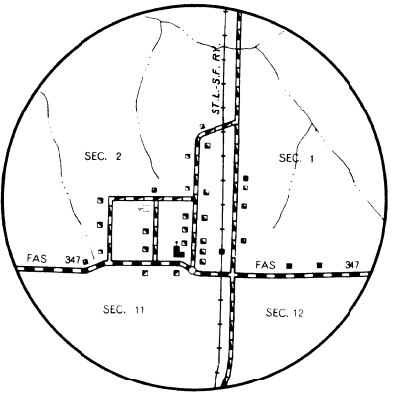

Ocheltree
T 15 S R 23 E

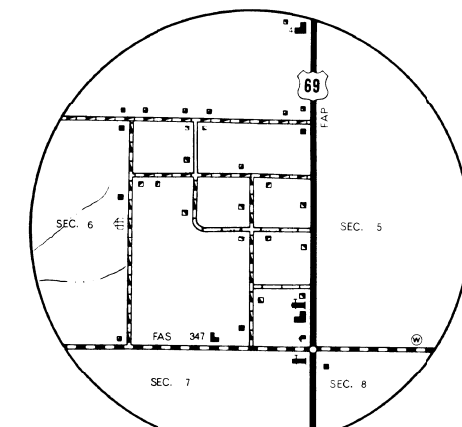

Aubry
T 15 S R 25 E

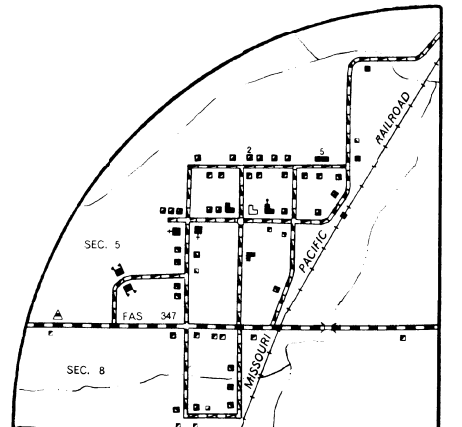

Shiwell
T 15 S R 25 E

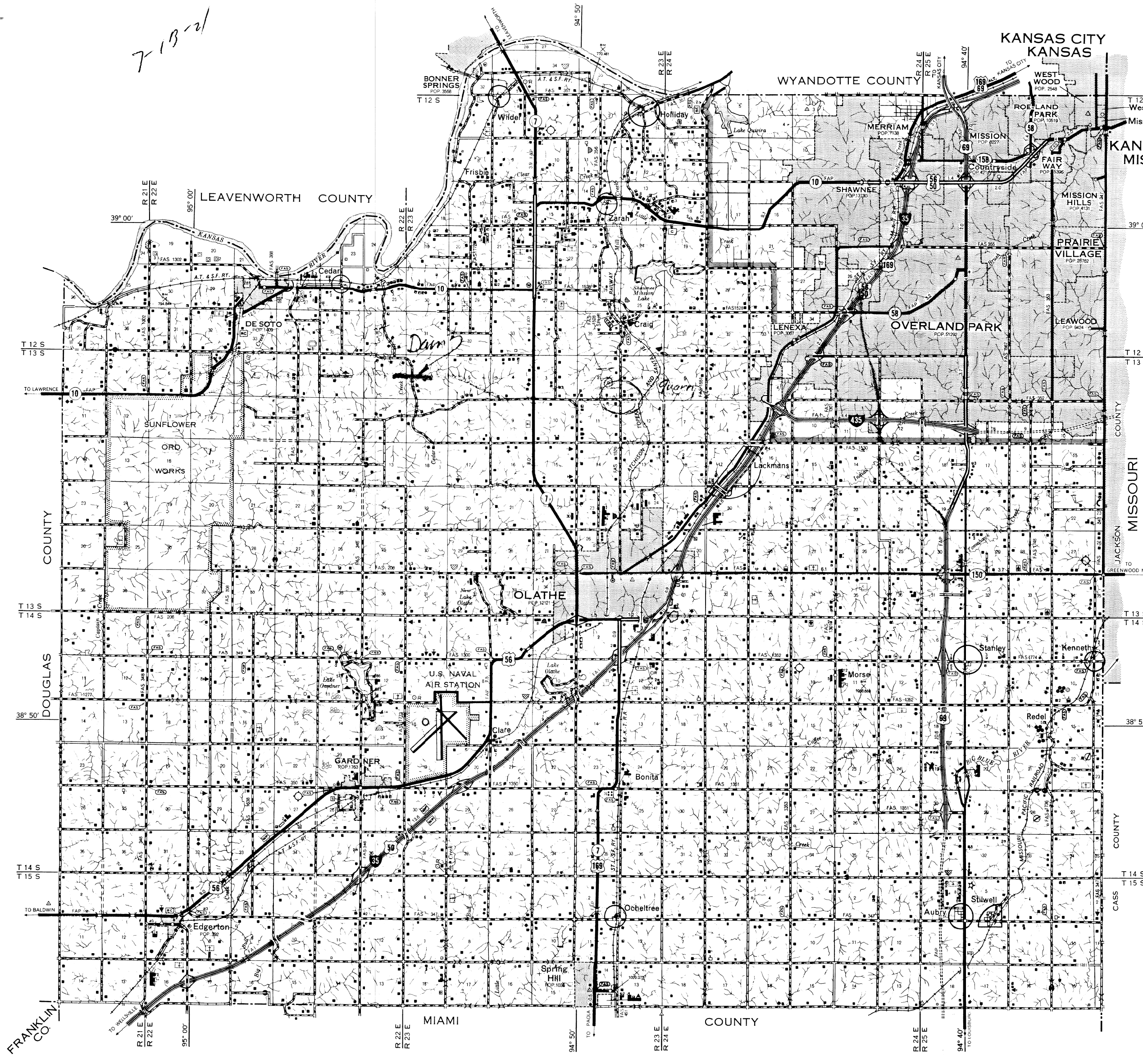

LEGEND

ROADS AND ROADWAY FEATURES		CONSERVATION AND RECREATION	
PRIMITIVE ROAD	UNIMPROVED ROAD	PICNIC GROUND	PLAYGROUNDS, BALL FIELD, ETC.
GRADED AND DRAINED ROAD	GRAVEL OR STONE ROAD	BATHING BEACH OR SWIMMING POOL	SCENIC SITE
SOIL SURFACED ROAD	NOT GRADED OR DRAINED	CAMP SITE, NO PERMANENCE	CAMP SITE, WITH PERMANENCE
GRAVEL OR STONE ROAD	GRADED AND DRAINED	TOURIST COURT OR MOTEL	CAMP OR LODGE
GRAVEL OR STONE ROAD WITH STABILIZED SURFACE	BITUMINOUS ROAD	SMALL PARK	FISH HATCHERY
PAVED ROAD	DIVIDED HIGHWAY	GAME FARM	BIRD SANCTUARY
HIGHWAY WITH FULL CONTROL OF ACCESS	SIDE ROADS AND STREETS IN UNINCORPORATED URBAN COMPACTS AND EXTENSIONS OF LOCAL ROADS WITHIN MUNICIPALITIES	GOLF GROUND OR COUNTRY CLUB	GAME PRESERVE
PRIVATE ROAD	PROJECTED ROAD	RIFLE CLUB	POLO GROUNDS
		BOATING ACADAMY	YACHT CLUB
		AMUSEMENT PARK OR HALL	FAIR GROUND, RACE COURSE, SPEEDWAY
		DRIVE-IN THEATRE	
ROAD SYSTEM DESIGNATION		FARM UNITS, DWELLINGS, ETC.	
FEDERAL-AID INTERSTATE HIGHWAY SYSTEM	FEDERAL-AID PRIMARY HIGHWAY SYSTEM	FARM UNIT	DWELLING - OTHER THAN FARM
FEDERAL-AID SECONDARY HIGHWAY SYSTEM	POINTS BETWEEN WHICH DISTANCES ARE MEASURED INDICATED THUS	ROWS OR GROUPS OF DWELLINGS CLOSELY SPACED	COMBINED DWELLING AND STORE
INTERSTATE NUMBERED HIGHWAY	STATE NUMBERED HIGHWAY	DWELLING AND FILLING STATION	DWELLING, BUSINESS, AND FILLING STATION
STATE HIGHWAY SYSTEM OR STATE NUMBERED HIGHWAY	END OF DESIGNATED SYSTEM OR MARKED ROUTE	TENANT HOUSE	SEASONAL OR SUMMER COLONY DWELLING
		HOTEL, INN	CHURCH OR OTHER RELIGIOUS INSTITUTION
		CHURCH AND SCHOOL	CEMETERY
		CHURCH WITH CEMETERY ADJACENT	FRESH AIR FARM OR REST HOME
		HOSPITAL	WELL
		STATE POINT OF ENTRY OR WEIGHT STATION	STATE POINT OF ENTRY OR WEIGHT STATION
		RAILROAD	RAILROAD
		RAILROAD STATION	RAILROAD STATION
		RAILROAD CROSSINGS	RAILROAD CROSSINGS
		RAILROAD BRIDGE	RAILROAD BRIDGE
		AIR ROUTE	AIR ROUTE
		AIRPORT, COMPLETE FACILITIES	AIRPORT, COMPLETE FACILITIES
		AIRFIELD, LIMITED FACILITIES	AIRFIELD, LIMITED FACILITIES
		LANDING AREA OR STRIP	LANDING AREA OR STRIP
		AIRPORT - GENERAL	AIRPORT - GENERAL
		NAVIGABLE STREAM	NAVIGABLE STREAM
		INTERMITTENT STREAM	INTERMITTENT STREAM
		WIDE STREAM	WIDE STREAM
		IRIGATION DITCH	IRIGATION DITCH
		LAKE, RESERVOIR OR POND	LAKE, RESERVOIR OR POND
		LAKE, RESERVOIR OR POND WITH DAM	LAKE, RESERVOIR OR POND WITH DAM
		DRY LAKE SUBJECT TO FLOOD	DRY LAKE SUBJECT TO FLOOD
		MARSH OR SWAMP LAND	MARSH OR SWAMP LAND
		OVERFLOW LAND	OVERFLOW LAND
		STRUCTURES	STRUCTURES
		HIGHWAY BRIDGE	HIGHWAY BRIDGE
		TRUSS OR GIRDER	TRUSS OR GIRDER
		CANTILEVER BRIDGE	CANTILEVER BRIDGE
		COVERED BRIDGE	COVERED BRIDGE
		HIGHWAY GRADE SEPARATION	HIGHWAY GRADE SEPARATION
		MISCELLANEOUS STRUCTURES	MISCELLANEOUS STRUCTURES
		DAM WITH ROAD	DAM WITH ROAD
		LEVEE OR DIKE WITH ROAD	LEVEE OR DIKE WITH ROAD
		CONCRETE FORD OR DIP	CONCRETE FORD OR DIP
		FORD-ROAD ESTABLISHED	FORD-ROAD ESTABLISHED
		CATTLE GUARD	CATTLE GUARD
		GATE ACROSS ROAD	GATE ACROSS ROAD
		BOUNDARIES	BOUNDARIES
		STATE	STATE
		COUNTY	COUNTY
		CORPORATE LINE	CORPORATE LINE
		BOUNDARY LINES ESTABLISHED FOR DELIMITED URBAN PLACES	BOUNDARY LINES ESTABLISHED FOR DELIMITED URBAN PLACES
		SECTION LINE	SECTION LINE
		MATCH LINE BETWEEN ADJOINING SHEETS OF SAME COUNTY	MATCH LINE BETWEEN ADJOINING SHEETS OF SAME COUNTY
		BOUNDARY TO MARK ENLARGEMENT INSET	BOUNDARY TO MARK ENLARGEMENT INSET
		PARKS AND OTHER RESERVATIONS NATIONAL	PARKS AND OTHER RESERVATIONS NATIONAL
		STATE, COUNTY OR MUNICIPAL PARK	STATE, COUNTY OR MUNICIPAL PARK
		INDIAN RESERVATION, NATIONAL MONUMENT, FEDERAL DEVELOPMENT PROJECT	INDIAN RESERVATION, NATIONAL MONUMENT, FEDERAL DEVELOPMENT PROJECT
		MONUMENT - SMALL HISTORIC SITE	MONUMENT - SMALL HISTORIC SITE
		CITY AND VILLAGE CENTERS	CITY AND VILLAGE CENTERS
		STATE CAPITAL	STATE CAPITAL
		COUNTY SEAT	COUNTY SEAT
		OTHER CITIES AND VILLAGES	OTHER CITIES AND VILLAGES
		INCORPORATED CITY OR VILLAGE	INCORPORATED CITY OR VILLAGE
		BOUNDARY LIMITS FIXED FOR SPECIAL TAXING AREAS AND OTHER UNINCORPORATED URBAN PLACES DELIMITED	BOUNDARY LIMITS FIXED FOR SPECIAL TAXING AREAS AND OTHER UNINCORPORATED URBAN PLACES DELIMITED
		POST OFFICE	POST OFFICE
		FIRE ENGINE HOUSE	FIRE ENGINE HOUSE
		GARBAGE OR RUBBISH DUMP	GARBAGE OR RUBBISH DUMP
		SEWAGE DISPOSAL PLANT	SEWAGE DISPOSAL PLANT
		AUTO SALVAGE YARD	AUTO SALVAGE YARD
		TRANSFORMER STATION	TRANSFORMER STATION
		POWER PLANT	POWER PLANT
		BOOSTER STATION	BOOSTER STATION
		WATER SUPPLY, STAND PIPE, OR TANK	WATER SUPPLY, STAND PIPE, OR TANK
		RADIO STATION	RADIO STATION
		RADIO RANGE STATION	RADIO RANGE STATION
		MISCELLANEOUS	MISCELLANEOUS
		FORT, ARMY CAMP, BARRACKS, OR OTHER MILITARY POST	FORT, ARMY CAMP, BARRACKS, OR OTHER MILITARY POST
		TRIANGULATION STATION	TRIANGULATION STATION
		BENCH MARK	BENCH MARK
		NATURAL FEATURES	NATURAL FEATURES
		PROMINENT ELEVATION, WITH NAME	PROMINENT ELEVATION, WITH NAME
		SINK OR DEPRESSION	SINK OR DEPRESSION

GENERAL HIGHWAY MAP
JOHNSON COUNTY
KANSAS
 PREPARED BY THE
 STATE HIGHWAY COMMISSION OF KANSAS
 PLANNING AND RESEARCH DEPARTMENT
 IN COOPERATION WITH THE
 U. S. DEPARTMENT OF COMMERCE
 BUREAU OF PUBLIC ROADS

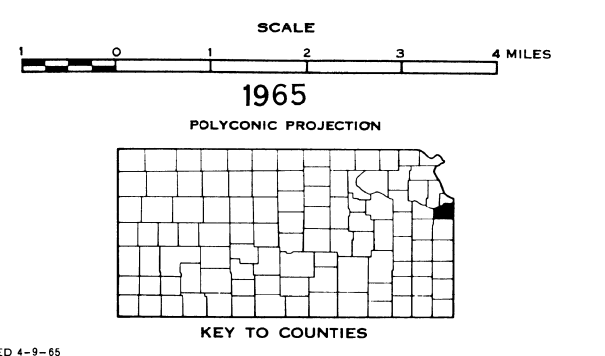

DRAINAGE DELINEATED FROM AERIAL PHOTOGRAPHS

INVENTORY COMPLETED 4-3-55
 P. A. AND DATE SYSTEMS REVISID TO 3-23-55
 HORIZONTAL CONTROL BASED ON U.S. COAST AND GEOD. SURVEY SYSTEMS REVISID TO 3-23-55