

LEGEND

<p>ROADS AND ROADWAY FEATURES</p> <ul style="list-style-type: none"> Primitive Road (Type A) Unimproved Road (Type B) Graded and Drained Road (Type C) Seal Surfaced Road (Type D) Gravel or Stone Road Not Graded or Drained (Type E-1) Graded and Drained (Type E-2) Gravel or Stone Road With Stabilized Surface (Type E-3) Blumhouse Road—Low Type (Type F, G-1, H-1) Road Road (Type G-2, H-2, I, J, K, L) Dotted Highway Highway With Full Control of Access Side Roads and Streets in Unincorporated Urban Compacts and Extensions of Local Roads Within Municipalities 4 Lane Undivided Highway Projected Road <p>Road System Designation</p> <ul style="list-style-type: none"> Federal-Aid Interstate Highway System Federal-Aid Primary Highway System Federal-Aid Secondary Highway System Federal-Aid Urban Highway System Points Between Which Distances are Measured Interstate Numbered Highway U.S. Numbered Highway State Highway System or End of Designated System or Marked Route <p>RAILROADS</p> <ul style="list-style-type: none"> Railroad (Any Number of Tracks Used by a Single Operating Company or by Trains of Another Carrier Under Trackage Rights) Railroads in Jurisdiction of Two or More Tracks of Separately Operated Companies on Adjacent Rights-of-Way Abandoned Railroads (Track Retained) Railroad Station <p>Railroad Crossing</p> <ul style="list-style-type: none"> Grade Crossing Railroad Above Railroad Below Railroad Bridge <p>AIRWAYS AND AIRPORTS</p> <ul style="list-style-type: none"> Military Field (Some Facilities Available) Airport Complete Facilities (Commercial or Municipal) Airfield, Limited Facilities Landing Area or Strip (Including Private Air Fields) Always Light Beacon, General Aspen, General <p>NAVIGATION</p> <ul style="list-style-type: none"> Navigable Stream (Not in permanent navigation) <p>DRAINAGE</p> <ul style="list-style-type: none"> Intermittent Stream (Narrow) Intermittent Stream (Wide) Narrow Stream Wide Stream Drainage Ditch Irrigation Ditch Lake, Reservoir or Pond Lake, Reservoir or Pond With Dam Dry Lake Subject To Flood Marsh or Swamp Land Overflow Land <p>STRUCTURES</p> <ul style="list-style-type: none"> Highway Bridge, General Total Span Greater Than 20 Feet Small Bridges Closely Spaced <p>Bridges For Long River Crossings</p> <ul style="list-style-type: none"> General Arch Truss or Girder (w. wood s. steel) Cantilever Bridge Highway Grade Separation <p>Miscellaneous Structures</p> <ul style="list-style-type: none"> Levee Or Dike Levee Or Dike With Road Concrete Foot Or Di Foot-Road Established Cattle Guard Gate Across Road (Any Type) <p>BOUNDARIES</p> <ul style="list-style-type: none"> State County Corporate Lines Boundary Lines Established For Delimited Urban Places Section Line Boundary Mark Entanglement Inset Parks and Other Reservations National, State, County, or Municipal Park, Indian Reservation, National Monument, Federal Development Project Monument—Small, Historic Site Other Unincorporated Urban Places <p>CITY AND VILLAGE CENTERS</p> <ul style="list-style-type: none"> State Capital County Seat Other Cities and Villages Incorporated City or Village Boundary Limits Fixed for Special Taxing Areas and Other Unincorporated Urban Places <p>NATURAL FEATURES</p> <ul style="list-style-type: none"> Prominent Elevation—With Name Numerals Indicate Elevation Above Sea Level Sea or Depression 	<p>CONSERVATION AND RECREATION</p> <ul style="list-style-type: none"> Picnic Ground Playground, Ball Field, Etc. Bathing Beach or Swimming Pool Scenic Site Camp Site Camp Site, No Permanence (Tents or Trailer Parking) Tourist Court or Motel (Figure Indicates Number of Permanent Cabins or Cottages) Camp or Lodge (Permanent Site With Building) Small Park (SP—State, CP—County, M—Municipal, SR—State Rest Area) Fish Hatchery Best Sanctuary Game Farm Game Preserve Rifle Club Golf Course Country Club Riding Academy Yacht Club Amusement Park or Hall Fair Ground, Race Course, Speedway Drive-In Theatre Marina Rodeo Grounds Guide House or Gate House (Add Letters N or S to Indicate National or State Park) <p>FARM UNITS, DWELLINGS, ETC.</p> <ul style="list-style-type: none"> Farm Unit Dwelling (Other Than Farm) Row or Groups of Dwellings Closely Spaced (Figure Denotes Number of Dwellings) Controlled Dwelling and Store Dwelling and Post Office Dwelling and Filling Station Dwelling, Business, and Filling Station Tenish House Seasonal or Summer-Country Dwelling Hotel Humanity Society Quarters Church or Other Religious Institution Church and School (Joint Use) Cemetery Church With Cemetery Adjacent Fresh Air Farm or Rest Home Hospital WV State Port of Entry or Weight Station Group of Most Cultural Features Closely Spaced (Figure above bar indicates number of dwellings included in the group; figures over individual bars show number of each included regardless of order) <p>INDUSTRIAL</p> <ul style="list-style-type: none"> Store or Small Business Establishment Business and Post Office Business, Filling Station, and Post Office Factory or Industrial Plant Mine/Shaft or Outh (Any Kind) Oil or Gas Well Oil or Gas Field Storage Tank (Gas or Oil Figure Denotes Number of Tanks) Filling Station (Not Connected With Other Business) Pumping Station (Oil or Gas) Gauging or Pumping Station (General) Valve House Seasonal Industry (Cannery or Small Grain Mill) Milk Depot, Creamery or Cheese Factory Fruit or Nut Orchard Fruit or Product Packing House Root Stand Farm Products Sales Warehouse—General (If Government Add State or U.S.) Grain Elevator Group of Grain Storage Bins Cheesehouse Nursery Stock Yard—Loading Pen or Corral Stock Pen at Railroad Siding (Small) Quarry Mill or Oven (Lime, Clay Products, Coke, Etc.) Feed Lot Shrapnel Center Seasonal Business Sawmill (Stationary) <p>EDUCATIONAL AND CORRECTIONAL INSTITUTIONS</p> <ul style="list-style-type: none"> Schoolhouse Consolidated or Large School Townhall, Grange, or Community Hall Agricultural Experiment Station Correctional Institution Museum—General Public Library <p>PUBLIC SERVICE FACILITIES</p> <ul style="list-style-type: none"> Post Office Highway Garage Fire Engine House Garbage or Rubbish Dump Sewage Disposal Plant Auto Salvage Yard Transformer Station Power Plant Power Station Booster Station Water Station, Stand Pipe or Tank Radio Station (With Call Letters) Rails Range Station Water Treatment Plant Sanitary U.S. Corps of Engineers Office <p>MISCELLANEOUS</p> <ul style="list-style-type: none"> Fort Army Camp, Barracks, or Other Military Post Transfiguration Station Bench Mark (With Elevation)
---	---

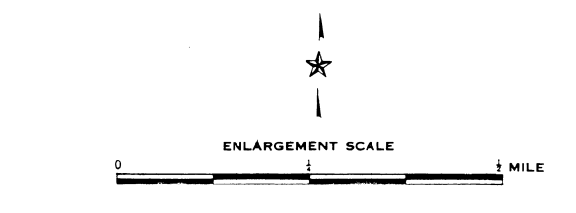
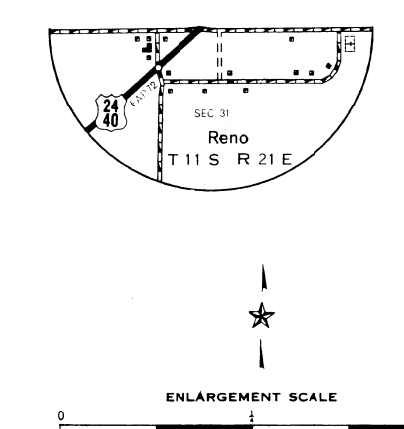
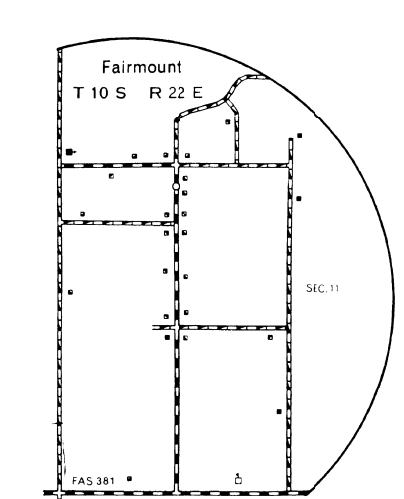
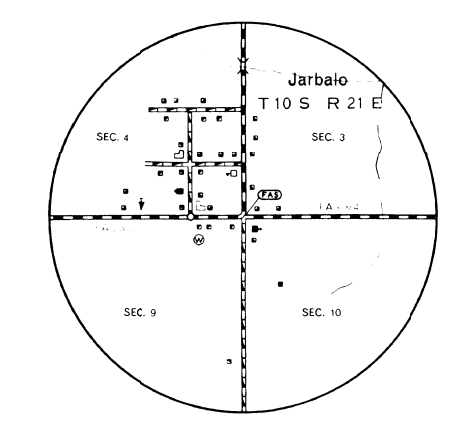

GENERAL HIGHWAY MAP LEAVENWORTH COUNTY KANSAS

PREPARED BY THE
KANSAS DEPARTMENT OF TRANSPORTATION
BUREAU OF TRANSPORTATION PLANNING
IN COOPERATION WITH THE
U.S. DEPARTMENT OF TRANSPORTATION
FEDERAL HIGHWAY ADMINISTRATION

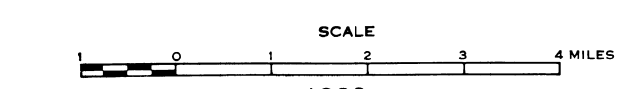

1986
POLYCONIC PROJECTION

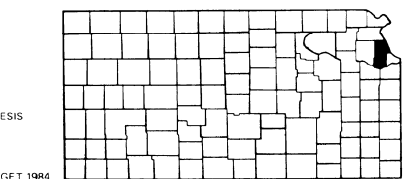

NOTE: RAILROAD NAMES IN PARENTHESIS HAS TRACKAGE RIGHTS

POPULATION - DIVISION OF THE BUREAU OF 1984

REINVENTORY COMPLETED 1985

F.A. AND STATE SYSTEMS REVISED TO 1985

HORIZONTAL CONTROL BASED ON U.S. COAST AND GEOD. SURVEY SYSTEM