

ROADS AND ROADWAY FEATURES		CONSERVATION AND RECREATION	
PRIMITIVE ROAD	.....	PICTIC GROUND	.....
UNIMPROVED ROAD	.....	PLAYGROUND, BALL FIELD, ETC.	.....
GRADED AND DRAINED ROAD	.....	BATHING BEACH OR SWIMMING POOL	.....
SOIL SURFACED ROAD	.....	SCENIC SITE	.....
GRAVEL OR STONE ROAD	.....	CAMP SITE, NO PERMANENCE ITEMS OR TRAILER PARKING	.....
NOT GRADED OR DRAINED ROAD	.....	TOURIST COURT OR MOTEL	.....
GRAVEL OR STONE ROAD	.....	CAMP OR LODGE, PERMANENT SITE WITH BUILDINGS	.....
GRAVEL OR STONE ROAD	.....	SMALL PARK	.....
GRAVEL OR STONE ROAD	.....	FISH HATCHERY	.....
GRAVEL OR STONE ROAD	.....	BIRD SANCTUARY	.....
GRAVEL OR STONE ROAD	.....	GAME FARM	.....
GRAVEL OR STONE ROAD	.....	GOLF PRESERVE	.....
GRAVEL OR STONE ROAD	.....	RIFLE CLUB	.....
GRAVEL OR STONE ROAD	.....	GOLF GROUND OR COUNTRY CLUB	.....
GRAVEL OR STONE ROAD	.....	POLO GROUNDS	.....
GRAVEL OR STONE ROAD	.....	RIDING ACADEMY	.....
GRAVEL OR STONE ROAD	.....	YACHT CLUB	.....
GRAVEL OR STONE ROAD	.....	AMUSEMENT PARK OR HALL	.....
GRAVEL OR STONE ROAD	.....	FAIR GROUND, RACE COURSE, SPEEDWAY	.....
GRAVEL OR STONE ROAD	.....	DRIVE-IN THEATRE	.....
GRAVEL OR STONE ROAD	.....	FARM UNITS, DWELLINGS, ETC.	.....
GRAVEL OR STONE ROAD	.....	FARM UNIT	.....
GRAVEL OR STONE ROAD	.....	DWELLING (OTHER THAN FARM)	.....
GRAVEL OR STONE ROAD	.....	ROWS OR GROUPS OF DWELLINGS CLOSELY SPACED	.....
GRAVEL OR STONE ROAD	.....	COMBINED DWELLING AND STORE	.....
GRAVEL OR STONE ROAD	.....	DWELLING AND FILLING STATION	.....
GRAVEL OR STONE ROAD	.....	DWELLING AND FILLING STATION	.....
GRAVEL OR STONE ROAD	.....	SEASONAL OR SUMMER COLONY DWELLING	.....
GRAVEL OR STONE ROAD	.....	HOTEL, INN	.....
GRAVEL OR STONE ROAD	.....	CHURCH OR OTHER RELIGIOUS INSTITUTION	.....
GRAVEL OR STONE ROAD	.....	CHURCH AND SCHOOL	.....
GRAVEL OR STONE ROAD	.....	CENETERY	.....
GRAVEL OR STONE ROAD	.....	CHURCH WITH CENETERY ADJACENT	.....
GRAVEL OR STONE ROAD	.....	FRESH AIR FARM OR REST HOME	.....
GRAVEL OR STONE ROAD	.....	WELL	.....
GRAVEL OR STONE ROAD	.....	STACK PILE OF ENTRY OR WEIGHT STATION	.....
GRAVEL OR STONE ROAD	.....	GROUP OF MIXED CULTURAL FEATURES CLOSELY SPACED	.....
GRAVEL OR STONE ROAD	.....	INDUSTRIAL	.....
GRAVEL OR STONE ROAD	.....	STORE OR SMALL BUSINESS ESTABLISHMENT	.....
GRAVEL OR STONE ROAD	.....	BUSINESS AND POST OFFICE	.....
GRAVEL OR STONE ROAD	.....	BUSINESS AND FILLING STATION	.....
GRAVEL OR STONE ROAD	.....	BUSINESS, FILLING STATION, AND POST OFFICE	.....
GRAVEL OR STONE ROAD	.....	FACTORY OR INDUSTRIAL PLANT	.....
GRAVEL OR STONE ROAD	.....	MINE-SHAFT OR DRIFT	.....
GRAVEL OR STONE ROAD	.....	OIL OR GAS WELL	.....
GRAVEL OR STONE ROAD	.....	OIL OR GAS FIELD	.....
GRAVEL OR STONE ROAD	.....	OIL TANK	.....
GRAVEL OR STONE ROAD	.....	GAS TANK	.....
GRAVEL OR STONE ROAD	.....	GROUP OF STORAGE TANKS	.....
GRAVEL OR STONE ROAD	.....	FILLING STATION (NOT CONNECTED WITH OTHER BUSINESS)	.....
GRAVEL OR STONE ROAD	.....	PUMPING STATION (OIL OR GAS)	.....
GRAVEL OR STONE ROAD	.....	Gauging or Pumping Station	.....
GRAVEL OR STONE ROAD	.....	VALVE HOUSE	.....
GRAVEL OR STONE ROAD	.....	SEASONAL INDUSTRY (CANNERY OR SMALL GRAIN MILL)	.....
GRAVEL OR STONE ROAD	.....	MILK DEPOT, CREAMERY OR CHEESE FACTORY	.....
GRAVEL OR STONE ROAD	.....	FRUIT OR NUT ORCHARD	.....
GRAVEL OR STONE ROAD	.....	FRUIT OR PRODUCE PACKING HOUSE	.....
GRAVEL OR STONE ROAD	.....	ROAD STAND FARM PRODUCTS SALES	.....
GRAVEL OR STONE ROAD	.....	WAREHOUSE—GENERAL, 1/2 GOVERNMENT AND STATE OR U.S.	.....
GRAVEL OR STONE ROAD	.....	GRAIN ELEVATOR	.....
GRAVEL OR STONE ROAD	.....	GROUP OF GRAIN STORAGE BINS	.....
GRAVEL OR STONE ROAD	.....	GREENHOUSE	.....
GRAVEL OR STONE ROAD	.....	NURSERY	.....
GRAVEL OR STONE ROAD	.....	STOCK YARD—LOADING PEN OR CORRAL	.....
GRAVEL OR STONE ROAD	.....	STOCK PEN AT RAILROAD SIDING (SMALL)	.....
GRAVEL OR STONE ROAD	.....	GRAVEL PIT	.....
GRAVEL OR STONE ROAD	.....	QUARRY	.....
GRAVEL OR STONE ROAD	.....	KILN OR OVEN (CLAY PRODUCTS, ETC.)	.....
GRAVEL OR STONE ROAD	.....	EDUCATIONAL AND CORRECTIONAL INSTITUTIONS	.....
GRAVEL OR STONE ROAD	.....	SCHOOLHOUSE	.....
GRAVEL OR STONE ROAD	.....	CONSOLIDATED OR LARGE SCHOOL	.....
GRAVEL OR STONE ROAD	.....	TOWNHALL, GRANGE, OR COMMUNITY HALL	.....
GRAVEL OR STONE ROAD	.....	AGRICULTURAL EXPERIMENT STATION	.....
GRAVEL OR STONE ROAD	.....	COUNTY FARM	.....
GRAVEL OR STONE ROAD	.....	CORRECTIONAL INSTITUTION	.....
GRAVEL OR STONE ROAD	.....	PUBLIC SERVICE FACILITIES	.....
GRAVEL OR STONE ROAD	.....	POST OFFICE	.....
GRAVEL OR STONE ROAD	.....	HIGHWAY GARAGE	.....
GRAVEL OR STONE ROAD	.....	FIRE ENGINE HOUSE	.....
GRAVEL OR STONE ROAD	.....	CARBIDE OR RUBBISH DUMP	.....
GRAVEL OR STONE ROAD	.....	SEWAGE DISPOSAL PLANT	.....
GRAVEL OR STONE ROAD	.....	AUTO SALVAGE YARD	.....
GRAVEL OR STONE ROAD	.....	TRANSFORMER STATION	.....
GRAVEL OR STONE ROAD	.....	POWER PLANT	.....
GRAVEL OR STONE ROAD	.....	POWER SUBSTATION	.....
GRAVEL OR STONE ROAD	.....	BOOSTER STATION	.....
GRAVEL OR STONE ROAD	.....	WATER SUPPLY, STAND PIPE, OR TANK	.....
GRAVEL OR STONE ROAD	.....	RADIO STATION, WITH CALL LETTERS	.....
GRAVEL OR STONE ROAD	.....	RADIO RANGE STATION	.....
GRAVEL OR STONE ROAD	.....	MISCELLANEOUS	.....
GRAVEL OR STONE ROAD	.....	FORT, ARMY CAMP, BARRACKS, OR OTHER	.....
GRAVEL OR STONE ROAD	.....	MILITARY POST	.....
GRAVEL OR STONE ROAD	.....	TRIANGULATION STATION	.....
GRAVEL OR STONE ROAD	.....	BENCH MARK (WITH ELEVATION)	.....
GRAVEL OR STONE ROAD	.....	NATURAL FEATURES	.....
GRAVEL OR STONE ROAD	.....	PROMINENT ELEVATION—WITH NAME	.....
GRAVEL OR STONE ROAD	.....	SINK OR DEPRESSION	.....

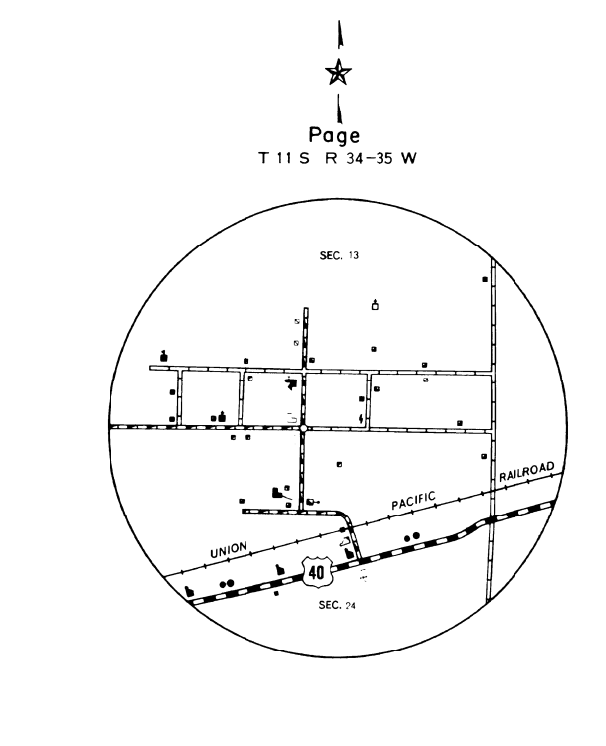

# GENERAL HIGHWAY MAP LOGAN COUNTY KANSAS

PREPARED BY THE  
STATE HIGHWAY COMMISSION OF KANSAS  
DEPARTMENT OF PLANNING AND DEVELOPMENT  
IN COOPERATION WITH THE  
U. S. DEPARTMENT OF TRANSPORTATION  
FEDERAL HIGHWAY ADMINISTRATION

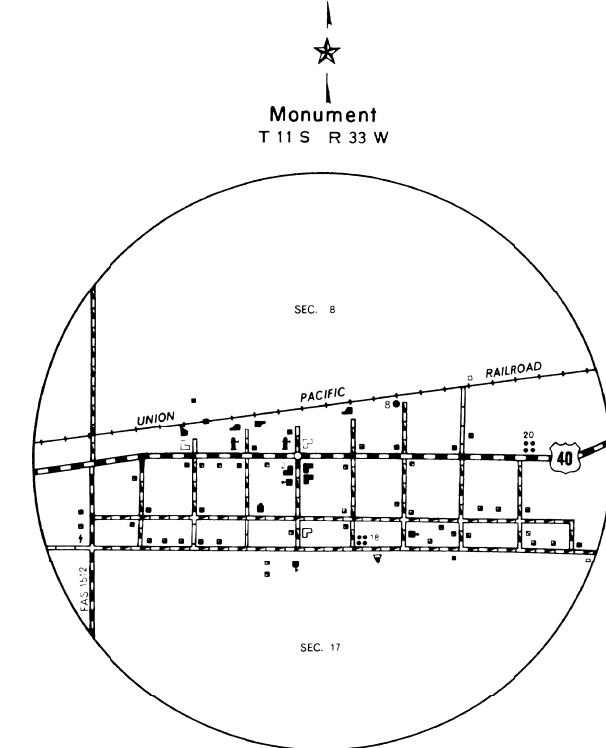
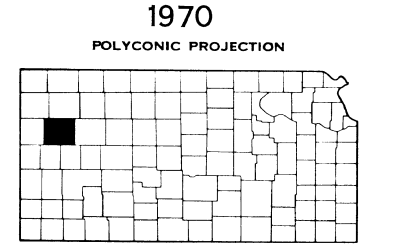
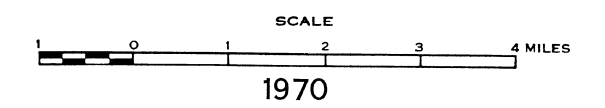

KEY TO COUNTIES

REINVENTORY COMPLETED  
T.A. AND STATE  
SYSTEMS REVISED TO