

LEGEND

ROADS AND ROADWAY FEATURES		CONSERVATION AND RECREATION	
PRIMITIVE ROAD	PICNIC GROUND
UNIMPROVED ROAD	PLAYGROUND, BALL FIELD, ETC.
GRAVEL OR DRAINED ROAD	BATHING BEACH OR SWIMMING POOL
SOIL SURFACED ROAD	SCENIC SITE
GRAVEL OR STONE ROAD	CAMP SITE, NO PERMANENCE, TENTS OR TRAILER PARKING
NOT GRADED OR DRAINED	TOURIST COURT OR MOTEL
GRAVEL OR STONE ROAD	CAMP OR LODGE
GRAVEL OR STONE ROAD WITH STABILIZED SURFACE	SMALL PARK
PAVED ROAD	FISH HATCHERY
DIVIDED HIGHWAY	BIRD SANCTUARY
HIGHWAY WITH FULL CONTROL OF ACCESS	GAME FARM
SIDE ROADS AND STREETS IN UNINCORPORATED URBAN COMPACTS AND EXTENSIONS OF LOCAL ROADS WITHIN MUNICIPALITIES	GAME PRESERVE
4 LANE UNDIVIDED HIGHWAY	RIFLE CLUB
PRIVATE ROAD	GOLF GROUND OR COUNTRY CLUB
PROJECTED ROAD	POLO GROUNDS
		RIDING ACADEMY
		YACHT CLUB
		AMUSEMENT PARK OR HALL
		Fair Ground, Race Course, SLEDGEWAY
		DRIVEN THEATRE
ROAD SYSTEM DESIGNATION		FARM UNITS, DWELLINGS, ETC.	
FEDERAL-AID INTERSTATE HIGHWAY SYSTEM	FARM UNIT
FEDERAL-AID PRIMARY HIGHWAY SYSTEM	DWELLING (OTHER THAN FARM)
FEDERAL-AID SECONDARY HIGHWAY SYSTEM	ROWS OR GROUPS OF DWELLINGS CLOSELY SPACED
POINTS BETWEEN WHICH DISTANCES ARE MEASURED INDICATED THUS	COMBINED DWELLINGS AND STORE
INTERSTATE NUMBERED HIGHWAY	DWELLING AND POST OFFICE
U S NUMBERED HIGHWAY	DWELLING, BUSINESS, AND FILLING STATION
STATE HIGHWAY SYSTEM OR	TENANT HOUSE
STATE NUMBERED HIGHWAY	SEASONAL OR SUMMER COLONY DWELLING
MARK OF DESIGNATED SYSTEM OR	HOTEL, INN
ENDED ROUTE	CHURCH OR OTHER RELIGIOUS INSTITUTION
		CHURCH AND SCHOOL
		CENETERY
		CHURCH WITH CEMETERY ADJACENT
		FRESH AIR FARM OR REST HOME
		HOSPITAL
		WELL
		STAKE POST OR EXTING OR HEIGHT STATION
		GROUP OF MIXED CULTURAL FEATURES CLOSELY SPACED
RAILROADS		INDUSTRIAL	
RAILROAD	STORE OR SMALL BUSINESS ESTABLISHMENT
RAILROADS IN JUNCTURE POSITION	BUSINESS AND FILLING STATION
NARROW GAUGE RAILROAD	BUSINESS, FILLING STATION, AND POST OFFICE
ELECTRIC INTERURBAN OR SUBURBAN RAILROAD	FACTORY OR INDUSTRIAL PLANT
ABANDONED RAILROAD (TRACK REMOVED)	MINE-SHAFT OR DRIFT
ABANDONED ELECTRIC LINE (TRACK REMOVED)	OIL OR GAS WELL
RAILROAD STATION	OIL TANK
		GAS TANK
		GROUP OF STORAGE TANKS
		FILLING STATION (NOT CONNECTED WITH OTHER INDUSTRIES)
		PUMPING STATION (OIL OR GAS)
		GASOLINE OR PUMPING STATION
		VALVE HOUSE
		SEASONAL INDUSTRY (CANNERY OR SMALL DRAIN MILLS)
		MILK DEPT., CREAMERY OR CHEESE FACTORY
		FRUIT OR NUT ORCHARD
		FRUIT OR PRODUCE PACKING HOUSE
		ROAD STAND FARM PRODUCTS SALES
		WAREHOUSE-GENERAL (IF GOVERNMENT AND STATE OR U S)
		GRAIN ELEVATOR
		GROUP OF GRAIN STORAGE BINS
		NUMBER
		STOCK YARD-LOADING PEN OR CORRAL
		STOCK PEN AT RAILROAD SIDING
		GRAVEL PIT
		QUARRY
		RILL OR OPEN LIVE CLAY PRODUCTS, ETC.
RAILROAD CROSSINGS		EDUCATIONAL AND CORRECTIONAL INSTITUTIONS	
RAILROAD ABOVE	CONSOLIDATED OR LARGE SCHOOL
RAILROAD BELOW	TOWN, SCHOOL, OR COMMUNITY HALL
RAILROAD BRIDGE	AGRICULTURAL EXPERIMENT STATION
		COUNTY FARM
		CORRECTIONAL INSTITUTION
AIRWAYS AND AIRPORTS		PUBLIC SERVICE FACILITIES	
AIR ROUTE	POST OFFICE
MILITARY FIELD (WITH FACILITIES AVAILABLE)	HIGHWAY GARAGE
AIRPORT, COMPLETE FACILITIES (COMMERCIAL OR MUNICIPAL)	FIRE ENGINE HOUSE
AIRFIELD, LIMITED FACILITIES	GARBAGE OR RUBBISH DUMP
LANDING AREA OR STRIP (INCLUDING PRIVATE AIR FIELDS)	SEWAGE DISPOSAL PLANT
AIRWAY LIGHT BEACON-GENERAL	AUTO SALVAGE YARD
AIRPORT-GENERAL	TRANSFORMER STATION
		POWER PLANT
		POWER SUBSTATION
		BOOSTER STATION
		WATER SUPPLY, STAND PIPE OR TANK
		RADIO STATION
		RADIO RANGE STATION
NAVIGATION		MISCELLANEOUS	
NAVIGABLE STREAM	FORT, ARMY CAMP, BARRACKS, OR OTHER
INTERMITTENT STREAM	MILITARY POST
INTERMITTENT STREAM	TRIANGULATION STATION
NARROW STREAM	BENCH MARK (WITH ELEVATION)
WIDE STREAM		
DRAINAGE DITCH		
IRIGATION DITCH		
LAKE, RESERVOIR, OR POND		
LAKE, RESERVOIR, OR POND WITH DAM		
DRY LAKE SUBJECT TO FLOOD		
LAKE OR SWAMP LAND		
OVERFLOW LAND		
STRUCTURES		NATURAL FEATURES	
HIGHWAY BRIDGE, GENERAL	PROMINENT ELEVATION, WITH NAME
HIGHWAY BRIDGE	SINK OR DEPRESSION
SMALL BRIDGES CLOSELY SPACED		
BRIDGES FOR LONG RIVER CROSSINGS			
GENERAL		
TRUSS OR GIRDER		
CANTILEVER BRIDGE		
COVERED BRIDGE		
HIGHWAY GRADE SEPARATION		
MISCELLANEOUS STRUCTURES			
DAM WITH ROAD		
LEVEE OR DIKE WITH ROAD		
CONCRETE FORD OR DIP		
FORD-ROAD ESTABLISHED		
CATTLE GUARD		
GATE ACROSS ROAD		
BOUNDARIES			
STATE		
COUNTY		
CORPORATE LINES		
BOUNDARY LINES ESTABLISHED FOR DELIMITED URBAN PLACES		
SECTION LINE		
MATCH LINE BETWEEN ADJOINING SHEETS OF SAME COUNTY		
BOUNDARY TO MARK ENLARGEMENT INSET		
PARKS AND OTHER RESERVATIONS NATIONAL, STATE, COUNTY, OR MUNICIPAL PARK		
INDIAN RESERVATION, NATIONAL MONUMENT, FEDERAL DEVELOPMENT PROJECT		
MONUMENT-SMALL, HISTORIC SITE		
CITY AND VILLAGE CENTERS			
STATE CAPITAL		
COUNTY SEAT		
OTHER CITIES AND VILLAGES		
INCORPORATED CITY OR VILLAGE		
BOUNDARY LIMITS FIXED FOR SPECIAL TAXING AREAS AND OTHER UNINCORPORATED URBAN PLACES DELIMITED		

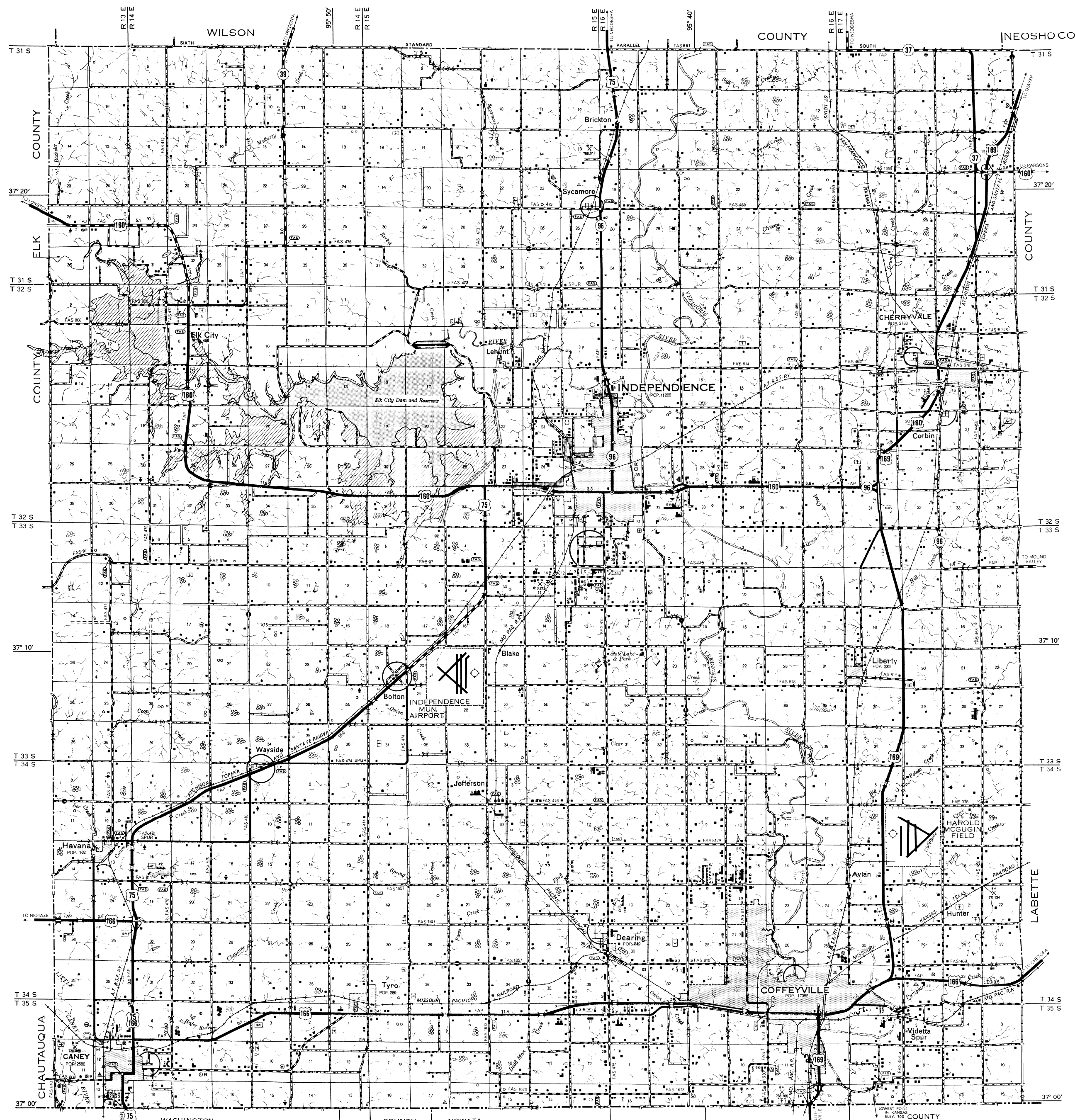

GENERAL HIGHWAY MAP
MONTGOMERY COUNTY
 KANSAS

PREPARED BY THE
 STATE HIGHWAY COMMISSION OF KANSAS
 DEPARTMENT OF PLANNING AND DEVELOPMENT
 IN COOPERATION WITH THE
 U. S. DEPARTMENT OF TRANSPORTATION
 FEDERAL HIGHWAY ADMINISTRATION
 BUREAU OF PUBLIC ROADS

SCALE 1 2 3 4 MILES

1970

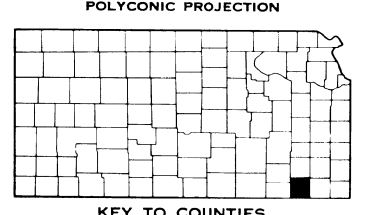

KEY TO COUNTIES

INVENTORY COMPLETED 12-2-68
 P. A. AND STATE SYSTEMS REVISED TO 12-2-68

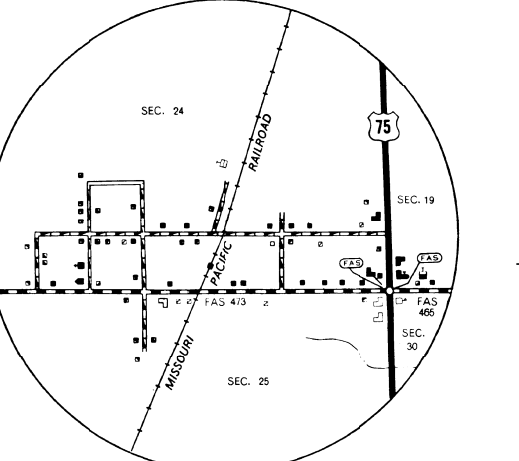

Sycamore
T 31 S R 15 E

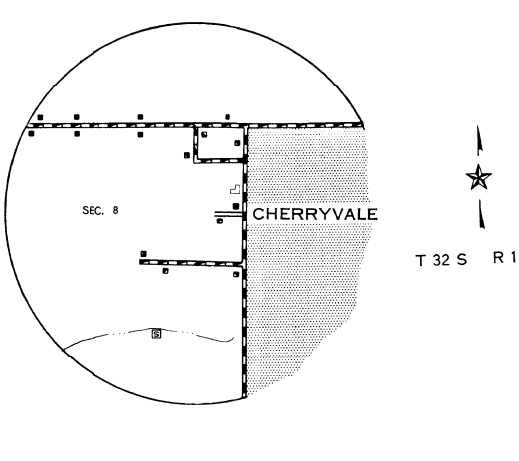

Cherryvale
T 32 S R 17 E

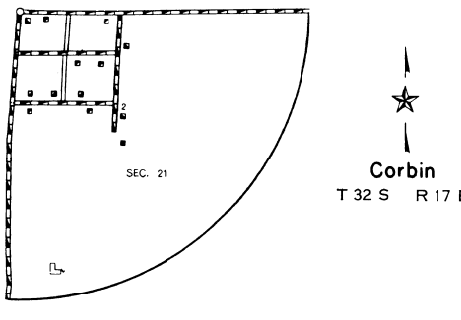

Corbin
T 32 S R 17 E

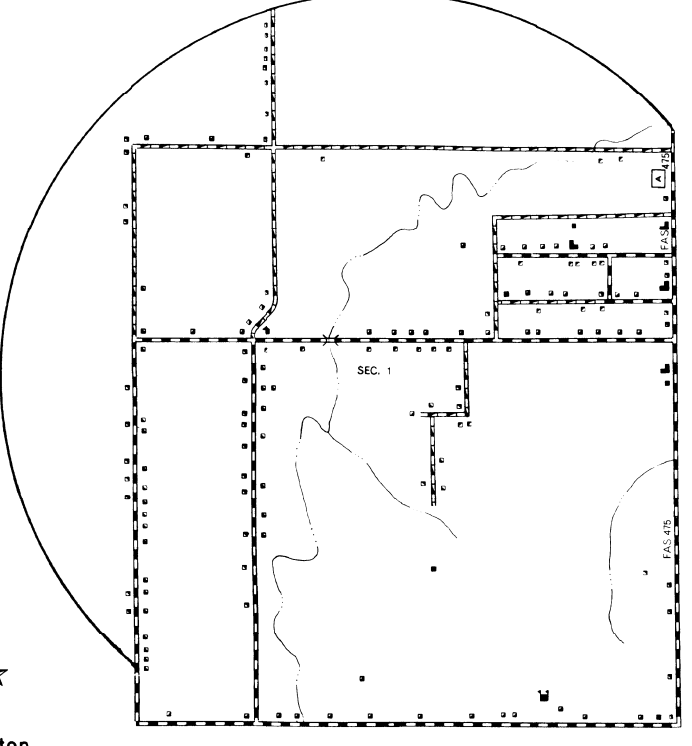

Elk City
T 33 S R 15 E

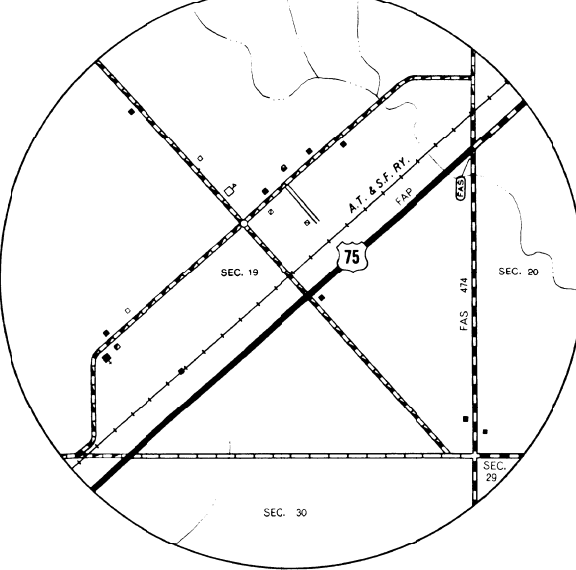

Bolton
T 33 S R 15 E

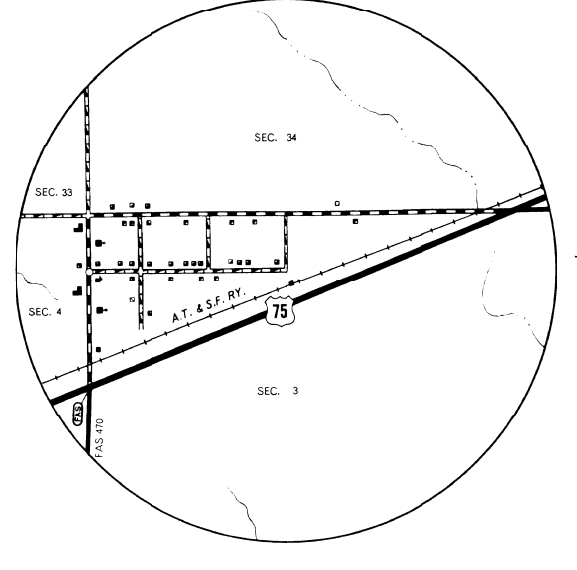

Wayside
T 33 S R 14 E

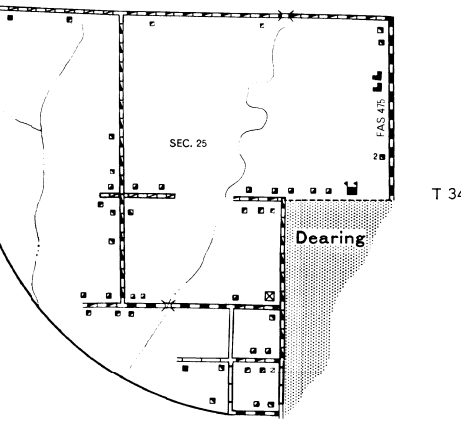

Dearing
T 34 S R 15 E

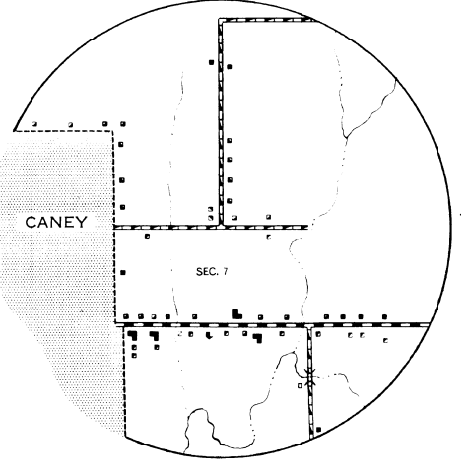

Coffeyville
T 34 S R 16 E

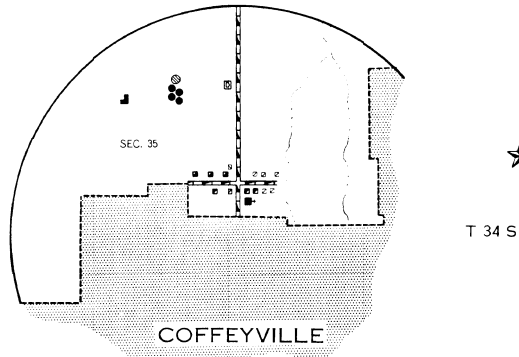

Coffeyville
T 34 S R 16 E



ENLARGEMENT SCALE 1 MILE