

LEGEND

ROADS AND ROADWAY FEATURES Unimproved Road (Type A) Gravel or Drained Road (Type C) Soil Surface Road (Type D) Gravel or Stone Road— Not Graded or Drained (Type E-1) Gravel or Stone Road— Graded and Drained (Type E-2) Gravel or Stone Road With Stabilized Surface (Type E-3) Bituminous Road—Low Type (Type F, G, H-1) Driveway Highway With Full Control of Access Side Roads and Streets in Unincorporated Urban Compact and Extensions of Local Roads Within Municipalities 4 Lane Undivided Highway Projected Road Road System Designation Federal-Aid Interstate Highway System Federal-Aid Primary Highway System Federal-Aid Secondary Highway System Federal-Aid Urban Highway System Points Between Which Distances are Measured U.S. Numbered Highway State Highway System or State Numbered Highway End of Designated System or Marked Route RAILROADS Railroad (Any Number of Tracks Used by a Single Operating Company or by Tracks of Another Carrier Under Trackage Rights) Railroad in Joint Operation (Two or More) Tracks of Separately Operated Companies on Adjacent Rights-of-Way Abandoned Railroad (Track Retained) Railroad Station Railroad Crossing Grade Crossing Railroad Above Railroad Below Railroad Bridge AIRWAYS AND AIRPORTS Military Field (Some Facilities Available) Airport Complete Facilities (Commercial or Municipal) Airfield, Limited Facilities Landing Area or Strip (Including Private Air Fields) Airway Light Beacon, General Airport, General NAVIGATION Navigable Stream (No measurement navigation) DRAINAGE Intermittent Stream (Name) Intermittent Stream (Flow) Narrow Stream Wide Stream Drainage Ditch Irrigation Ditch Lake, Reservoir or Pond Lake, Reservoir or Pond With Dam Dry Lake Subject to Flood Marsh or Swamp Land Overflow Land STRUCTURES Highway Bridge, General Total Span Greater Than 20 Feet Small Bridges Closely Spaced Bridges For Long River Crossings General Arch Truss or Gable (w. wood & steel) Cantilever Bridge Highway Grade Separation Miscellaneous Structures Levee Or Dike Levee Or Dike With Road Concrete Ford Or Dip Ford Road Established Cattle Guard Gate Across Road (Any Type) BOUNDARIES State County Corporate Lines Boundary Lines Established For Delimited Urban Places Section Line Boundary to Mark Enlargement Inset Park and Other Reservations National, State, County, or Municipal Park, Indian Reservation, National Monument, Federal Development Project Monument—Small, Historic Site CITY AND VILLAGE CENTERS State Capital County Seat Other Cities and Villages Incorporated City or Village Boundary Limits Fixed for Special Taxing Areas and Other Unincorporated Urban Places Determined NATURAL FEATURES Prominent Elevation—With Name (Numerals Indicate Elevation Above Sea Level) Sink or Depression CONSERVATION AND RECREATION Pond, Ground Playground, Ball Field, Etc. Bathing Beach or Swimming Pool Stone Site Camp Site, No Permanence (Tents or Trailer Parking) Tourist Court or Motel (Figure Indicates Number of Permanent Cabins or Cottages) Camp or Lodge (Permanence Site With Building) Small Park (SP, State, CP, County, MP, Municipal, SR, State, Red Area) Fish Hatchery Bird Sanctuary Game Farm Game Preserve Rifle Club Golf Ground or Country Club Riding Academy Yacht Club Amusement Park or Hall Fair Ground, Race Course, Speedway Drive-In Theatre Marina Rubber Grounds Guide House or Gate House (Add Letters N or S to Indicate National or State Park) FARM UNITS, DWELLINGS, ETC. Farm Unit Dwelling (Other Than Farm) Rows or Groups of Dwellings Closely Spaced (Figure Denotes Number of Dwellings) Combined Dwelling and Store Dwelling and Post Office Dwelling and Filing Station Dwelling, Business, and Filing Station Tenant House Seasonal or Summer Colony Dwelling Hotel, Inn Humane Society Quarters Church or Other Religious Institution Church and School (Joint Use) Cemetery Church With Cemetery Adjacent Fresh Air Farm or Rest Home Hospital Well State Port of Entry or Weight Station Groups of Mixed Cultural Features Closely Spaced (Figure above bar indicates number of dwellings included in the group; Figures over individual units show number of each included regardless of color) INDUSTRIAL Store or Small Business Establishment Business and Post Office Business and Filing Station Business, Filing Station, and Post Office Factory or Industrial Plant Mine (Shaft or Shaft, Any Kind) Oil or Gas Well Oil or Gas Field Storage Tank (Gas or Oil Figure Denotes Number of Tanks) Filling Station (Not Connected With Other Business) Lumber House Pumping Station (Oil or Gas) Gauging or Pumping Station (General) Lave House Seasonal Industry (Cannery or Small Grain Mill) Milk Depot, Creamery or Cheese Factory Fruit or Nut Orchard Fruit or Produce Packing House Road Stand Farm Products Sales Warehouse—General (If Government Aid State or U.S., Grain Elevator Storage of Grain Storage Bins Greenhouse Nursery Stock Yard Loading Pen or Corral Stock Pen at Railroad Siding (Small) Quarry Ash or Clink (Lime, Clay Products, Coke, Etc.) Feed Lot Shopping Center Seasonal Business Sawmill (Stationary) EDUCATIONAL AND CORRECTIONAL INSTITUTIONS Schoolhouse Consolidated or Large School Town Hall, or Community Hall Agricultural Experiment Station Correctional Institution Museum—General Public Library PUBLIC SERVICE FACILITIES Post Office Highway Garage Fire Engine House Garbage or Rubbish Dump Sewage Disposal Plant Auto Salvage Yard Transformer Station Power Plant Power Substation Booster Station Water Supply, Stand Pipe, or Tank Radio Station (With Call Letters) Radio Range Station Water Treatment Plant Surveyed U. S. Corps of Engineers Office MISCELLANEOUS Fort, Army Camp, Barracks or Great Military Post Transportation Station Bench Mark (With Elevation)
--

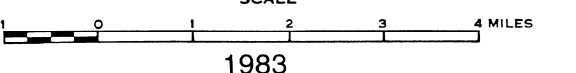
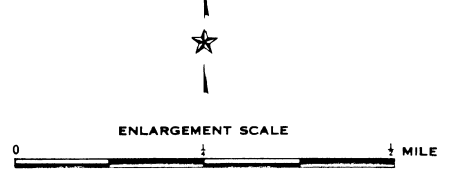
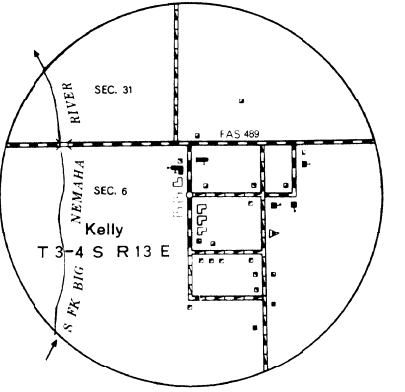
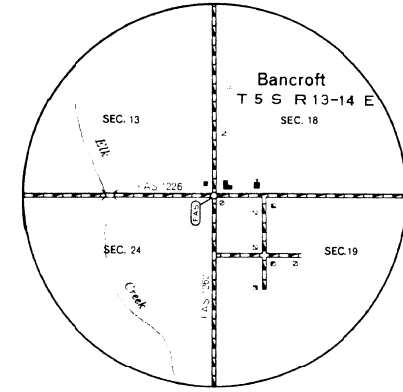
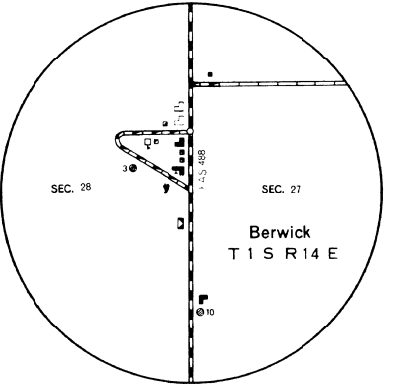
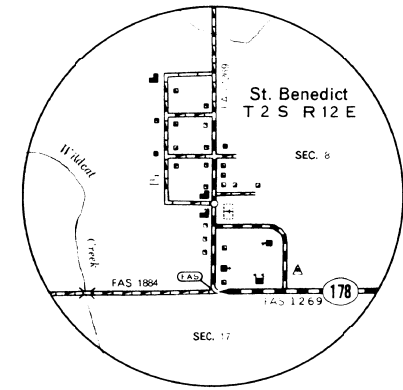
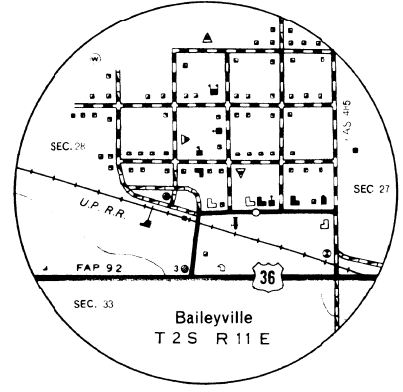
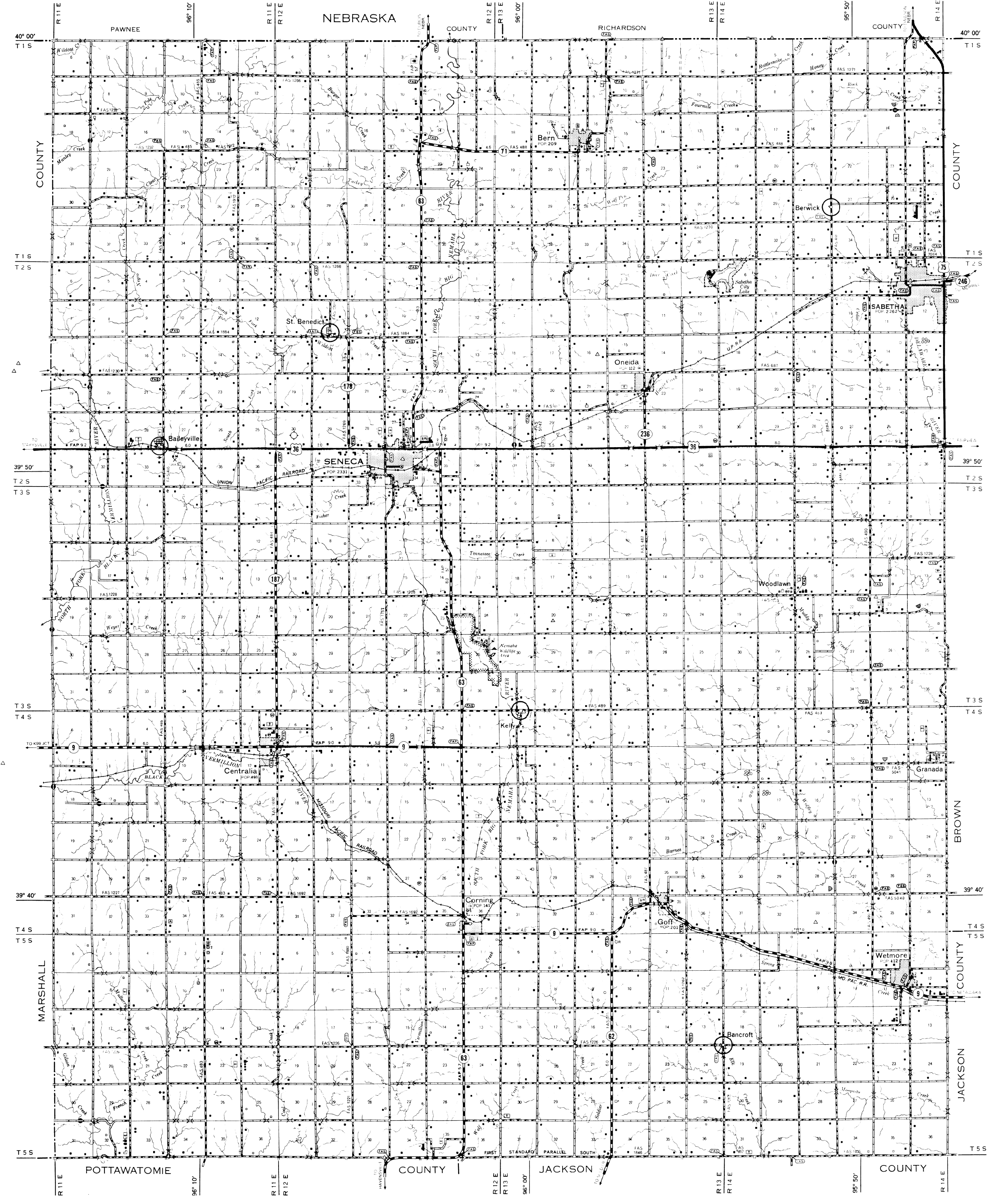

1983

POLYGONIC PROJECTION

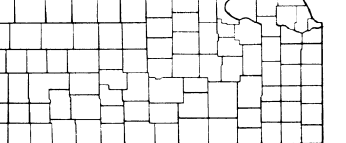

GENERAL HIGHWAY MAP NEMAHA COUNTY KANSAS

PREPARED BY THE
**KANSAS DEPARTMENT OF TRANSPORTATION
 BUREAU OF TRANSPORTATION PLANNING**
 IN COOPERATION WITH THE
**U. S. DEPARTMENT OF TRANSPORTATION
 FEDERAL HIGHWAY ADMINISTRATION**

POPULATIONS—DIVISION OF THE BUDGET 1984
 INVENTORY COMPLETED 1983
 F.A. AND STATE SYSTEMS REVISED TO 1983