

Fostoria
T15 S R15 E

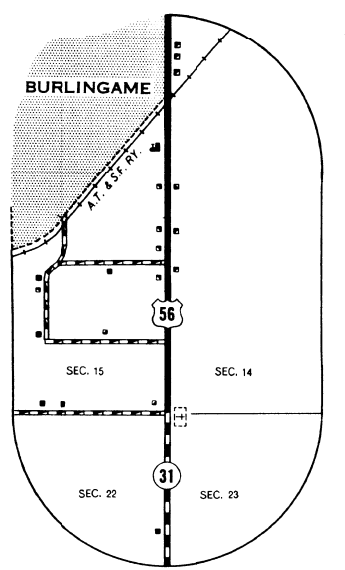

Burlingame
T14 S R14 E

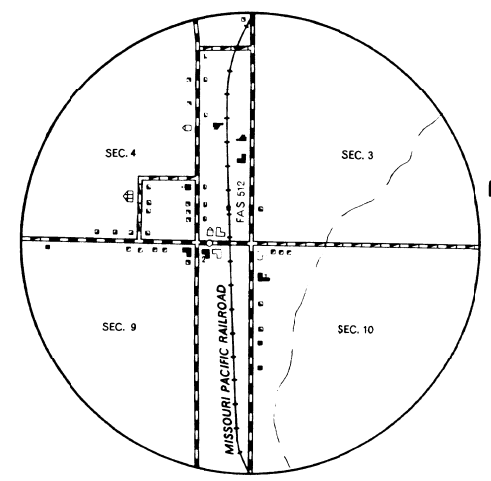

Michigan Valley
T16 S R17 E

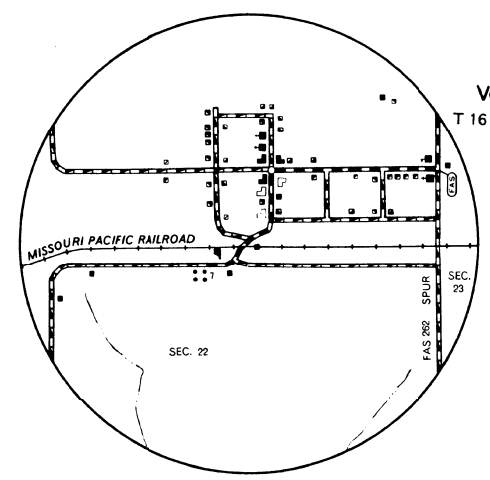

Vassar
T16 S R16 E

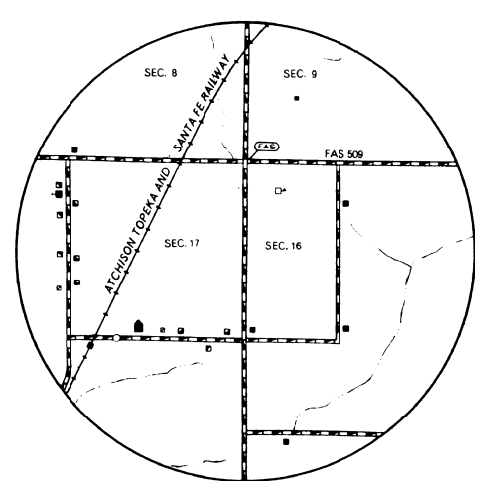

Barclay
T17 S R14 E



ENLARGEMENT SCALE
MILE

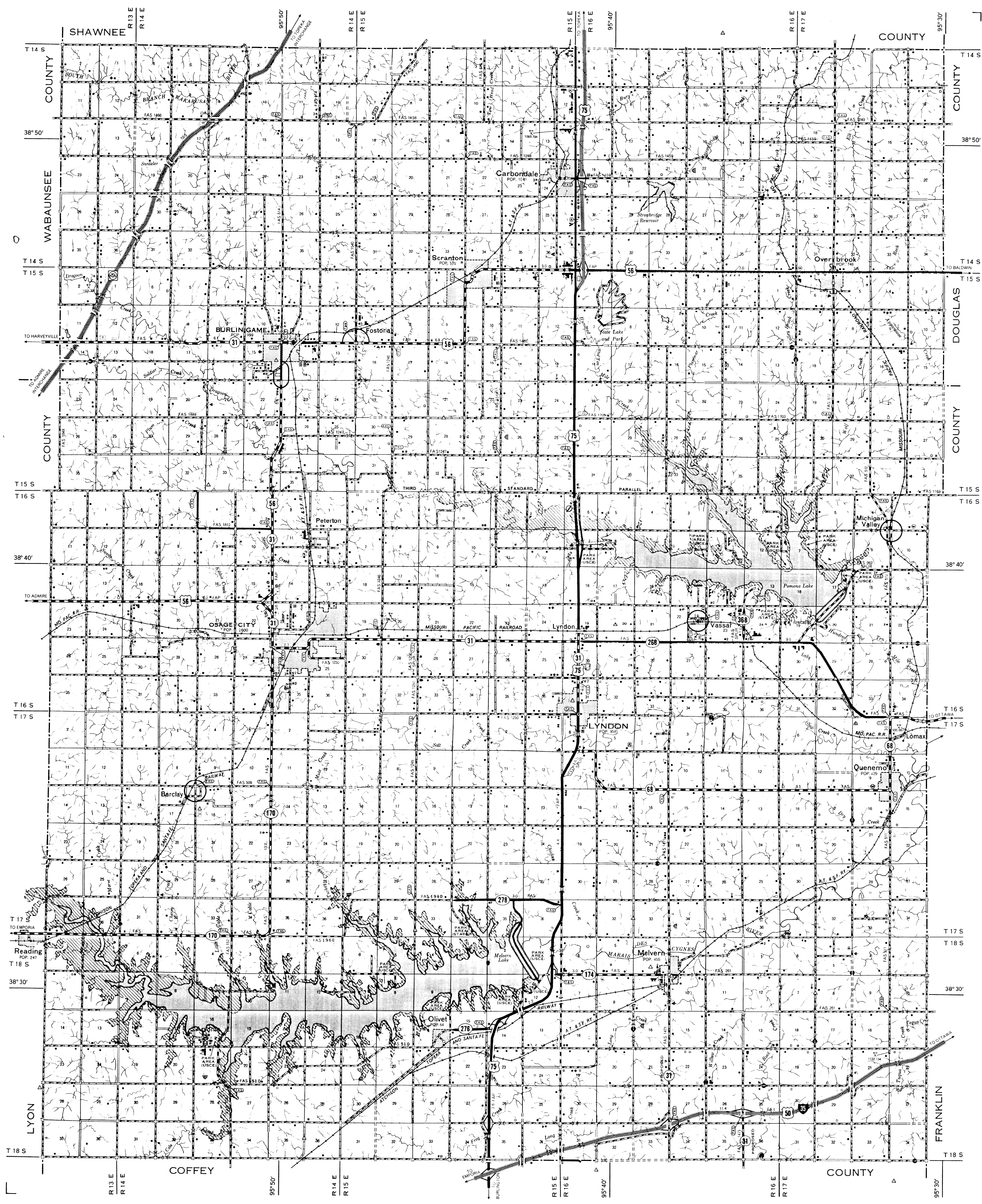

LEGEND

ROADS AND ROADWAY FEATURES	CONSERVATION AND RECREATION
PRIMITIVE ROAD (TYPE 1)	PICNIC GROUND
UNIMPROVED ROAD (TYPE 2)	PLAYGROUND, BALL FIELD, ETC.
GRAVEL OR STONE ROAD	BATHING BEACH OR SWIMMING POOL
GRAVEL OR STONE ROAD WITH STABILIZED SURFACE (TYPE 3)	SCENIC SITE
BUMMERS ROAD (TYPE 4)	CAMP SITE, NO PERMANENCE (TENTS OR TRAILER PARKING)
PAVED ROAD (TYPE 5)	TOURIST STOP, MOTEL, RESTAURANT
DIVIDED HIGHWAY	CAMP OR LODGE
HIGHWAY WITH FULL CONTROL OF ACCESS	SMALL PARK
FORATED URBAN COMPACTS AND EXTENSIONS OF LOCAL ROADS WITHIN MUNICIPALITIES	FISH HATCHERY
4 LANE UNDIVIDED HIGHWAY	BIRD SANCTUARY
PRIVATE ROAD	GAME FARM
PROJECTED ROAD	GAME PRESERVE
	RIFLE CLUB
	GOLF GROUND OR COUNTRY CLUB
	POLO GROUNDS
	RIDING ACADEMY
	YACHT CLUB
	AMUSEMENT PARK OR MALL
	FAIR GROUND, RACE COURSE, SPEEDWAY
	DRIVE-IN THEATRE
	FARM UNITS, DWELLINGS, ETC.
	FARM UNIT
	DWELLING (OTHER THAN FARM)
	ROWS OR GROUPS OF DWELLINGS CLOSELY SPACED (FUTURE DENOTES NUMBER OF DWELLINGS)
	DWELLING AND POST OFFICE
	DWELLING AND FILLING STATION
	DWELLING, BUSINESS, AND FILLING STATION
	TENANT HOUSE
	SEASONAL OR SUMMER COLONY DWELLING
	HOTEL, INN
	CHURCH OR OTHER RELIGIOUS INSTITUTION
	CHURCH AND SCHOOL (SAME USE)
	CEMETERY
	CHURCH WITH CEMETERY ADJACENT
	FRESH AIR FARM OR REST HOME
	HOSPITAL
	WELL
	STATE PORT OF ENTRY OR WEIGHT STATION
	GROUP OF MIXED CULTURAL FEATURES CLOSELY SPACED (NUMBER OF EACH INDICATED BY NUMBER OF DOTS)
	INDUSTRIAL
	STORE OR SMALL BUSINESS ESTABLISHMENT
	BUSINESS AND POST OFFICE
	BUSINESS AND FILLING STATION
	BUSINESS, FILLING STATION, AND POST OFFICE
	FACTORY OR INDUSTRIAL PLANT
	MINE-SHAFT OR DRIFT (SAME AREA)
	OIL OR GAS WELL
	OIL OR GAS FIELD
	OIL TANK
	GAS TANK
	GROUP OF STORAGE TANKS (OIL OR GAS)
	FILLING STATION (POST CONNECTED WITH OTHER BUSINESS)
	PUMPING STATION (OIL OR GAS)
	Gauging or Pumping Station (GENERAL)
	VALVE HOUSE
	SEASONAL INDUSTRY (CANNERY OR SMALL BEAN WELLS)
	MILK DEPOT, CREAMERY OR CHEESE FACTORY
	FRUIT OR NUT ORCHARD
	ROAD STAND FARM PRODUCTS SALES
	WAREHOUSE (GENERAL, OR OTHERWISE SPECIFIED)
	GRAIN ELEVATOR
	GROUP OF GRAIN STORAGE BINS
	GREENHOUSE
	NURSERY
	STOCK YARD-LOADING PEN OR CORRAL
	STOCK PEN AT RAILROAD SIDING (GENERAL)
	GRAVEL PIT
	QUARRY
	QUARRY OR OPEN LIME CLAY PRODUCTS CORE, ETC.
	EDUCATIONAL AND CORRECTIONAL INSTITUTIONS
	SCHOOLHOUSE
	CONSOLIDATED OR LARGE SCHOOL
	TOWNHALL, GYMNASIUM, OR COMMUNITY HALL
	AGRICULTURAL EXPERIMENT STATION
	COUNTY FARM
	CORRECTIONAL INSTITUTION
	PUBLIC SERVICE FACILITIES
	POST OFFICE
	HIGHWAY GARAGE
	FIRE ENGINE HOUSE
	GARBAGE OR RUBBISH DUMP
	SEWAGE DISPOSAL PLANT
	AUTO SALVAGE YARD
	TRANSFORMER STATION
	POWER SUBSTATION
	ROOSTER STATION
	RADIO STATION (WITH CALL LETTERS)
	WATER SUPPLY, STAND PIPE, OR TANK
	RADIO RANGE STATION
	US WEATHER STATION
	MISCELLANEOUS
	FORT, ARMY CAMP, BARRACKS, OR OTHER MILITARY POST
	TRIANGULATION STATION
	BENCH MARK (WITH ELEVATION)
	NATURAL FEATURES
	PROMINENT ELEVATION (WITH NAME AND ELEVATION ABOVE SEA LEVEL)
	SINK OR DEPRESSION

GENERAL HIGHWAY MAP OSAGE COUNTY KANSAS

PREPARED BY THE
STATE HIGHWAY COMMISSION OF KANSAS
DEPARTMENT OF PLANNING AND DEVELOPMENT
IN COOPERATION WITH THE
U. S. DEPARTMENT OF TRANSPORTATION
FEDERAL HIGHWAY ADMINISTRATION

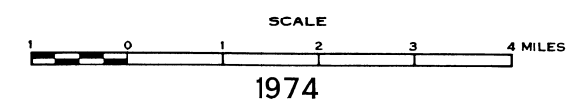

1974

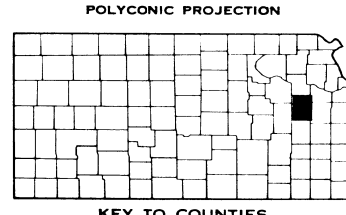

KEY TO COUNTIES

DRAINAGE DELINEATED FROM AERIAL PHOTOGRAPHS