

LEGEND

| ROADS AND ROADWAY FEATURES | CONTOUR AND VEGETATION |
|---|---|
| Primitive Road Type A | Range Ground |
| Improved Road Type B | Flagpole/Well Poles, Etc. |
| Graded and Drained Road Type C | Bearing Beach or Secondary Road |
| Soil Surface Road Type D | Spruce Site |
| Gravel or Stone Road - Not Graded or Drained Type E | Camp Site - Permanent/Temporary or Trailer Parking |
| Gravel or Stone Road - Graded or Drained Type F | Tourist Court or Motel Figure Indicator |
| Gravel or Stone Road with Stabilized Surface Type G | Number of Permanent Cakes or Cottages |
| Bituminous Road - Low Type Type H | Camp or Lodge Permanent Site with Building |
| Bituminous Road - High Type Type I | Top of Road or County |
| Highway with Full Control of Access | Highway - Municipal SR - Safety Rest Area |
| State Roads and Streets in Incorporated Urban Centers and Extensions of Local Roads Within Municipalities | Farm Buildings |
| County Road | Post Office |
| Private Road | Self-Storage or Country Club |
| Proposed Road | Country Club |
| Federal-Aid Interstate Highway System | Resort Park or Hall |
| Federal-Aid Primary Highway System | Fair Grounds, Race Course, Speedway |
| Federal-Aid Secondary Highway System | Drain |
| Federal-Aid Urban Highway System | Drain - Headed Features, Closely Spaced |
| Points Between Which Distances are Measured | Marine |
| | Road Grade |
| | Guide House or Gate House (Add Letters A or S to Indicate National or State Park) |
| | |
| | FARM UNITS, DWELLING, ETC. |
| | Dwelling |
| | Multi Dwelling |
| | Combined Dwelling and Store |
| | Dwelling and Rice Office |
| | Dwelling and Filling Station |
| | Dwelling, Business and Filling Station |
| | Tractor House |
| | Hotel |
| | Home Society Quarters |
| | Church or Other Religious Institution |
| | Church and School (List Use) |
| | Country Club |
| | Club with Catering Adjacent |
| | Fraternity Park or Lawn House |
| | Hospital |
| | State Park or Entry or Weight Station |
| | Group of Other Religious Institution |
| | Figure shows for individual number of dwellings |
| | Individual lot groupings - number of lots |
| | Units also number - each included regardless of lot |
| | |
| | INDUSTRIAL |
| | Store or Retail Business Establishment |
| | Business and Post Office |
| | Business and Filling Station |
| | Business, Filling Station, and Post Office |
| | Factory or Industrial Plant |
| | Workshop or Craft Shop |
| | Oil or Gas Well |
| | Windmill |
| | Storage Tank (See or SLL Figure) |
| | Quantity Number of Tanks |
| | Filling Station Not Connected with Other Business |
| | Pumping Station |
| | Gasping or Pumping Station - General |
| | Auto Wash |
| | Several Industry (Cannery or Small Grain Mill) |
| | High Speed Crane or Crane Factory |
| | Print or Ink Factory |
| | Food or Produce Processing House |
| | Road Stand Farm Produce Sales |
| | Warehouse - General (If Government add State or U.S.) |
| | Group of Grain Storage Bins |
| | Grain Elevator |
| | Honey |
| | State Yearling Pen or Corral |
| | Stock Pen at Railroad Siding (Small) |
| | Stockyard Pen |
| | Road Quarry |
| | Quarry or Open Lime, Clay Products, Coke, Etc. |
| | Feet Lot |
| | Shipping Center |
| | Second Business |
| | Small Establishment |
| | |
| | EDUCATIONAL AND CORRECTIONAL INSTITUTION |
| | Schoolhouse |
| | Consolidated or Large School |
| | Group (Elementary or Community Hall) |
| | Agricultural Experiment Station |
| | Correctional Institution |
| | Museum - General |
| | Public Library |
| | |
| | PUBLIC SERVICE FACILITIES |
| | Post Office |
| | Highway Garage |
| | Fire Engine House |
| | Garage or Ribbon Shop |
| | Storage Shed or Plant |
| | Auto Salvage Yard |
| | Transfer Station |
| | Power Plant |
| | Power Substation |
| | Booster Station |
| | Water Supply Stand Pipe or Tank |
| | Rails Station with Call Letters |
| | Rails Station |
| | Water Treatment Plant |
| | Jungles |
| | U.S. Corps of Engineers Office |
| | Fort, Army Camp, Barracks or Other Military Post |
| | Transit Station |
| | |
| | MISCELLANEOUS |
| | Fort, Army Camp, Barracks or Other Military Post |
| | Transit Station |

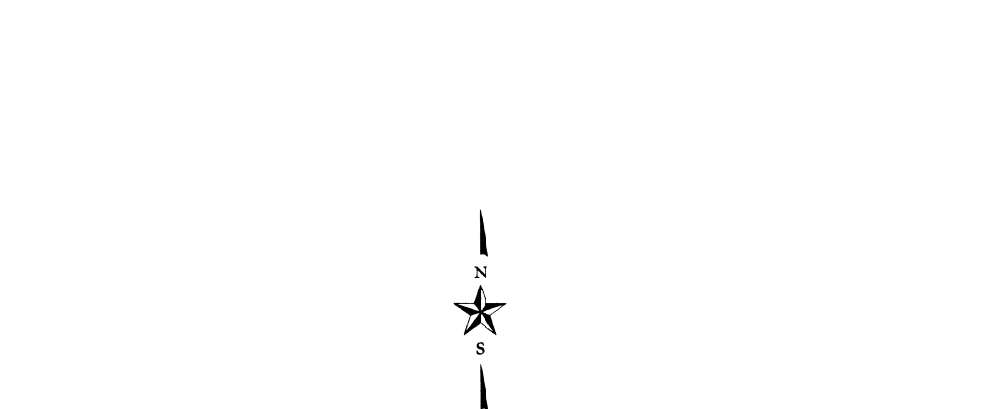

GENERAL HIGHWAY MAP RENO COUNTY KANSAS

PREPARED BY THE
KANSAS DEPARTMENT OF TRANSPORTATION
BUREAU OF TRANSPORTATION PLANNING
IN COOPERATION WITH THE
U. S. DEPARTMENT OF TRANSPORTATION
FEDERAL HIGHWAY ADMINISTRATION

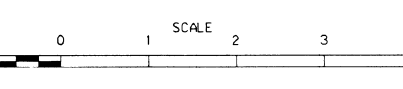

1988
POLYCONIC PROJECTION

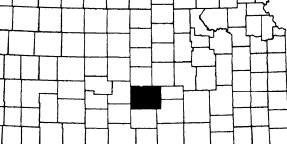

POPULATIONS-DIVISION OF THE BUREAU 1986
REVISIONS COMPLETED: 1-27-88
F.P. AND STATE SYSTEMS REVISION TO: 3-8-82

COMPUTER GENERATED

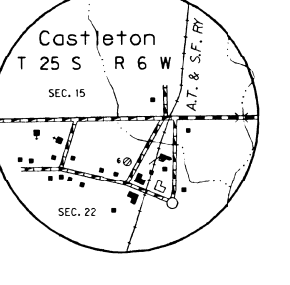
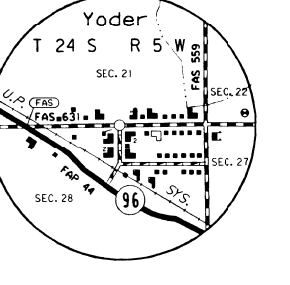
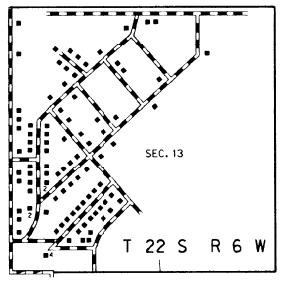
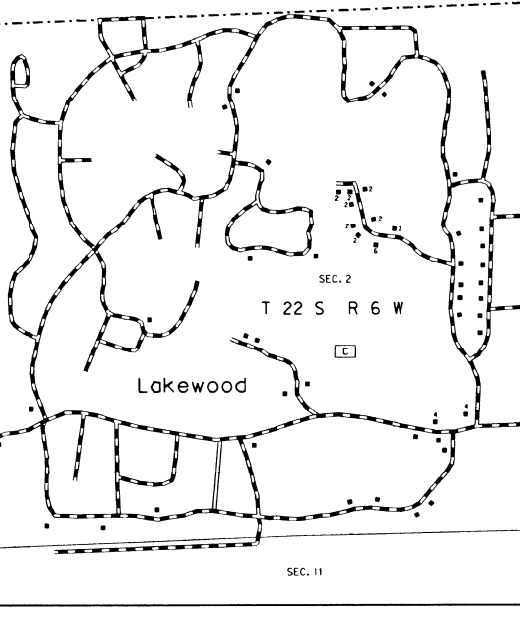
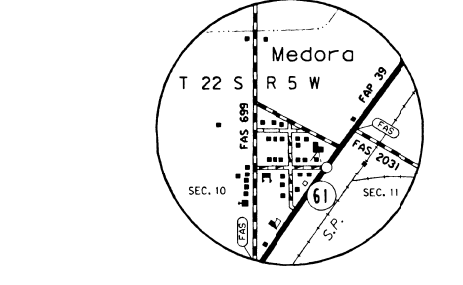

0 1/4 1/2 MILE
ENLARGEMENT SCALE