

LEGEND

- ROADS AND ROADWAY FEATURES**
 - PRIMITIVE ROAD
 - UNIMPROVED EARTH
 - METAL SURFACED (GRAVEL & STONE, CHATS ETC)
 - BITUMINOUS SURFACE (G.S.T., BIT. MAC)
 - PAVED SURFACE (CONCRETE, BRICK, BIT. MAC)
 - FEDERAL AID HIGHWAY SYSTEM
 - FEDERAL AID SECONDARY HIGHWAY SYSTEM
 - STATE AID ROAD
 - CLOVER LEAF
 - UNITED STATES HIGHWAY SYSTEM
 - STATE HIGHWAY SYSTEM
 - RAILROADS
 - RAILROAD (ANY NUMBER OF TRACKS) USED BY SINGLE OPERATING COMPANY
 - RAILROAD (ANY NUMBER OF TRACKS) USED BY MORE THAN ONE OPERATING COMPANY OR SAME OR ADJACENT RIGHTS OF WAY (NOT TRACKAGE RIGHTS)
 - ELECTRIC INTERURBAN OR SUBURBAN RAILROAD
 - RAILROAD STATION
 - GRADE CROSSING
 - RAILROAD ABOVE
 - RAILROAD BELOW
 - AIRWAYS
 - AIR ROUTE
 - ARMY, NAVY OR MARINE CORPS FIELD
 - CIVIL AERONAUTICS AUTHORITY INTERMEDIATE FIELD
 - COMMERCIAL OR MUNICIPAL FIELD
 - MARKED AUXILIARY FIELD
 - AIRPLANE LANDING FIELD-MARKED OR EMERGENCY
 - ARMY BEACON LIGHT
 - AIRPORT HOUSING FACILITIES
 - NAVIGATION
 - NAVIGABLE STREAM (INTERMITTENT NAVIG)
 - DRAINAGE
 - INTERMITTENT STREAM (NARROW)
 - INTERMITTENT STREAM (WIDE)
 - NARROW STREAM
 - WIDE STREAM
 - MARSH OR SWAMP LAND
 - DRAINAGE DITCH (HAND ARROWS POINT IN DIRECTION OF FLOW)
 - IRRIGATION DITCH (ARROWS POINT IN DIRECTION OF FLOW)
 - RESERVOIR, POND OR LAKE
 - RESERVOIR WITH DAM
 - DAM
 - STRUCTURES
 - HIGHWAY BRIDGE (ANY TYPE)
 - LEVEE OR DIKE
 - LEVEE OR DIKE (WITH ROAD)
 - MINOR STRUCTURES
 - CONCRETE FORD OR DIP
 - FORD - ROAD ESTABLISHED
 - PARKS & OTHER RESERVATIONS
 - CCC CAMP
 - BIRD SANCTUARY
 - GAME FARM
 - GAME PRESERVE
 - MONUMENT - SMALL
 - INDIAN BURIAL GROUND
 - GOLF OR COUNTRY CLUB
 - ATHLETIC FIELD OR AMUSEMENT PARK
 - SMALL PARK (C.P. STATE, C.P. COUNTY, M.P. MUNICIPAL)
 - FAIRGROUND, RACE COURSE, SPEEDWAY
 - CAMP OR LODGE
 - END OF K NUMBERED ROUTE
 - END OF H NUMBERED ROUTE
 - END OF US NUMBERED ROUTE
- BOUNDARIES**
 - STATE LINE
 - COUNTY LINE
 - COORDINATE LINE
 - SECTION LINE
 - BOUNDARY TO MARK ENLARGEMENT INSET
 - CITY & VILLAGE CENTERS
 - STATE CAPITAL
 - COUNTY SEAT
 - OTHER CITIES AND VILLAGES
 - OTHER CULTURAL FEATURES
 - VACANT IN USE
 - FARM UNIT
 - DWELLING (OTHER THAN FARM) (FIGURE DENOTES NUMBER OF DWELLINGS)
 - ROW OR GROUP OF DWELLINGS (FIGURE DENOTES NUMBER OF DWELLINGS)
 - COMBINED DWELLING AND STORE OR SMALL BUSINESS
 - TENANT HOUSE
 - SEASONAL DWELLINGS CLOSELY SPACED (FIGURE DENOTES NUMBER OF DWELLINGS)
 - CHURCH-OTHER RELIGIOUS INSTITUTIONS
 - COUNTY FARM
 - HOSPITAL
 - CEMETERY
 - WELL
 - WINDMILL
 - CHURCH WITH CEMETERY ADJACENT
 - GROUP OF MIXED CULTURAL FEATURES (FIGURE DENOTES NUMBER OF FLATULES)
 - STORE OR SMALL BUSINESS ESTABLISHMENT (FIGURE DENOTES NUMBER OF ESTABLISHMENT)
 - FACTORY OR INDUSTRIAL PLANT
 - MINE, SHAFT OR DRIFT (ANY KIND)
 - OIL OR GAS WELL
 - OIL OR GAS FIELD
 - OIL TANK
 - GAS TANK
 - GROUP OF GAS OR OIL TANKS
 - PUMPING STATION OIL OR GAS
 - GAUGING OR PUMPING STATION (GENERAL)
 - MINE OPENING (SHAFT OR DRIFT)
 - SEASONAL INDUSTRY (CANNERY OR SMALL GRAIN MILL)
 - BEET DUMP
 - STOCK YARDS-LOADING PEN
 - GRAVEL PIT
 - QUARRY
 - POST OFFICE
 - TOURIST CAMP
 - NURSERY
 - SCHOOL HOUSE
 - CONSOLIDATED OR LARGE SCHOOL
 - OTHER EDUCATIONAL INSTITUTIONS
 - TOWNSHIP, GRANGE OR COMMUNITY HALL
 - LETTERS DESIGNATE KIND
 - CORRECTIONAL INSTITUTION
 - WATER SUPPLY STAND PIPE
 - TRANSMISSION LINE
 - POWER PLANT
 - POWER SUBSTATION
 - TRANSFORMER STATION
 - RADIO STATION
 - RADIO STATION (WITH CALL LETTERS)
 - K.M.C. SHOPS
 - PORT OF ENTRY
 - GARBAGE OR RUBBISH DUMP
 - SEWAGE DISPOSAL PLANT
 - FORT, ARMY CAMP, BARRACKS OR MILITARY POST
 - POINTS BETWEEN WHICH DISTANCES ARE MEASURED INDICATED THIS TRIANGULATION STATION
 - END OF FA ROUTE
 - END OF FAS ROUTE
 - END OF SA ROUTE (NOW FA OR FAS)

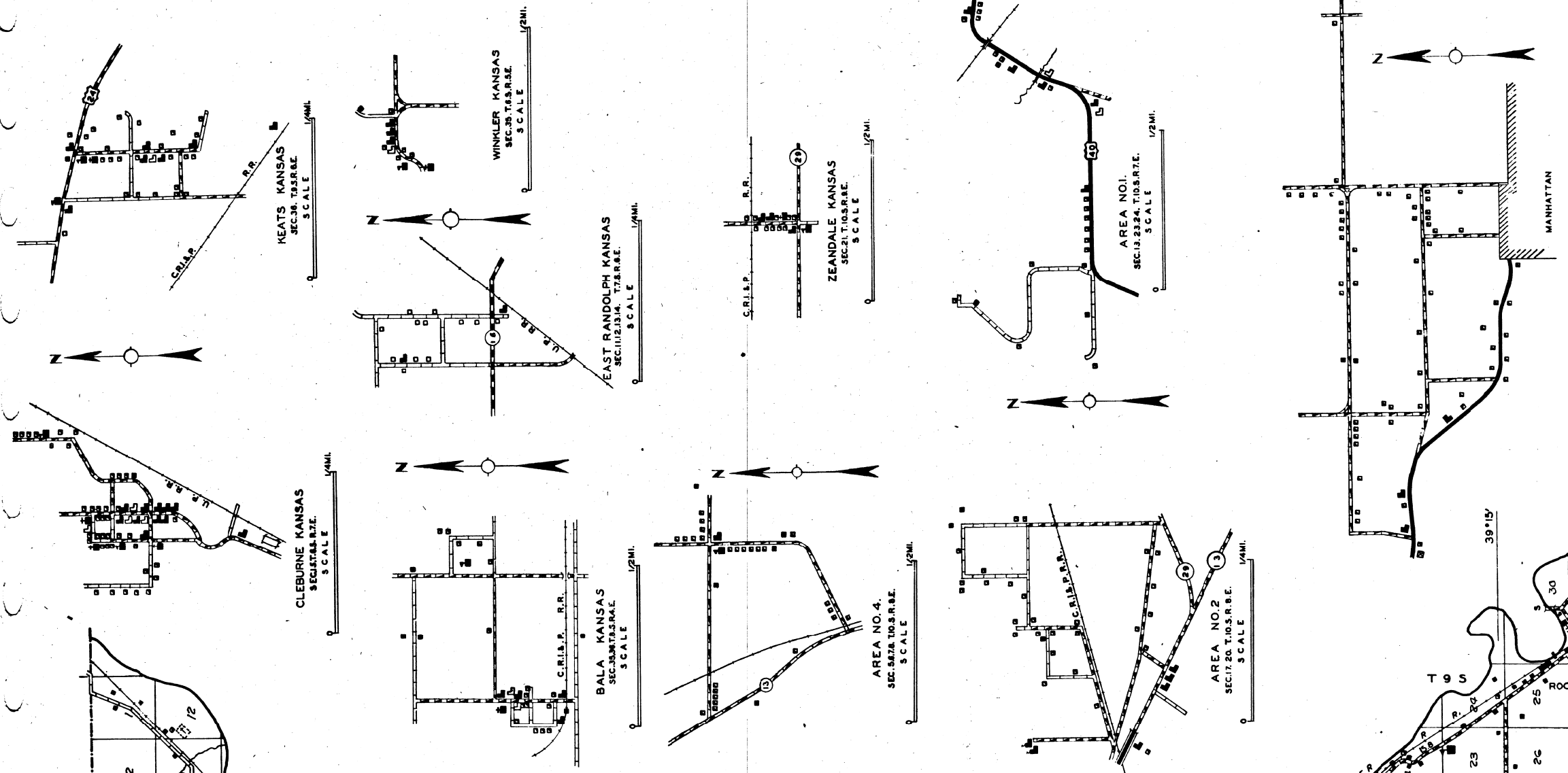
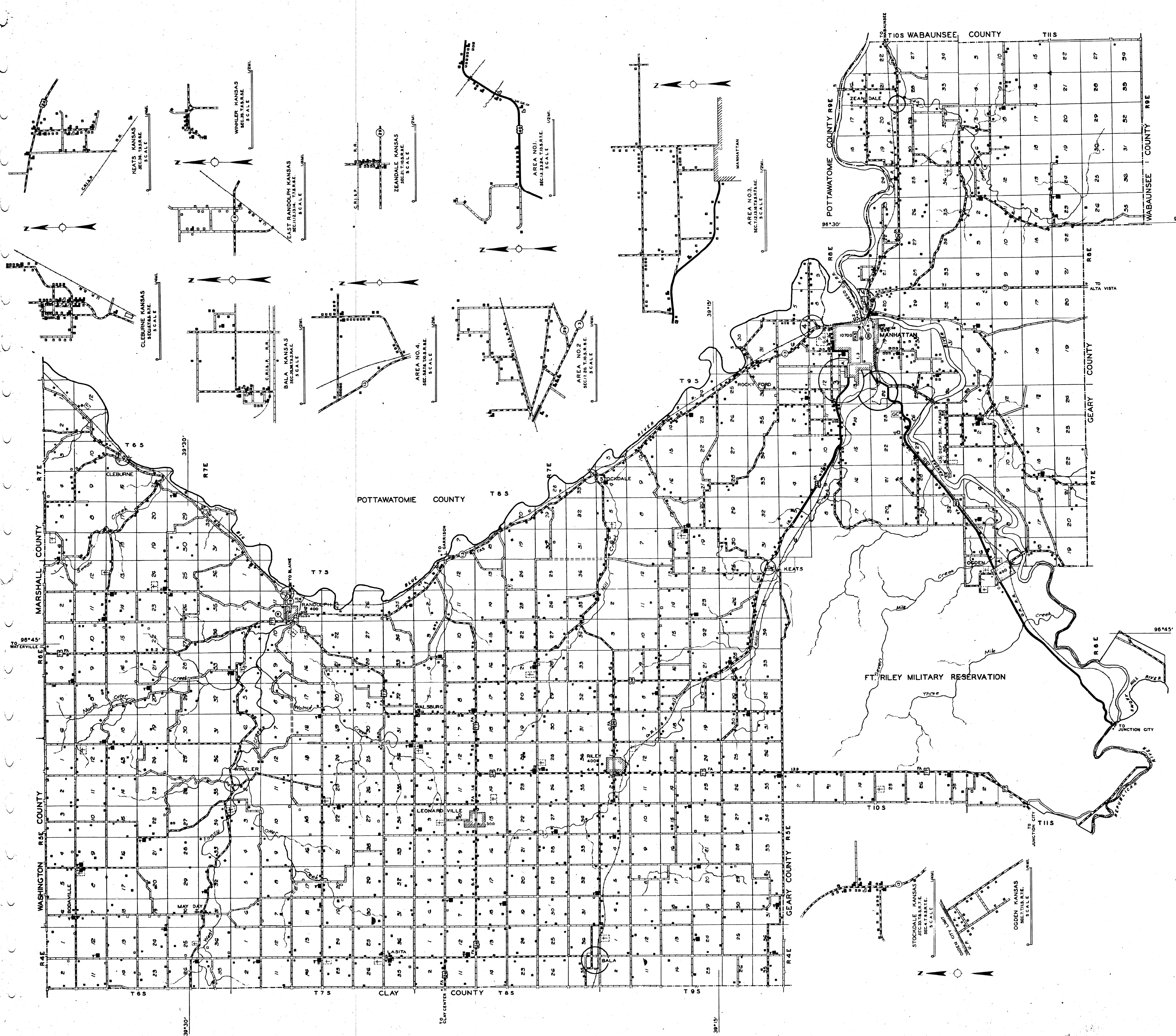

HIGHWAY & TRANSPORTATION MAP RILEY COUNTY KANSAS

PREPARED BY THE
KANSAS STATE HIGHWAY DEPARTMENT
IN COOPERATION WITH THE
FEDERAL WORKS AGENCY
PUBLIC ROADS ADMINISTRATION
DATA OBTAINED FROM
STATE-WIDE HIGHWAY PLANNING SURVEY

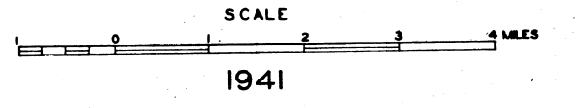

1941

