

LEGEND

ROADS AND ROADWAY FEATURES		CONSERVATION AND RECREATION																																																																																																																																																		
PRIMITIVE ROAD TYPE A1	UNIMPROVED ROAD TYPE B1	GRADED AND DRAINED ROAD TYPE C1	SOIL SURFACED ROAD TYPE D1	GRAVEL OR STONE ROAD TYPE E1	GRAVEL OR STONE ROAD TYPE E2	GRAVEL OR STONE ROAD WITH STABILIZED SURFACE TYPE F1	BITUMINOUS ROAD-LOW TYPE TYPE G1	PAVED ROAD TYPE H1	DIVIDED HIGHWAY TYPE I1	HIGHWAY WITH FULL CONTROL OF ACCESS TYPE J1	SIDE ROADS AND STREETS IN UNINCORPORATED URBAN COMPACTS AND EXTENSIONS OF LOCAL ROADS WITHIN MUNICIPALITIES TYPE K1	UNDIVIDED HIGHWAY TYPE L1	PRIVATE ROAD TYPE M1	PROJECTED ROAD TYPE N1	PLAYGROUND BALL FIELD, ETC.	BATHING BEACH OR SWIMMING POOL	SCENIC SITE	CAMP SITE, NO PERMANENCE OTHER OR TRAILER PARKING	TOURIST COURT OR MOTEL	CAMP OR LODGE PERMANENT SITE WITH BUILDINGS	SMALL PARK	FISH HATCHERY	GAME FARM	GAME PRESERVE	RIFLE CLUB	GOLF GROUND OR COUNTRY CLUB	POLO GROUNDS	RIDING ACADEMY	YACHT CLUB	AMUSEMENT PARK OR HALL	FAIR GROUND, RACE COURSE, SPEEDWAY	DRIVEN THEATRE																																																																																																																				
FEDERAL-AID INTERSTATE HIGHWAY SYSTEM	FEDERAL-AID PRIMARY HIGHWAY SYSTEM	FEDERAL-AID SECONDARY HIGHWAY SYSTEM	POINTS BETWEEN WHICH DISTANCES ARE MEASURED INDICATED THUS	INTERSTATE NUMBERED HIGHWAY	U.S. NUMBERED HIGHWAY	STATE HIGHWAY SYSTEM OR STATE NUMBERED HIGHWAY	END OF DESIGNATED SYSTEM OR MARKED ROUTE	RAILROADS	RAILROADS IN JUNCTURE POSITION	NARROW GAUGE RAILROAD	ELECTRIC INTERURBAN OR SUBURBAN RAILROAD	ABANDONED RAILROAD TRACKS REMAINING	ABANDONED ELECTRIC LINE (TRACK REMAINING)	RAILROAD STATION	RAILROAD CROSSINGS	GRADE CROSSING	RAILROAD ABOVE	RAILROAD BELOW	RAILROAD BRIDGE	AIRWAYS AND AIRPORTS	AIR ROUTE	MILITARY FIELD	AIRPORT, COMPLETE FACILITIES (COMMERCIAL OR MUNICIPAL)	AIRFIELD, LIMITED FACILITIES	LANDING AREA OR STRIP, INCLUDING PRIVATE AIR FIELDS	AIRWAY LIGHT BEACON, GENERAL	AIRPORT, GENERAL	NAVIGATION	NAVIGABLE STREAM	INTERMITTENT STREAM	NARROW STREAM	WIDE STREAM	GRASSY DITCH	IRRIGATION DITCH	LAKE, RESERVOIR, OR POND	LAKE, RESERVOIR, OR POND WITH DAM	DAY LAKE SUBJECT TO FLOOD	MARSH OR SWAMP LAND	OVERFLOW LAND	STRUCTURES	HIGHWAY BRIDGES	ARCH	GENERAL	CANTILEVER BRIDGE	COVERED BRIDGE	HIGHWAY GRADE SEPARATION	MISCELLANEOUS STRUCTURES	DAM WITH ROAD	LEVEE OR DIKE	CONCRETE FORD OR DIP	FORD-ROAD ESTABLISHED	CATTLE GUARD	GATE ACROSS ROAD	BOUNDARIES	STATE	COUNTY	CORPORATE LINES	BOUNDARY LINES ESTABLISHED FOR DELIMITED URBAN PLACES	SECTION LINE	MATCH LINE BETWEEN ADJOINING SHEETS OF SAME COUNTY	BOUNDARY TO MARK ENLARGEMENT INSET	PARKS AND OTHER RESERVATIONS NATIONAL	STATE, COUNTY, OR MUNICIPAL PARK	INDIAN RESERVATION, NATIONAL MONUMENT, FEDERAL DEVELOPMENT PROJECT	MONUMENT-SMALL HISTORIC SITE	CITY AND VILLAGE CENTERS	STATE CAPITAL	COUNTY SEAT	OTHER CITIES AND VILLAGES	INCORPORATED CITY OR VILLAGE	BOUNDARY LIMITS FIXED FOR SPECIAL TAXING AREAS AND OTHER UNINCORPORATED URBAN PLACES DELIMITED	FARM UNITS, DWELLINGS, ETC.	FARM UNIT	DWELLING (OTHER THAN FARM)	ROWS OR GROUPS OF DWELLINGS CLOSELY SPACED	COMBINED DWELLING AND STORE	DWELLING AND POST OFFICE	DWELLING AND FILLING STATION	DWELLING, BUSINESS, AND FILLING STATION	TENANT HOUSE	SEASONAL OR SUMMER COLONY DWELLING	HOTEL INN	CHURCH OR OTHER RELIGIOUS INSTITUTION	CHURCH AND SCHOOL	CEMETERY	CHURCH WITH CEMETERY ADJACENT	FRESH AIR FARM OR REST HOME	HOSPITAL	WELL	STATE PORT OF ENTRY OR WEIGHT STATION	GROUP OF MIXED CULTURAL FEATURES CLOSELY SPACED	INDUSTRIAL	STORE OR SMALL BUSINESS ESTABLISHMENT	BUSINESS AND POST OFFICE	BUSINESS AND FILLING STATION	BUSINESS, FILLING STATION, AND POST OFFICE	FACTORY OR INDUSTRIAL PLANT	MINE-SHAFT OR DRIFT (ANY KIND)	OIL OR GAS WELL	OIL OR GAS FIELD	OIL TANK	GAS TANK	GROUP OF STORAGE TANKS (OIL OR GAS)	FILLING STATION (NOT CONNECTED WITH OTHER BUSINESS)	PUMPING STATION (ON OR NEAR ROAD)	GAUGING OR PUMPING STATION (GENERAL)	VALVE HOUSE	SEASONAL INDUSTRY (CANNERY OR SMALL GRAIN MILL)	MILK DEPOT, CREAMERY, OR CHEESE FACTORY	FRUIT OR NUT ORCHARD	FRUIT OR PRODUCE PACKING HOUSE	ROAD STAN AND FARM PRODUCTS SALES	WAREHOUSE-GENERAL (UP GOVERNMENT AND STAIR OR UP)	GRAIN ELEVATOR	GROUP OF GRAIN STORAGE BINS	NURSERY	STOCK YARD-LOADING PEN OR CORRAL	STOCK PEN AT RAILROAD SIDING (SMALL)	GRAVEL PIT	QUARRY	KILN OR OVEN (LIME, CLAY PRODUCTS, COKE, ETC.)	EDUCATIONAL AND CORRECTIONAL INSTITUTIONS	SCHOOLHOUSE	CONSOLIDATED OR LARGE SCHOOL	TOWNHALL, GRANGE, OR COMMUNITY HALL	AGRICULTURAL EXPERIMENT STATION	COUNTY FARM	CORRECTIONAL INSTITUTION	PUBLIC SERVICE FACILITIES	POST OFFICE	HIGHWAY GARAGE	FIRE ENGINE HOUSE	GARAGE OR RUBBISH DUMP	SEWAGE DISPOSAL PLANT	AUTO SALVAGE YARD	TRANSFORMER STATION	POWER SUBSTATION	BOOSTER STATION	WATER SUPPLY STAND PIPE, OR TANK	RADIO STATION (WITH CALL LETTERS)	RADIO RANGE STATION	MISCELLANEOUS	FORT, ARMY CAMP, BARRACKS, OR OTHER MILITARY POST	TRIANGULATION STATION	BENCH MARK, WITH ELEVATION	NATURAL FEATURES	PROMINENT ELEVATION WITH NAME	SINK OR DEPRESSION

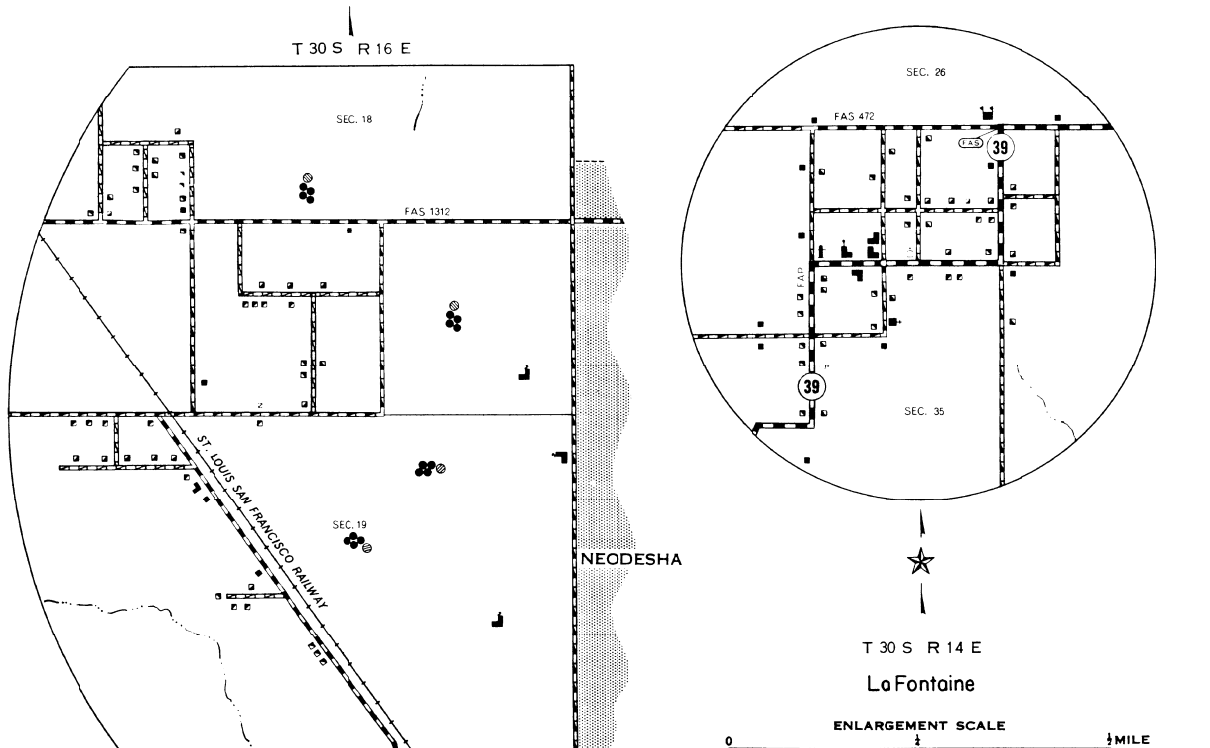
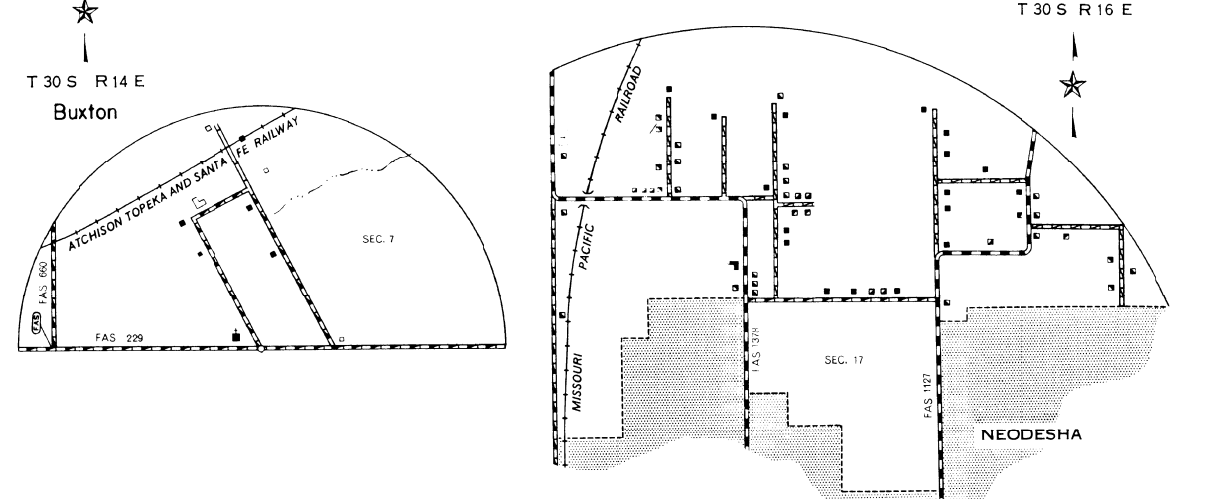
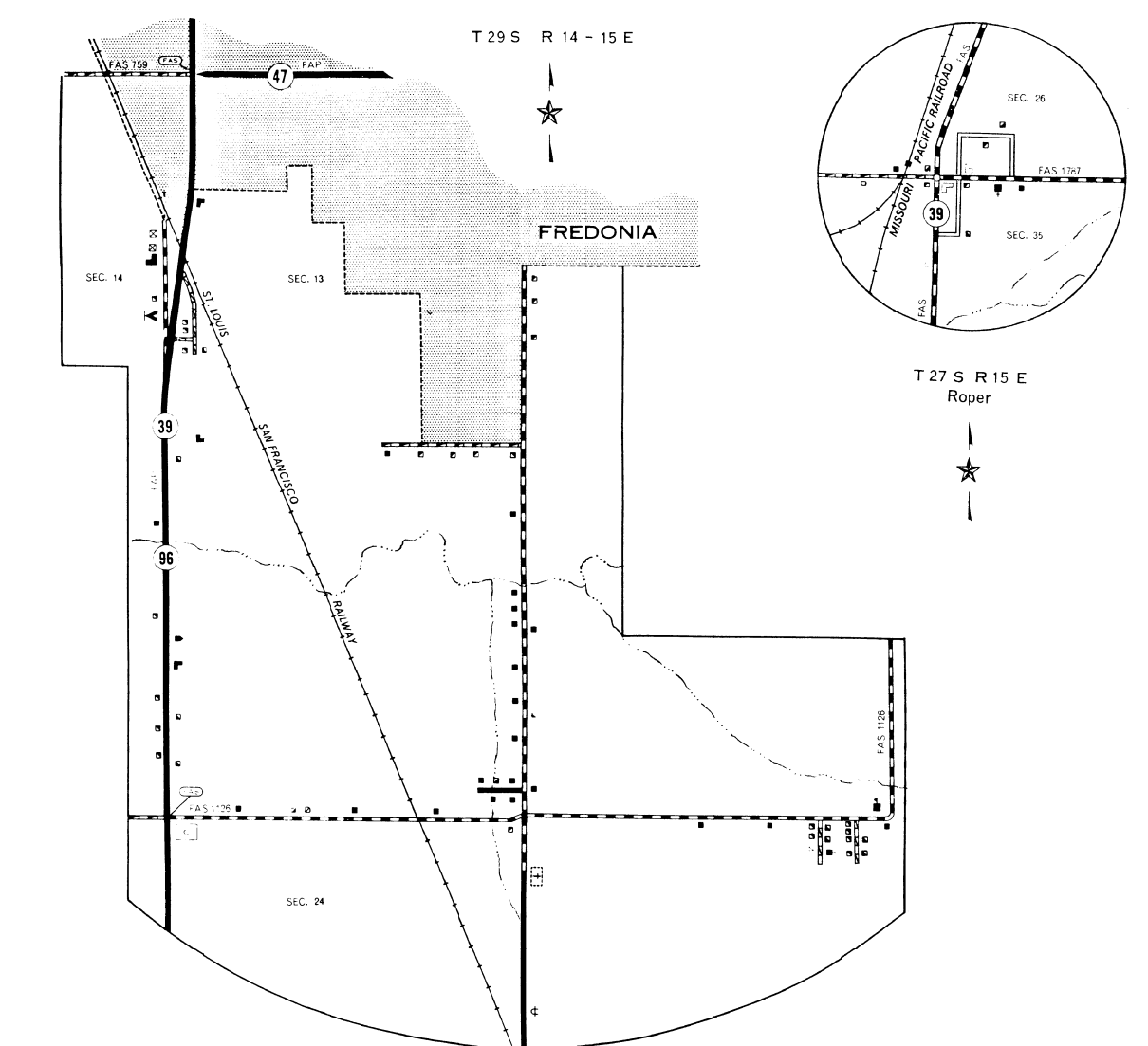
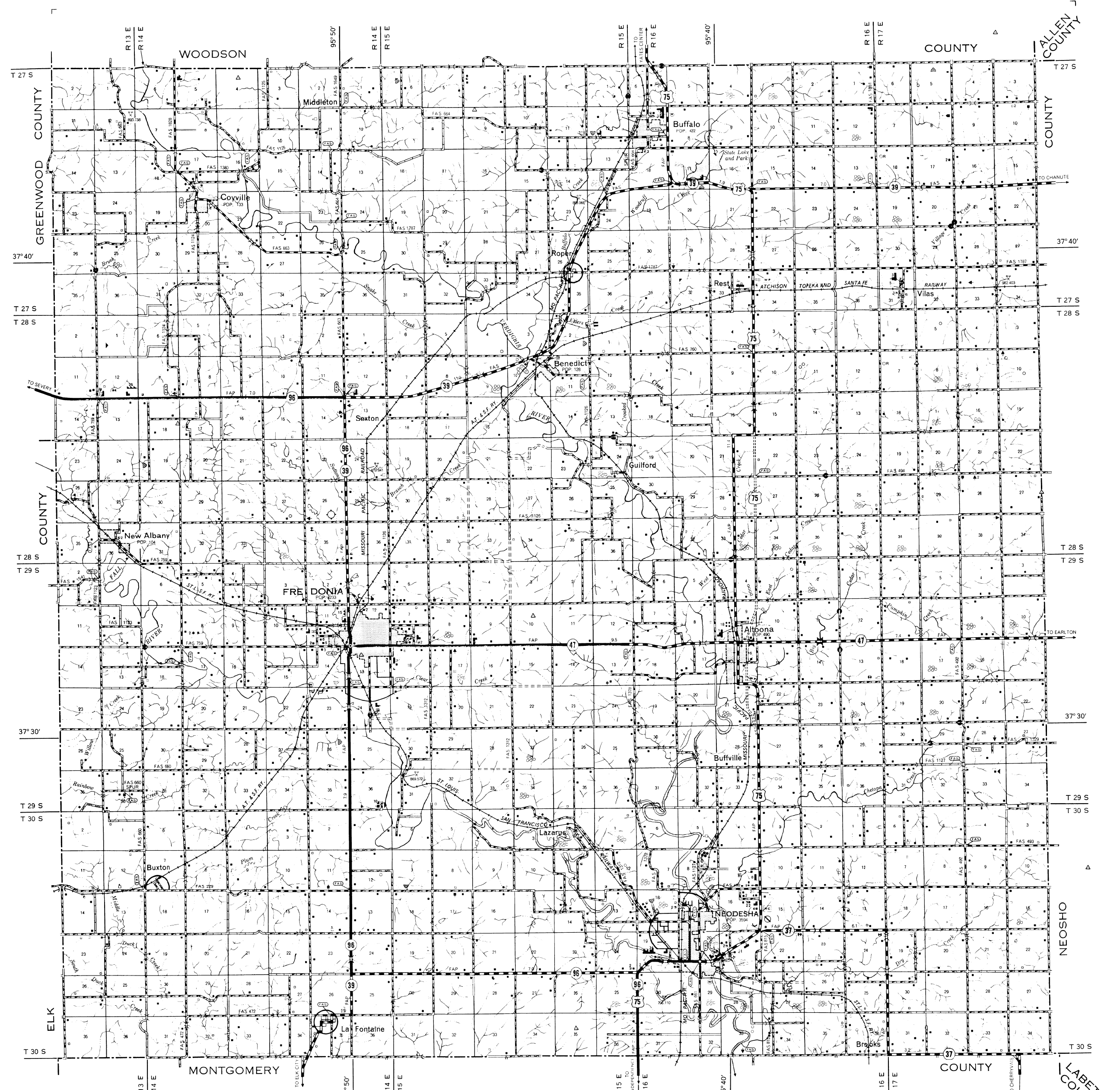

# GENERAL HIGHWAY MAP WILSON COUNTY KANSAS

PREPARED BY THE  
STATE HIGHWAY COMMISSION OF KANSAS  
PLANNING AND RESEARCH DEPARTMENT  
IN COOPERATION WITH THE  
U. S. DEPARTMENT OF COMMERCE  
BUREAU OF PUBLIC ROADS

SCALE  
0 1 2 3 4 MILES

1965  
POLYCONIC PROJECTION

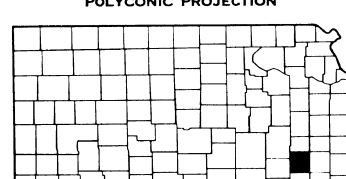

REVISIONS COMPLETED BY: [unclear]  
F. A. AND STATE SYSTEMS REVISED TO: [unclear]